



**Arizona Department of Agriculture
Office of Pest Management
WOOD DESTROYING INSECT INSPECTION REPORT**

1688 W. Adams, Phoenix AZ 85207
(602) 255-3664 www.sb.state.az.us

1A. VA/HUD/FHA CASE #	DATE OF INSPECTION 03/15/2019
1B. <input checked="" type="checkbox"/> ORIGINAL REPORT <input type="checkbox"/> SUPPLEMENTAL REPORT	1D. WDIIR #
1C. <input checked="" type="checkbox"/> SALE <input type="checkbox"/> REFINANCE <input type="checkbox"/> OTHER	1E. TARF #

NOTE: Pursuant to: ARS § 32-2333 (A) This form must be completed only by a Certified Applicator.

2. READ CAREFULLY PRIOR TO COMPLETING THIS OFFICE OF PEST MANAGEMENT (OPM) FORM

- The VA or HUD/FHA case number shall be inserted in Item 1A by the lender or by the pest control company.
- Areas that were inaccessible or obstructed (Item 7) may include, but are not limited to, wall coverings, fixed ceilings, floor coverings, furniture, or stored articles. In Item 7, the Inspector shall list those obstructions or areas which inhibited the inspection.
- Item 8A alone is checked when evidence/insects are found but no control measures are performed. Items 8A and 8C are checked when evidence/insects are found AND control measures are performed.
- When visible evidence is observed, wood-destroying insects causing such evidence shall be listed in Item 8A and the visible damage resulting from such infestation shall be noted in Item 8D.
- When treatment is indicated in Item 8C, the insects treated shall be named and the date of treatment indicated. The application method and chemicals used shall be entered in Item 10. Proper control measures may include issuance of a warranty. Warranty information shall also be entered in Item 10. (*Proper control measures are those which are allowed by OPM Statute/Rule, or the label for the chemical used.*)
- Visible evidence of conditions conducive to infestation from wood-destroying insects shall be reported in Items 15-18 on the second page of this form, (e.g., earth-wood contact, faulty grade, insufficient ventilation, etc.).
- All supplemental reports shall be completed within (30) days of the date of the original report.

3A. NAME OF INSPECTION COMPANY <i>Varsity Termite and Pest Control</i>		5A. NAME OF PROPERTY OWNER/SELLER
3B. ADDRESS OF INSPECTION COMPANY (Street, City, ZIP) <i>6056 E Baseline Rd. Ste 122 Mesa, AZ 85206</i>		5B. PROPERTY ADDRESS (Street, City, ZIP) <i>671 E Vermont Dr Gilbert, AZ 85295</i>
3C. TELEPHONE NUMBER (Include Area Code) <i>(602) 757-8252</i>	4. BUSINESS LICENSE # <i>8918</i>	6A. INSPECTED STRUCTURES <i>Single Family Residence</i>
6B. LIST ALL UN-INSPECTED STRUCTURES		

7. THIS INSPECTION DOES NOT INCLUDE THE FOLLOWING LISTED AREAS WHICH ARE OBSTRUCTED OR INACCESSIBLE. (See also Item 19, page 2.)

8. BASED ON THE INSPECTOR'S VISUAL INSPECTION OF THE READILY ACCESSIBLE AREAS OF THE PROPERTY (See Section (11) before completing):

- A. Visible evidence of wood-destroying insects was observed.
Describe evidence observed:
Type of Wood-Destroying Insects observed: _____
- B. No visible evidence of infestation from wood-destroying insects was observed.
- C. Visible evidence of infestation as noted in 8A. Proper control measures were performed on (date): _____
- D. Visible damage due to _____ was observed in the following areas: _____
- E. Visible evidence of previous treatment was observed. List evidence. (See also Item 20, page 2.): _____

9. DAMAGE OBSERVED, IF ANY

- A. Will be or has been corrected by this company.
- B. Will not be corrected by this company.
- C. It is recommended that noted damage be evaluated by a licensed structural contractor for any necessary repairs to be made.

10. ADDITIONAL COMMENTS (ALSO SEE PAGE 2.)

(Number of additional attachments to this report.) _____ Page(s)

11. STATEMENT OF INSPECTOR

- A. The inspection covered the readily accessible areas of the above listed structures, including attics and crawl spaces which permitted entry.
- B. Special attention was given to those areas which experience has shown to be particularly susceptible to attack by wood-destroying insects.
- C. Non-destructive probing and/or sounding of those areas and other visible accessible wood members showing evidence of infestation was performed.
- D. The inspection did not include areas which were obstructed or inaccessible at the time of inspection.
- E. Neither I, nor the company for which I am acting, have had, presently have, or contemplate having any interest in this property.
I do further state that neither I, nor the company for which I am acting, is associated in any way with any party to this transaction.

12A. SIGNATURE OF INSPECTOR 	12B. INSPECTOR'S LICENSE NUMBER <i>131047</i>	12C. DATE <i>03/15/2019</i>
---------------------------------	--	--------------------------------

STATEMENT OF PURCHASER

I HAVE RECEIVED THE ORIGINAL, OR A LEGIBLE COPY, OF THIS FORM AND HAVE READ PAGE (1, 2, & 3) OF THIS FORM.
I UNDERSTAND THAT THIS IS NOT A STRUCTURAL DAMAGE, FUNGI/MOLD REPORT, OR A WARRANTY AS TO THE ABSENCE OF WOOD-DESTROYING INSECTS AND I CAN CONSIDER ASSESSMENT BY A LICENSED STRUCTURAL CONTRACTOR OR FUNGI/MOLD INSPECTOR FOR ANY STRUCTURAL DAMAGE OR FUNGI/MOLD CONCERN.

13. SIGNATURE OF PURCHASER	14. DATE
----------------------------	----------

PROPERTY NAME/ADDRESS <p style="text-align: center;">671 E Vermont Dr Gilbert, AZ 85295</p>	DATE OF INSPECTION <p style="text-align: center;">03/15/2019</p>
--	---

AT THE TIME OF THE INSPECTION THE PROPERTY WAS: Vacant Occupied Unfurnished Furnished

CONDITIONS CONDUCTIVE TO INFESTATION

15. **WOOD TO EARTH CONTACT (EC)** YES NO *(If YES, check mark and explain conditions conducive)*

<input type="checkbox"/> Fence Abutting Structure	<input type="checkbox"/> Pier Posts	<input checked="" type="checkbox"/> Plants/Trees Contacting Structure
<input type="checkbox"/> Concrete Form Boards	<input type="checkbox"/> Porch Stairs	<input type="checkbox"/> Other _____
<input type="checkbox"/> Porch Post	<input type="checkbox"/> Trellis	

Comments:

16. **EXCESSIVE CELLULOSE DEBRIS (CD)** YES NO *(If YES, check mark and explain conditions conducive)*

Comments:

17. **FAULTY GRADES (FG)** YES NO *(If YES, check mark and explain conditions conducive)*

<input type="checkbox"/> Evidence of surface water draining toward house	<input type="checkbox"/> Stucco at or below grade
<input type="checkbox"/> Floor level or planters at or below grade	<input type="checkbox"/> Joists in crawl space less than 18" above grade
<input type="checkbox"/> Wood siding below grade	<input type="checkbox"/> Other _____

Comments:

18. **EXCESSIVE MOISTURE (EM)** YES NO *(If YES, check mark and explain conditions conducive)*

<input type="checkbox"/> Standing Water	<input type="checkbox"/> Water Damage	<input type="checkbox"/> Bath/Shower/Toilet Leaking	<input type="checkbox"/> Inadequate Ventilation
<input type="checkbox"/> Sprinklers Hitting Structure	<input checked="" type="checkbox"/> Water Stain	<input type="checkbox"/> Plumbing Leaks	<input type="checkbox"/> Other _____
<input type="checkbox"/> Crawl Space/Water Leaking	<input type="checkbox"/> Improper Condensate Drainage	<input type="checkbox"/> Attic/Roof Leak	

Comments:

19. **INACCESSIBLE AREAS (IA)** YES NO *(If YES, check mark and explain)*

<input type="checkbox"/> Attic – All	<input checked="" type="checkbox"/> Floors	<input type="checkbox"/> Sub/Crawl Space Area -- Clearance
<input checked="" type="checkbox"/> Attic – Joists	<input checked="" type="checkbox"/> Wall Interiors	<input type="checkbox"/> Sub Area/Crawl Space No Access
<input checked="" type="checkbox"/> Attic – Partial	<input type="checkbox"/> Enclosed Stairwell	<input checked="" type="checkbox"/> Areas Obstructed By Furniture Or Stored Articles
<input checked="" type="checkbox"/> Plumbing Traps	<input checked="" type="checkbox"/> Dropped Ceilings	<input checked="" type="checkbox"/> Other <u>See Comments</u>

Comments: *Under and behind cabinets, appliances, rooms, closets and along garage walls*

20. **EVIDENCE OF PREVIOUS TREATMENT**

BY ANOTHER COMPANY: While evidence of previous treatment does exist, it is impossible for the inspecting company to ascertain if such treatment was properly performed. Further investigation is left to the Buyer's discretion to determine if such treatment was done properly and if a valid warranty exists against the target pest of such treatment.

BY THE INSPECTING COMPANY: Previous treatment is recorded for this property. At the Buyer's discretion, treatment records can be viewed at the inspecting company's local office with the property owner's permission.

Account Number: _____ Date of Initial Treatment: _____ Target Pest: _____

Warranty Expiration Date: _____ Other: _____

Pest Control Inspector's Additional Comments

(Note: Graph Not To Scale)

PROPERTY NAME/ADDRESS

671 E Vermont Dr Gilbert, AZ 85295

DATE OF INSPECTION

03/15/2019

GRAPH OF STRUCTURE(S)

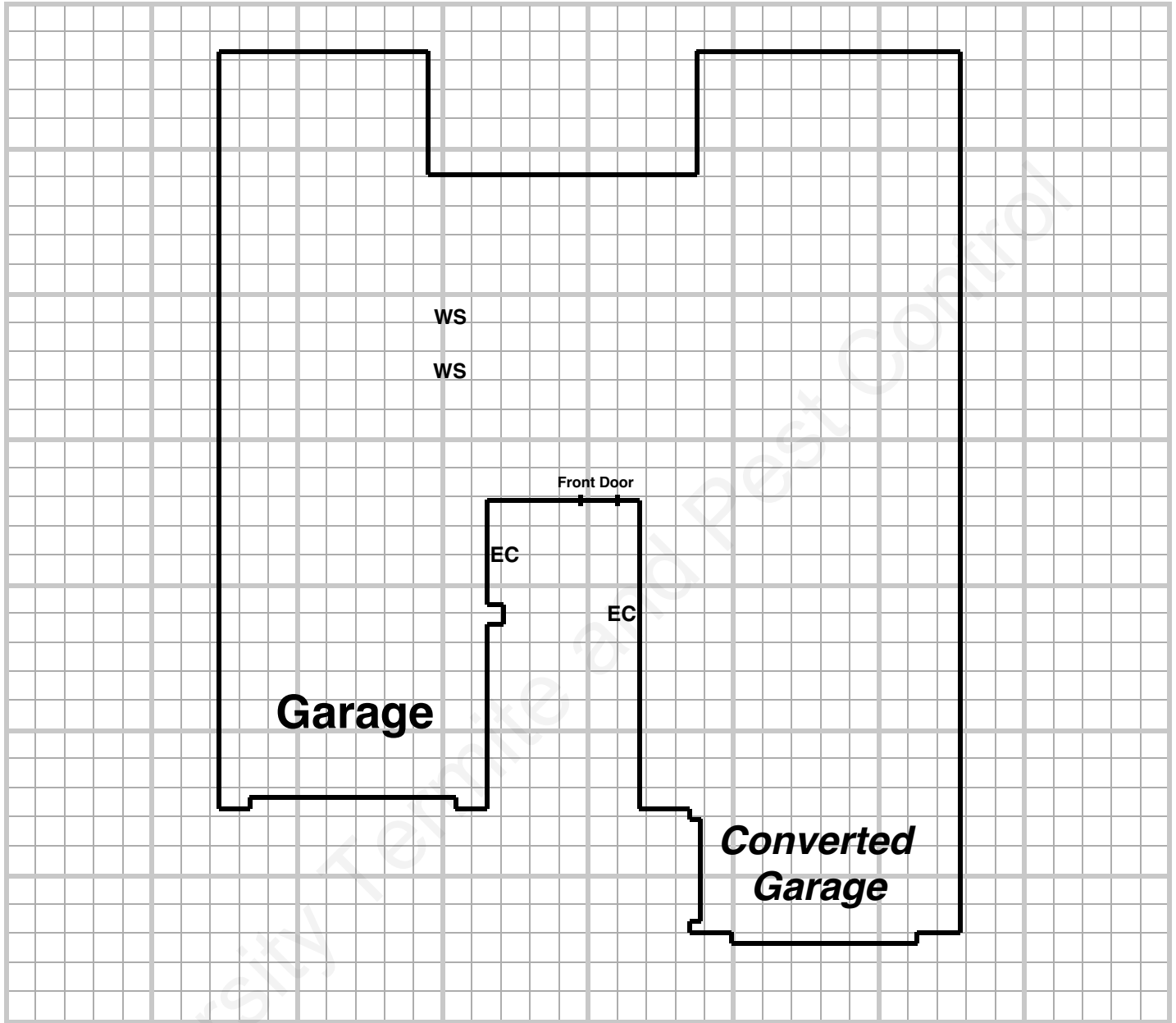

PURSUANT TO: R4-29-501 (E)(5)(6) THE INSPECTOR MUST COMPLETE THE GRAPH ON PAGE (3) AND CHECK (✓) MARKED BELOW FOR ANY ITEMS WHICH ARE NOTED ON PAGES (1) AND (2)

✓	CODE	SEE GRAPH PAGE (3)	✓	CODE	SEE GRAPH PAGE (3)	✓	CODE	SEE GRAPH PAGE (3)	✓	CODE	SEE GRAPH PAGE (3)
	SU Subterranean Termites			OW Other Wood Destroying Insects (*)			OB Obstructions			WD Water Damage	
	DR Drywood Termites			FG Faulty Grade		✓	IA Inaccessible Areas			WS Water Stains	
	DA Dampwood Termites		✓	EC Wood To Earth Contact			IV Inadequate Ventilation			RL Roof Leaks	
	BE Wood Destroying Beetles			CD Cellulose Debris			PL Plumbing Leaks		✓	EM Excessive Moisture	
	CA Carpenter Ants			PA Plantings Abutting Structure			SP Sprinkler Hitting Structure			FI Further Inspection Needed	

(*) Other Wood Destroying Insects