



**TENNESSEE DEPARTMENT OF ENVIRONMENT AND CONSERVATION  
DIVISION OF WATER RESOURCES  
CERTIFICATE OF COMPLETION OF A SUBSURFACE SEWAGE DISPOSAL SYSTEM**

**Issued to:** Leroy Shirk

**Location:**

County: Perry

Address: 4811 Lick Creek Rd

City: Linden

Subdivision: \_\_\_\_\_

Lot #: \_\_\_\_\_

Map: \_\_\_\_\_ Group: \_\_\_\_\_ Parcel: \_\_\_\_\_

Installed by: J&J Septic

Installer email: \_\_\_\_\_

Number of Bedrooms: 3

Gallons per Day: \_\_\_\_\_

Estimated Soil Absorption Rate: 45 MPI

- New Installation
- Repair Existing System
- System Modification
- Large System

**Type of System:**

- Conventional
- Modified Conventional
- Conventional System Substitute
  - Chamber
  - Poly Expanded Styrene
  - Large Diameter Gravelless Pipe
- \_\_\_\_\_ Gravel backfill in a 24 in. trench required?
- Low Pressure Pipe
- Mound
- Lagoon
- Subsurface Drip Disposal
- Other \_\_\_\_\_

Product: Infiltrator - Arc 36: 34.5" wide x 13" high

Septic Tank Manufacture: TCC

Volume (gal): 1,000

Effluent Pump? No

Effluent Pump Manufacture: \_\_\_\_\_

Effluent Pump Tank Volume: \_\_\_\_\_ gallons

Was the electric inspected? \_\_\_\_\_

Electric Inspection Ticket #: \_\_\_\_\_

Electric Inspection Date: \_\_\_\_\_

**Comments:**

This system is approved using a 30% reduction in field line as per regulation.

**Please see attached site drawing and any other supporting documentation.**

Inspected by: Jacob Davis  
DWR Staff

12/17/2025  
Date

Tennessee Department of Environment and Conservation - Division of Water Resources  
**Certificate of Completion of a Subsurface Sewage Disposal System**



Issued To: Leroy Shirk  
 Location: 4811 Lick Creek Rd  
Linden, Tn 37096  
 Inspector: Jacob Davis ES2  
 Date: 12/17/25

**General Notes:**  
 - Please refer to the subsurface sewage disposal system details on the first page of the Certificate of Completion.  
 - Questions regarding the Certificate of Completion should be directed to the local Division of Water Resources representative.

**The Subsurface Sewage Disposal System is Approved For:**  
 Residential: # of Bedrooms: 3  
 Other: \_\_\_\_\_  
 Gals/Day: \_\_\_\_\_ **Public Water**

Septic Tank GPS Coord.: 35.672°N 87.914°W

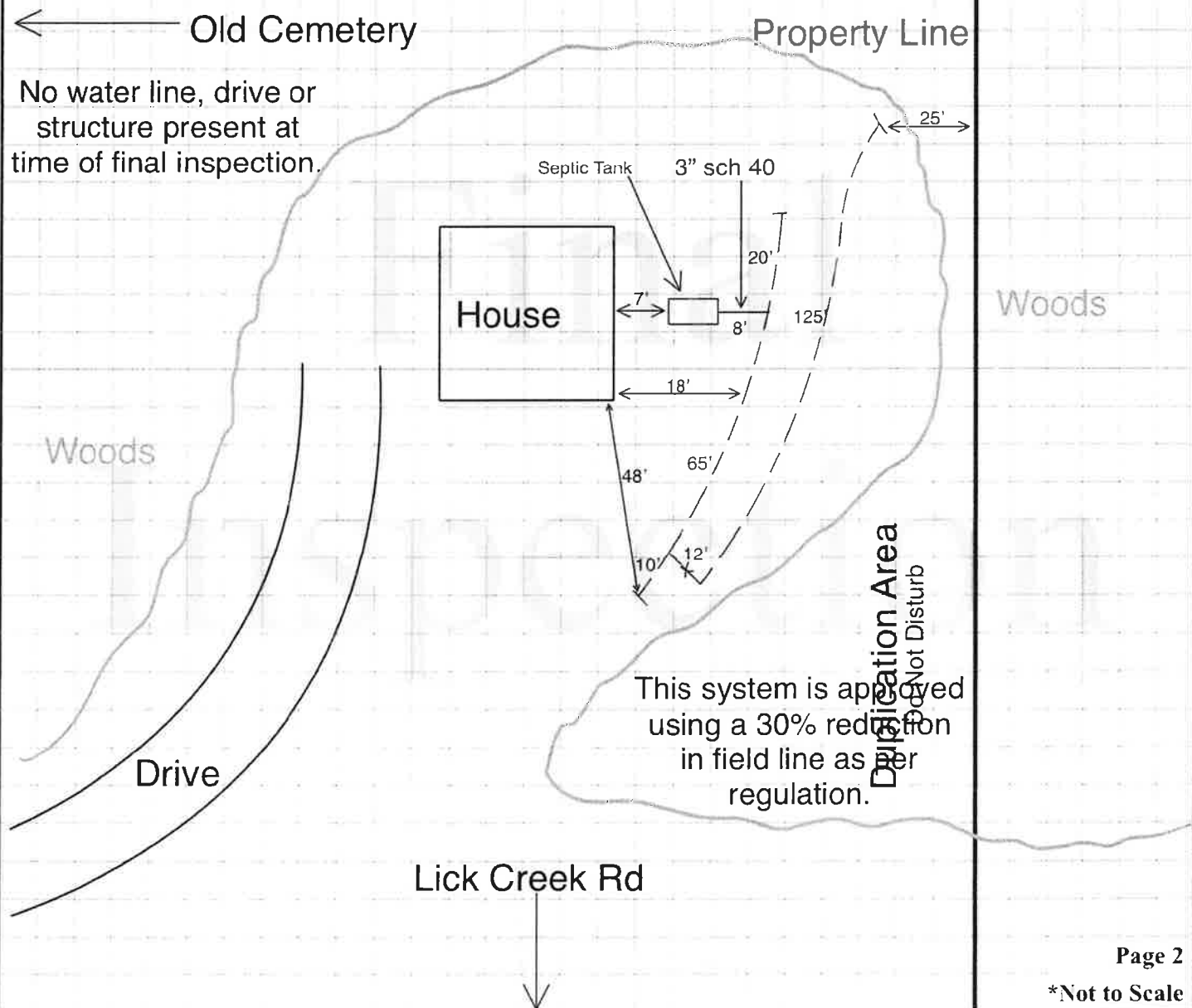



TENNESSEE DEPARTMENT OF ENVIRONMENT AND CONSERVATION  
DIVISION OF WATER RESOURCES

**PERMIT FOR CONSTRUCTION OF SUBSURFACE SEWAGE DISPOSAL SYSTEM**

Issued to: <u>Leroy Shirk</u>  <b>Location:</b> County: <u>Perry</u> Address: <u>4811 Lick Creek Road</u> City: <u>Linden</u> Subdivision: _____ Lot #: _____  Map: _____ Group: _____ Parcel: _____	<b>Evaluation Based Upon:</b> <input type="checkbox"/> 1. Soil Typing by Soil Scientist <input type="checkbox"/> a. General <input type="checkbox"/> b. High Intensity <input type="checkbox"/> c. Extra High Intensity <input type="checkbox"/> 2. Soil Percolation Test <input checked="" type="checkbox"/> 3. Environmental Scientist Estimated Absorption Rate: <u>45</u> MPI	<b>Type of System:</b> <input checked="" type="checkbox"/> 1. Conventional <input type="checkbox"/> 2. Modified Conventional <input checked="" type="checkbox"/> 3. Conventional System Substitute <input checked="" type="checkbox"/> Chamber <input checked="" type="checkbox"/> Expanded Polystyrene <input checked="" type="checkbox"/> Large Diameter Gravelless Pipe Gravel backfill in a 24 in. wide trench required? <u>No</u> <input type="checkbox"/> 4. Low Pressure Pipe <input type="checkbox"/> 5. Mound <input type="checkbox"/> 6. Lagoon <input type="checkbox"/> 7. Subsurface Drip System <input type="checkbox"/> 8. Other: _____
<b>Installation:</b> <input checked="" type="checkbox"/> 1. New Installation <input type="checkbox"/> 2. Repair to Existing System <input type="checkbox"/> 3. System Modification <input type="checkbox"/> 4. Large System	<b>Approval Based Upon: State No. T.C.A. 68-221-403</b> <input type="checkbox"/> (c) Percolation Test <input type="checkbox"/> (d) Grandfather Clause - Current standards except those specified <input type="checkbox"/> (f) 12" (karst) and 6" (non-karst) buffer required <input type="checkbox"/> (m) 3 <sup>rd</sup> Party Permit Package <input type="checkbox"/> (i) 9" Buffer required (24"-36" total soil depth) <input type="checkbox"/> (k) Grandfather Clause - Meets June 30, 1990, standards (repair only) <input checked="" type="checkbox"/> Current Standards <input type="checkbox"/> Other: _____	
<b>Establishment:</b> <input checked="" type="checkbox"/> 1. Residential: # Bedrooms <u>3</u> <input type="checkbox"/> 2. Other: _____ Gal/Day: _____	<b>Also Required:</b> <input type="checkbox"/> 1. Soil Improvement Practice (SIP) <input type="checkbox"/> Curtain Drain <input type="checkbox"/> Drawdown Drain <input type="checkbox"/> Interceptor Drain <input type="checkbox"/> 2. Flow Diversion Valve <input type="checkbox"/> 3. Sewage Pump Pump Flow Rate (gpm): _____ TDH (ft): _____ <input type="checkbox"/> 4. Single Compartment Pump Tank, Volume (gal): _____ <input type="checkbox"/> 5. Other: _____	
The system shall consist of a two-compartment septic tank holding <u>900</u> (min) gallons, with <u>300</u> linear feet in <u>3</u> trenches, <u>36</u> inches wide and <u>24</u> (min) to <u>30</u> (max) inches in depth. (Depth of gravel: <u>12</u> inches)  <b>SIP Depth (in):</b> _____ <b>SIP Length (ft):</b> _____ <b>SIP Comments:</b> <b>General Comments:</b> Stay 50' from any water source and 10' from any water line or property line. Shoot grade and adjust lines accordingly.		

All installers of subsurface sewage disposal systems must hold a valid annual license from the Tennessee Department of Environment and Conservation.

**Please see attached drawing and supporting documentation.**

The recipient of this permit agrees to construct or have constructed the above-described system in accordance with T.C.A. 68-221-401 et. seq. and The Regulations To Govern Subsurface Sewage Disposal Systems. If any part of the system is covered before inspected and approved, it shall be uncovered by the recipient of the permit at the direction of personnel of the Department of Environment and Conservation. **Any cutting, filling or alterations of the soil conditions on the aforementioned property after this day may render this approval null and void.**

**By:** Jacob Davis  
(DWR Staff)

**Date:** 11/19/2025  
(Date of Issue)

**This permit is valid for 3 years from date of issue.**

This is a permit to construct and is not intended to imply approval of any work proposed or completed on this lot.

Tennessee Department of Environment and Conservation - Division of Water Resources  
 Permit for Construction of a Subsurface Sewage Disposal System



Issued To: Leroy Shirk  
 Location: 4811 Lick Creek Rd  
Linden, Tn 37096

Inspector: Jacob Davis ES2  
 Date: 11/19/25

**General Notes:**

- Please refer to the design specifications for the subsurface sewage disposal system on the first page of the construction permit.
- Contact the local Division of Water Resources representative to schedule a final inspection.
- All electric components (e.g., pump, alarm, etc.) for the subsurface sewage disposal system must be inspected and approved by the appropriate electrical inspector prior to requesting a final inspection. Documentation of the electrical inspection must be available during the final inspection.

Public Water

