

Residential Property Record Card

Date Printed 04/15/26

Owner Information

Parcel WC00050025
 Owner BRESSETTE DAVID /
 5 WINTERS CT
 SWANTON, VT 05488
 Location 5 WINTERS CT
 Descr: H+L

Parcel Value Information

Land Value 36,200 Homestead 199,000
 Dwelling Value 150,400 Housesite 199,000
 Site Imprvmt 10,000
 Outbuildings 2,400
 Misc. Adj. 0
 Total 199,000

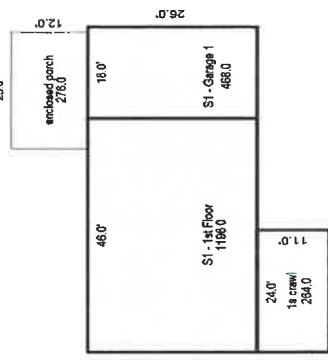

Sketch Updated: 02/28/07

Parcel Information

Tax Map # BK 71 PG 184 NBHD 1
 Span 639-201-12853 Acres 0.31
 Status A - Active Last Update 03/15/07

Sales Information

Book 274 Sale Date 03/08/10
 Page 271-272 Sale Price 0

BUILDING	Total Rooms	5	Year Built	1960	Building SF	1460	Energy Adj	Average	Roughins	1
	Bedrooms	3	Effect Age	47.0	Quality	3.00	Bsmt Wall	Blk 8"	Plumb Fixt	7
	Full Baths	1	Condition	Avg/Good	Style	1 Story	Bsmt SF	1196.00	Fireplaces	0
	Half Baths	1	Phys Depr	22	Design	One Story	Bsmt Fin	Rec	Porch	276
	Kitchens	1	Funct Depr	0	Bldg Type	Single	Bsmt Fin SF	300	Gar/Shed	468
			Econ Depr	0					% Complete:	0

INSPECT	INSP.	NoData	INSP.	NoData	INSP.	APPT	NoData	APPT	NoData	APPTSCHD
----------------	-------	--------	-------	--------	-------	------	--------	------	--------	----------

NOTES