

Soils Map

Boundary Lines Are Approximate

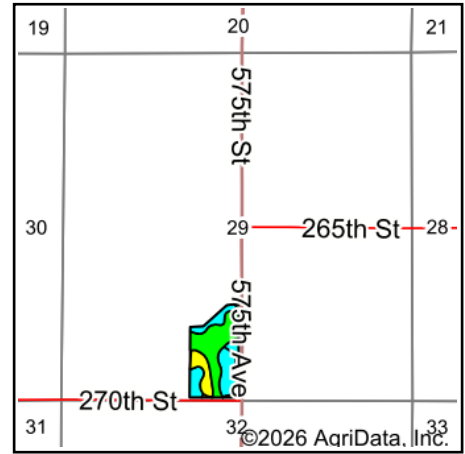

State: **Iowa**
 County: **Monroe**
 Location: **29-71N-18W**
 Township: **Franklin**
 Acres: **21**
 Date: **4/1/2026**

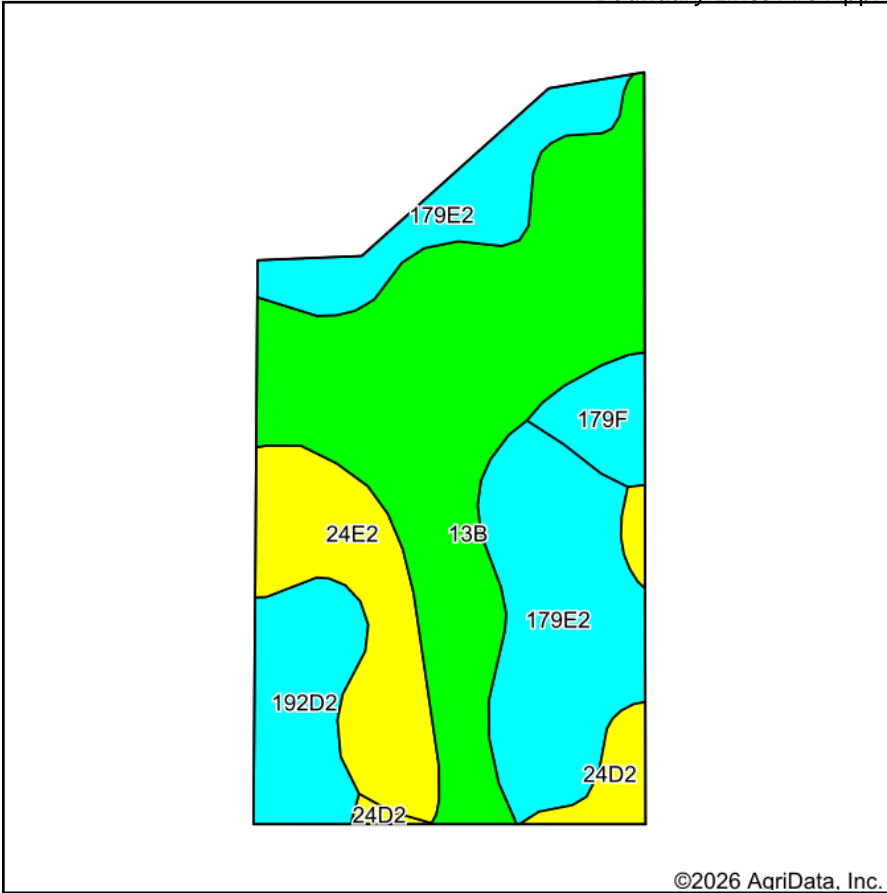

Soils data provided by USDA and NRCS.

©2026 AgriData, Inc.

Area Symbol: IA135, Soil Area Version: 33

Code	Soil Description	Acres	Percent of field	CSR2 Legend	Non-Irr Class *c	CSR2**	CSR	*n NCCPI Corn	*n NCCPI Soybeans	
13B	Olmitz-Colo-Vesser complex, 2 to 5 percent slopes	8.78	41.7%		Ilw	82	60	70	71	
179E2	Gara loam, 14 to 18 percent slopes, moderately eroded	5.85	27.9%		Vle	26	33	62	45	
24E2	Shelby clay loam, 14 to 18 percent slopes, moderately eroded	2.85	13.6%		IVe	40	38	66	49	
192D2	Adair clay loam, heavy till, 9 to 14 percent slopes, moderately eroded	1.93	9.2%		IVe	9	15	65	44	
179F	Gara loam, 18 to 25 percent slopes	0.81	3.9%		Vle	19	15	55	41	
24D2	Shelby clay loam, 9 to 14 percent slopes, moderately eroded	0.78	3.7%		Ille	48	48	70	53	
Weighted Average						3.76	50.3	43.2	*n 66.2	*n 56.5

**IA has updated the CSR values for each county to CSR2.

*n: The aggregation method is "Weighted Average using all components"

*c: Using Capabilities Class Dominant Condition Aggregation Method