

**DISCLOSURE STATEMENT: SELLER'S
PROPERTY DISCLOSURE STATEMENT**

This form is approved by the Minnesota Association of REALTORS®, which disclaims any liability arising out of use or misuse of this form.
© 2016-2025 Minnesota Association of REALTORS®

1. Date March 24 2026
 2. Page 1 of _____ pages: RECORDS AND
 3. REPORTS, IF ANY, ARE ATTACHED AND MADE A
 4. PART OF THIS DISCLOSURE.

5. THE INFORMATION DISCLOSED IS GIVEN TO THE BEST OF SELLER'S KNOWLEDGE.

6. **NOTICE:** This Disclosure Statement satisfies the disclosure requirements of MN Statutes 513.52 through 513.60.
 7. Under Minnesota law, sellers of residential property, with limited exceptions listed on page nine (9), are obligated to
 8. disclose to prospective buyers all material facts of which Seller is aware that could adversely and significantly affect
 9. an ordinary buyer's use or enjoyment of the property or any intended use of the property of which Seller is aware.
 10. MN Statute 513.58 requires Seller to notify buyer in writing as soon as reasonably possible, but in any event before
 11. closing, if Seller learns that Seller's disclosure was inaccurate. Seller is obligated to continue to notify Buyer, in writing,
 12. of any facts disclosed here (new or changed) of which Seller is aware that could adversely and significantly affect the
 13. Buyer's use or enjoyment of the property or any intended use of the property that occur up to the time of closing.
 14. Seller has disclosure alternatives allowed by MN Statutes. See *Disclosure Statement: Seller's Disclosure Alternatives*
 15. form for further information regarding disclosure alternatives. **This disclosure is not a warranty or a guarantee of any**
 16. **kind by Seller or licensee(s) representing or assisting any party in the transaction and is not a substitute for**
 17. **any inspections or warranties the party(ies) may wish to obtain.**

18. For purposes of the seller disclosure requirements of MN Statutes 513.52 through 513.60:
 19. "Residential real property" or "residential real estate" means property occupied as, or intended to be occupied as, a
 20. single-family residence, including a unit in a common interest community as defined in MN Statute 515B.1-103,
 21. clause (10), regardless of whether the unit is in a common interest community not subject to chapter 515B.
 22. The seller disclosure requirements of MN Statutes 513.52 through 513.60 apply to the transfer of any interest in
 23. residential real estate, whether by sale, exchange, deed, contract for deed, lease with an option to purchase, or any
 24. other option.

25. **INSTRUCTIONS TO BUYER:** Buyers are encouraged to thoroughly inspect the property personally or have it
 26. inspected by a third party, and to inquire about any specific areas of concern. **NOTE:** If Seller answers "NO" to any of
 27. the questions listed below, it does not necessarily mean that it does not exist on the property, did not occur, or does
 28. not apply. "NO" may mean that Seller is unaware.

29. **INSTRUCTIONS TO SELLER:** (1) Complete this form yourself. (2) Consult prior disclosure statement(s) and/or
 30. inspection report(s) when completing this form. (3) Describe conditions affecting the property to the best of your
 31. knowledge. (4) Attach additional pages, with your signature, if additional space is required. (5) Answer all questions.
 32. (6) If any items do not apply, write "NA" (not applicable).

33. Property located at 3710 60th Ave SW,
 34. City of Rochester, County of Olmsted,
 35. State of Minnesota, Zip Code 55902 ("Property").

36. A. GENERAL INFORMATION: The following questions are to be answered to the best of Seller's knowledge.

37. (1) What date did you Acquire Build the home? 07/21/2017
(Check one.)
 38. (2) Type of title evidence: Abstract Registered (Torrens) Unknown
 39. Location of Abstract: _____
 40. Is there an existing Owner's Title Insurance Policy? Yes No
 41. (3) Have you occupied this home continuously during your ownership? Yes No
 42. If "No," explain: _____
 43. (4) Is the home suitable for year-round use? Yes No
 44. (5) Are you in possession of prior seller's disclosure statement(s)? (If "Yes," please attach.) Yes No
 45. (6) Does the Property include a manufactured home? Yes No
 46. If "Yes," HUD #(s) is/are _____
 47. Has the title been surrendered to the Registrar of Motor Vehicles for cancellation? Yes No



DISCLOSURE STATEMENT: SELLER'S
PROPERTY DISCLOSURE STATEMENT

48. Page 2

49. THE INFORMATION DISCLOSED IS GIVEN TO THE BEST OF SELLER'S KNOWLEDGE.

50. Property located at 3710 60th Ave SW Rochester MN 55902
51. (7) Is the Property located on a public or a private road? Public Private Public: no maintenance
52. (8) Flood Insurance: All properties in the state of Minnesota have been assigned a flood zone designation. Some
53. flood zones may require flood insurance.
54. (a) Do you know which zone the Property is located in? Yes No
55. If "Yes," which zone? _____
56. (b) Have you ever had a flood insurance policy? Yes No
57. If "Yes," is the policy in force? Yes No
58. If "Yes," what is the annual premium? \$ _____
59. If "Yes," who is the insurance carrier? _____
60. (c) Have you ever had a claim with a flood insurance carrier or FEMA? Yes No
61. If "Yes," please explain: _____
62. _____

63. **NOTE:** Whether or not Seller currently carries flood insurance, it may be required in the future. Flood insurance

64. premiums are increasing, and in some cases will rise by a substantial amount over the premiums

65. previously charged for flood insurance for the Property. As a result, Buyer should not rely on the

66. premiums paid for flood insurance on this Property previously as an indication of the premiums that

67. will apply after Buyer completes their purchase.

68. Are there any
69. (9) homeowners associations or shared amenities? Yes No
70. (10) encroachments? Yes No
71. (11) covenants, historical registry, reservations, or restrictions, that affect
72. or may affect the use or future resale of the Property? Yes No
73. (12) governmental requirements or restrictions that affect or may affect the use or future
74. enjoyment of the Property (e.g., shoreland restrictions, non-conforming use, etc.)? Yes No
75. (13) easements, other than utility or drainage easements? Yes No
76. (14) Please provide clarification or further explanation for all applicable "Yes" responses in Section A:
77. _____
78. _____

79. **B. GENERAL CONDITION:** To your knowledge, have any of the following conditions previously existed or do they

80. currently exist on the Property?

81. (ANSWERS APPLY TO ALL STRUCTURES, SUCH AS GARAGE AND OUTBUILDINGS.)
82. (1) Has there been any damage by wind, fire, flood, hail, or other cause(s)? Yes No
83. If "Yes," give details of what happened and when: _____
84. _____
85. (2) Have you ever had an insurance claim(s) related to the Property? Yes No
86. If "Yes," what was the claim(s) for (e.g., hail damage to roof)? _____
87. _____
88. Did you receive compensation for the claim(s)? Yes No
89. Did you have the items repaired? Yes No
90. What dates did the claim(s) occur? _____



**DISCLOSURE STATEMENT: SELLER'S
PROPERTY DISCLOSURE STATEMENT**

91. Page 3

92. THE INFORMATION DISCLOSED IS GIVEN TO THE BEST OF SELLER'S KNOWLEDGE.

93. Property located at 3710 60th Ave SW Rochester MN 55902

94. (3) (a) Has/Have the structure(s) been altered?
95. (e.g., additions, altered roof lines, changes to load-bearing walls) Yes No
96. If "Yes," please specify what was done, when, and by whom (owner or contractor):

97. _____
98. _____

99. (b) Has any work been performed on the Property? (e.g., additions to the
100. Property, wiring, plumbing, retaining wall, general finishing) Yes No
101. If "Yes," please explain: _____

102. _____
103. (c) Are you aware of any work performed on the Property for which
104. appropriate permits were not obtained? Yes No
105. If "Yes," please explain: _____

106. _____
107. (4) Are you aware of any professional remediation efforts to eliminate odors? Yes No
108. If "Yes," give details as to what happened and when: _____

109. _____
110. (5) Has there been any damage to flooring or floor covering? Yes No
111. If "Yes," give details of what happened and when: _____

112. _____
113. (6) Do you have or have you previously had any pets? Yes No
114. If "Yes," indicate type Dogs and number 2

115. (7) **THE FOUNDATION:** The type of foundation is (i.e., block, poured, wood, stone, other):
116. Block

117. (8) **THE BASEMENT, CRAWLSPACE, SLAB:**
118. (a) cracked floor/walls? Yes No (e) leakage/seepage? Yes No
119. (b) drain tile problem? Yes No (f) sewer backup? Yes No
120. (c) flooding? Yes No (g) wet floors/walls? Yes No
121. (d) foundation problem? Yes No (h) other? _____ Yes No

122. Give details to any questions answered "Yes": _____
123. _____
124. _____

125. (9) **THE ROOF:**
126. (a) What is the age of the roofing material? New
127. Home: 4 years Garage(s)/Outbuilding(s): ? years
128. (b) Has there been any interior or exterior damage? Yes No
129. (c) Has there been interior damage from ice buildup? Yes No
130. (d) Has there been any leakage? Yes No
131. (e) Have there been any repairs or replacements made to the roof? Yes No



**DISCLOSURE STATEMENT: SELLER'S
PROPERTY DISCLOSURE STATEMENT**

132. Page 4

133. THE INFORMATION DISCLOSED IS GIVEN TO THE BEST OF SELLER'S KNOWLEDGE.

134. Property located at 3710 60th Ave SW Rochester MN 55902

135. Give details to any questions answered "Yes": _____

136. _____

137. **(10) THE EXTERIOR AND INTERIOR WALLS/SIDING/WINDOWS:**

138. (a) The type(s) of siding is (e.g., vinyl, stucco, brick, other): LP Smartside

139. (b) cracks/damage? Yes No

140. (c) leakage/seepage? Yes No

141. (d) other? Yes No

142. Give details to any questions answered "Yes": Home was completely re-sided by a licensed contractor.

144. **C. APPLIANCES, HEATING, PLUMBING, ELECTRICAL, AND OTHER MECHANICAL SYSTEMS:**

145. **NOTE:** Check "NA" if the item is not physically located on the Property. Check "Yes" for items in working condition. Check "No" for items not in working condition. Working order means all components of the items specified below.

		Working Order				Working Order		
	NA	Yes	No		NA	Yes	No	
151. Air-conditioning.....	<input type="checkbox"/>	<input checked="" type="checkbox"/>	<input type="checkbox"/>	Pool and equipment	<input checked="" type="checkbox"/>	<input type="checkbox"/>	<input type="checkbox"/>	
152. <input checked="" type="checkbox"/> Central <input type="checkbox"/> Wall <input type="checkbox"/> Window				Propane tank	<input checked="" type="checkbox"/>	<input type="checkbox"/>	<input type="checkbox"/>	
153. Air exchange system.....	<input checked="" type="checkbox"/>	<input type="checkbox"/>	<input type="checkbox"/>	<input type="checkbox"/> Rented <input type="checkbox"/> Owned				
154. Carbon monoxide detector	<input type="checkbox"/>	<input checked="" type="checkbox"/>	<input type="checkbox"/>	Range/oven.....	<input type="checkbox"/>	<input checked="" type="checkbox"/>	<input type="checkbox"/>	
155. Ceiling fan	<input type="checkbox"/>	<input checked="" type="checkbox"/>	<input type="checkbox"/>	Range hood	<input checked="" type="checkbox"/>	<input type="checkbox"/>	<input type="checkbox"/>	
156. Central vacuum.....	<input checked="" type="checkbox"/>	<input type="checkbox"/>	<input type="checkbox"/>	Refrigerator.....	<input type="checkbox"/>	<input checked="" type="checkbox"/>	<input type="checkbox"/>	
157. Clothes dryer.....	<input type="checkbox"/>	<input checked="" type="checkbox"/>	<input type="checkbox"/>	Security system	<input checked="" type="checkbox"/>	<input type="checkbox"/>	<input type="checkbox"/>	
158. Clothes washer	<input type="checkbox"/>	<input checked="" type="checkbox"/>	<input type="checkbox"/>	<input type="checkbox"/> Rented <input type="checkbox"/> Owned				
159. Dishwasher.....	<input type="checkbox"/>	<input checked="" type="checkbox"/>	<input type="checkbox"/>	Smoke detectors (battery)	<input type="checkbox"/>	<input checked="" type="checkbox"/>	<input type="checkbox"/>	
160. Doorbell.....	<input checked="" type="checkbox"/>	<input type="checkbox"/>	<input type="checkbox"/>	Smoke detectors (hardwired).....	<input checked="" type="checkbox"/>	<input type="checkbox"/>	<input type="checkbox"/>	
161. Drain tile system.....	<input checked="" type="checkbox"/>	<input type="checkbox"/>	<input type="checkbox"/>	Solar collectors	<input checked="" type="checkbox"/>	<input type="checkbox"/>	<input type="checkbox"/>	
162. Electrical system	<input type="checkbox"/>	<input checked="" type="checkbox"/>	<input type="checkbox"/>	Sump pump	<input checked="" type="checkbox"/>	<input type="checkbox"/>	<input type="checkbox"/>	
163. Environmental remediation system.....				Toilet mechanisms	<input type="checkbox"/>	<input checked="" type="checkbox"/>	<input type="checkbox"/>	
164. (e.g., radon, vapor intrusion)	<input checked="" type="checkbox"/>	<input type="checkbox"/>	<input type="checkbox"/>	Trash compactor.....	<input checked="" type="checkbox"/>	<input type="checkbox"/>	<input type="checkbox"/>	
165. Exhaust system.....	<input type="checkbox"/>	<input type="checkbox"/>	<input checked="" type="checkbox"/>	TV antenna system	<input checked="" type="checkbox"/>	<input type="checkbox"/>	<input type="checkbox"/>	
166. Fire sprinkler system	<input checked="" type="checkbox"/>	<input type="checkbox"/>	<input type="checkbox"/>	TV cable system	<input checked="" type="checkbox"/>	<input type="checkbox"/>	<input type="checkbox"/>	
167. Fireplace.....	<input type="checkbox"/>	<input checked="" type="checkbox"/>	<input type="checkbox"/>	TV receiver.....	<input checked="" type="checkbox"/>	<input type="checkbox"/>	<input type="checkbox"/>	
168. Fireplace mechanisms	<input type="checkbox"/>	<input checked="" type="checkbox"/>	<input type="checkbox"/>	TV satellite dish.....	<input checked="" type="checkbox"/>	<input type="checkbox"/>	<input type="checkbox"/>	
169. Freezer	<input type="checkbox"/>	<input checked="" type="checkbox"/>	<input type="checkbox"/>	<input type="checkbox"/> Rented <input type="checkbox"/> Owned				
170. Furnace humidifier	<input checked="" type="checkbox"/>	<input type="checkbox"/>	<input type="checkbox"/>	Water heater	<input type="checkbox"/>	<input checked="" type="checkbox"/>	<input type="checkbox"/>	
171. Garage door auto reverse	<input type="checkbox"/>	<input checked="" type="checkbox"/>	<input type="checkbox"/>	Water purification system	<input type="checkbox"/>	<input checked="" type="checkbox"/>	<input type="checkbox"/>	
172. Garage door opener.....	<input type="checkbox"/>	<input checked="" type="checkbox"/>	<input type="checkbox"/>	<input type="checkbox"/> Rented <input checked="" type="checkbox"/> Owned				
173. Garage door opener remote.....	<input type="checkbox"/>	<input checked="" type="checkbox"/>	<input type="checkbox"/>	Water softener	<input type="checkbox"/>	<input checked="" type="checkbox"/>	<input type="checkbox"/>	
174. Garbage disposal	<input checked="" type="checkbox"/>	<input type="checkbox"/>	<input type="checkbox"/>	<input type="checkbox"/> Rented <input checked="" type="checkbox"/> Owned				
175. Heating system (central).....	<input type="checkbox"/>	<input checked="" type="checkbox"/>	<input type="checkbox"/>	Water treatment system.....	<input type="checkbox"/>	<input checked="" type="checkbox"/>	<input type="checkbox"/>	
176. Heating system (supplemental).....	<input checked="" type="checkbox"/>	<input type="checkbox"/>	<input type="checkbox"/>	<input type="checkbox"/> Rented <input checked="" type="checkbox"/> Owned				
177. Incinerator	<input checked="" type="checkbox"/>	<input type="checkbox"/>	<input type="checkbox"/>	Windows	<input type="checkbox"/>	<input checked="" type="checkbox"/>	<input type="checkbox"/>	
178. Intercom	<input checked="" type="checkbox"/>	<input type="checkbox"/>	<input type="checkbox"/>	Window treatments.....	<input type="checkbox"/>	<input checked="" type="checkbox"/>	<input type="checkbox"/>	
179. In-ground pet containment system.....	<input checked="" type="checkbox"/>	<input type="checkbox"/>	<input type="checkbox"/>	Wood-burning stove	<input checked="" type="checkbox"/>	<input type="checkbox"/>	<input type="checkbox"/>	
180. Lawn sprinkler system	<input checked="" type="checkbox"/>	<input type="checkbox"/>	<input type="checkbox"/>	Other	<input type="checkbox"/>	<input type="checkbox"/>	<input type="checkbox"/>	
181. Microwave.....	<input type="checkbox"/>	<input checked="" type="checkbox"/>	<input type="checkbox"/>	Other	<input type="checkbox"/>	<input type="checkbox"/>	<input type="checkbox"/>	
182. Plumbing	<input type="checkbox"/>	<input checked="" type="checkbox"/>	<input type="checkbox"/>	Other	<input type="checkbox"/>	<input type="checkbox"/>	<input type="checkbox"/>	

**DISCLOSURE STATEMENT: SELLER'S
PROPERTY DISCLOSURE STATEMENT**

183. Page 5

184. THE INFORMATION DISCLOSED IS GIVEN TO THE BEST OF SELLER'S KNOWLEDGE.

185. Property located at 3710 60th Ave SW Rochester MN 55902

186. Are there any items or systems on the Property connected or controlled wirelessly,
187. via internet protocol ("IP"), to a router or gateway or directly to the cloud? Yes No

188. Comments regarding issues in Section C: Garage Doors can be opened via the
189. My Q mobile app.

190. D. SUBSURFACE SEWAGE TREATMENT SYSTEM DISCLOSURE:
191. (A subsurface sewage treatment system disclosure is required by MN Statute 115.55.) (Check appropriate box.)

192. Seller DOES DOES NOT know of a subsurface sewage treatment system on or serving the above-described
(Check one.)

193. real Property. (If answer is **DOES**, and the system does not require a state permit, see *Disclosure Statement:*
194. *Subsurface Sewage Treatment System.*)

195. There is an abandoned subsurface sewage treatment system on the above-described real Property.
196. (See *Disclosure Statement: Subsurface Sewage Treatment System.*)

197. E. PRIVATE WELL DISCLOSURE: (A well disclosure and Certificate are required by MN Statute 103I.235.)
198. (Check appropriate box(es).)

199. Seller does not know of any wells on the above-described real Property.

200. There are one or more wells located on the above-described real Property. (See *Disclosure Statement: Well.*)

201. This Property is in a Special Well Construction Area.

202. There are wells serving the above-described Property that are not located on the Property.

203. (1) How many properties or residences does the shared well serve? _____

204. (2) Is there a maintenance agreement for the shared well? Yes No

205. If "Yes," what is the annual maintenance fee? \$ _____

206. F. PROPERTY TAX TREATMENT:
207. **Preferential Property Tax Treatment**

208. Is the Property subject to any preferential property tax status or any other credits
209. affecting the Property? (e.g., Disabled Veterans' Benefits, Disability, Green Acres,
210. Non-Profit Status, RIM, Rural Preserve, etc.) Yes No

211. If "Yes," would these terminate upon the sale of the Property? Yes No

212. Explain: _____

213. _____

214. G. NOTICES/SPECIAL ASSESSMENTS:

215. The following questions are to be answered to the best of Seller's knowledge.

216. Seller HAS HAS NOT received a notice regarding any proposed, ongoing, or completed improvement
(Check one.)

217. project from any assessing authorities, the cost of which may be assessed, or is currently assessed, against the
218. Property. If "HAS", please attach and/or explain:

219. _____

220. _____

221. _____

222. H. FOREIGN INVESTMENT IN REAL PROPERTY TAX ACT ("FIRPTA"): Section 1445 of the Internal Revenue Code
223. provides that a transferee ("Buyer") of a United States real property interest must be notified in writing and must
224. withhold tax if the transferor ("Seller") is a foreign person and no exceptions from FIRPTA withholding apply.

225. Seller represents that Seller IS IS NOT a foreign person (i.e., a non-resident alien individual, foreign corporation,
(Check one.)

226. foreign partnership, foreign trust, or foreign estate) for purposes of income taxation. This representation shall
227. survive the closing of any transaction involving the Property described here.



**DISCLOSURE STATEMENT: SELLER'S
PROPERTY DISCLOSURE STATEMENT**

228. Page 6

229. THE INFORMATION DISCLOSED IS GIVEN TO THE BEST OF SELLER'S KNOWLEDGE.

230. Property located at 3710 60th Ave SW Rochester MN 55902

231. **NOTE:** If the above answer is "IS," Buyer may be subject to income tax withholding in connection with the
 232. transaction (unless the transaction is covered by an applicable exception to FIRPTA withholding). In non-
 233. exempt transactions, Buyer may be liable for the tax if Buyer fails to withhold.
 234. If the above answer is "IS NOT," Buyer may wish to obtain specific documentation from Seller ensuring
 235. Buyer is exempt from the withholding requirements as prescribed under Section 1445 of the Internal
 236. Revenue Code.

237. Due to the complexity and potential risks of failing to comply with FIRPTA, including Buyer's responsibility
 238. for withholding the applicable tax, Buyer and Seller should **seek appropriate legal and tax advice regarding**
 239. **FIRPTA compliance, as the respective licensees representing or assisting either party will be unable to**
 240. **assure either party whether the transaction is exempt from the FIRPTA withholding requirements.**

241. **I. METHAMPHETAMINE PRODUCTION DISCLOSURE:**

242. (A Methamphetamine Production Disclosure is required by MN Statute 152.0275, Subd. 2 (m).)

243. Seller is not aware of any methamphetamine production that has occurred on the Property.

244. Seller is aware that methamphetamine production has occurred on the Property.

245. (See Disclosure Statement: Methamphetamine Production.)

246. **J. NOTICE REGARDING AIRPORT ZONING REGULATIONS:** The Property may be in or near an airport safety
 247. zone with zoning regulations adopted by the governing body that may affect the Property. Such zoning regulations
 248. are filed with the county recorder in each county where the zoned area is located. If you would like to determine
 249. if such zoning regulations affect the Property, you should contact the county recorder where the zoned area is
 250. located.

251. **K. NOTICE REGARDING CARBON MONOXIDE DETECTORS:** MN Statute 299F.51 requires Carbon Monoxide
 252. Detectors to be located within ten (10) feet from all sleeping rooms. Carbon Monoxide Detectors may or may not
 253. be personal property and may or may not be included in the sale of the home.

254. **L. CEMETERY ACT:** The following questions are to be answered to the best of Seller's knowledge.
 255. MN Statute 307.08 prohibits any damage or illegal molestation of human remains, burials or cemeteries. A
 256. person who intentionally, willfully and knowingly destroys, mutilates, injures, disturbs, or removes human skeletal
 257. remains or human burial grounds is guilty of a felony.

258. Are you aware of any human remains, burials, or cemeteries located on the Property? Yes No

259. If "Yes," please explain: _____

260. All unidentified human remains or burials found outside of platted, recorded or identified cemeteries and in
 261. contexts which indicate antiquity greater than 50 years shall be dealt with according to the provisions of MN
 262. Statute 307.08, Subd. 7.

263. **M. ENVIRONMENTAL CONCERNS:** To your knowledge, have any of the following previously existed or do they
 264. currently exist on the Property?

- | | | | | | |
|--|------------------------------|--|-----------------------------------|------------------------------|--|
| 265. (1) Animal/Insect/Pest Infestation? | <input type="checkbox"/> Yes | <input checked="" type="checkbox"/> No | (6) Lead? (e.g., paint, plumbing) | <input type="checkbox"/> Yes | <input checked="" type="checkbox"/> No |
| 266. (2) Asbestos? | <input type="checkbox"/> Yes | <input checked="" type="checkbox"/> No | (7) Mold? | <input type="checkbox"/> Yes | <input checked="" type="checkbox"/> No |
| 267. (3) Diseased trees? | <input type="checkbox"/> Yes | <input checked="" type="checkbox"/> No | (8) Soil problems? | <input type="checkbox"/> Yes | <input checked="" type="checkbox"/> No |
| 268. (4) Formaldehyde? | <input type="checkbox"/> Yes | <input checked="" type="checkbox"/> No | (9) Underground storage tanks? | <input type="checkbox"/> Yes | <input checked="" type="checkbox"/> No |
| 269. (5) Hazardous waste/substances? | <input type="checkbox"/> Yes | <input checked="" type="checkbox"/> No | (10) Vapor intrusion? | <input type="checkbox"/> Yes | <input checked="" type="checkbox"/> No |

270. (11) Other? _____ Yes No

271. (12) Have you ever been contacted or received any information from any governmental
 272. authority pertaining to possible or actual environmental contamination (e.g., vapor
 273. intrusion, drinking water, and/or soil contamination, etc.) affecting the Property? Yes No

DISCLOSURE STATEMENT: SELLER'S
PROPERTY DISCLOSURE STATEMENT

274. Page 7

275. THE INFORMATION DISCLOSED IS GIVEN TO THE BEST OF SELLER'S KNOWLEDGE.

276. Property located at 3710 60th Ave SW Rochester MN 55902

277. (13) Are you aware if there are currently, or have previously been, any orders issued
278. on the Property by any governmental authority ordering the remediation of a
279. public health nuisance on the Property? Yes No

280. If answer above is "Yes," all orders HAVE HAVE NOT been vacated.
------(Check one.)-----

281. (14) Please provide clarification or further explanation for all applicable "Yes" responses in Section M.

282. _____
283. _____
284. _____
285. _____

286. N. RADON DISCLOSURE: (The following Seller disclosure satisfies MN Statute 144.496.)

287. RADON WARNING STATEMENT: The Minnesota Department of Health strongly recommends that ALL
288. homebuyers have an indoor radon test performed prior to purchase or taking occupancy, and recommends
289. having the radon levels mitigated if elevated radon concentrations are found. Elevated radon concentrations can
290. easily be reduced by a qualified, certified, or licensed, if applicable, radon mitigator.

291. Every buyer of any interest in residential real property is notified that the property may present exposure to
292. dangerous levels of indoor radon gas that may place occupants at risk of developing radon-induced lung cancer.
293. Radon, a Class A human carcinogen, is the leading cause of lung cancer in non-smokers and the second leading
294. cause overall. The seller of any interest in residential real property is required to provide the buyer with any
295. information on radon test results of the dwelling.

296. RADON IN REAL ESTATE: By signing this Statement, Buyer hereby acknowledges receipt of the Minnesota
297. Department of Health's publication entitled **Radon in Real Estate Transactions**, which is attached hereto and
298. can be found at www.health.state.mn.us/communities/environment/air/radon/radonre.html.

299. A seller who fails to disclose the information required under MN Statute 144.496, and is aware of material facts
300. pertaining to radon concentrations in the Property, is liable to the Buyer. A buyer who is injured by a violation of MN
301. Statute 144.496 may bring a civil action and recover damages and receive other equitable relief as determined by
302. the court. Any such action must be commenced within two years after the date on which the buyer closed the
303. purchase or transfer of the real Property.

304. SELLER'S REPRESENTATIONS: The following are representations made by Seller to the extent of Seller's actual
305. knowledge.

306. (a) Radon test(s) HAVE HAVE NOT occurred on the Property.
------(Check one.)-----

307. (b) Describe any known radon concentrations, mitigation, or remediation. **NOTE: Seller shall attach the most**
308. **current records and reports pertaining to radon concentration within the dwelling:**

309. _____
310. _____

312. (c) There IS IS NOT a radon mitigation system currently installed on the Property.
------(Check one.)-----

312. If "IS," Seller shall disclose, if known, information regarding the radon mitigation system, including system
313. description and documentation.

314. _____
315. _____

316. EXCEPTIONS: See Section S for exceptions to this disclosure requirement.

317. O. CHRONIC WASTING DISEASE IN CERVIDAE: (The following Seller disclosure satisfies MN Statute 35.155, Subd. 11(d).)

318. Has Chronic Wasting Disease been detected on the Property? YES NO
------(Check one.)-----

319. If Yes, see *Disclosure Statement: Chronic Wasting Disease*.



**DISCLOSURE STATEMENT: SELLER'S
PROPERTY DISCLOSURE STATEMENT**

320. Page 8

321. **THE INFORMATION DISCLOSED IS GIVEN TO THE BEST OF SELLER'S KNOWLEDGE.**

322. Property located at 3710 60th Ave SW Rochester MN 55902

323. **P. OTHER DEFECTS/MATERIAL FACTS/ADDITIONAL COMMENTS:** Are there any other material facts that could
324. adversely and significantly affect an ordinary buyer's use or enjoyment of the Property or any intended use of the

325. Property? Yes No. If "Yes," explain: _____

326. _____

327. _____

328. _____

329. _____

330. _____

331. _____

332. _____

333. **Q. WATER INTRUSION AND MOLD GROWTH:** Studies have shown that various forms of water intrusion affect
334. many homes. Water intrusion may occur from exterior moisture entering the home and/or interior moisture
335. leaving the home.

336. Examples of exterior moisture sources may be:

- 337. • improper flashing around windows and doors,
- 338. • improper grading,
- 339. • flooding,
- 340. • roof leaks.

341. Examples of interior moisture sources may be:

- 342. • plumbing leaks,
- 343. • condensation (caused by indoor humidity that is too high or surfaces that are too cold),
- 344. • overflow from tubs, sinks, or toilets,
- 345. • firewood stored indoors,
- 346. • humidifier use,
- 347. • inadequate venting of kitchen and bath humidity,
- 348. • improper venting of clothes dryer exhaust outdoors (including electrical dryers),
- 349. • line-drying laundry indoors,
- 350. • houseplants—watering them can generate large amounts of moisture.

351. In addition to the possible structural damage water intrusion may do to the Property, water intrusion may also result
352. in the growth of mold, mildew, and other fungi. Mold growth may also cause structural damage to the Property.
353. Therefore, it is very important to detect and remediate water intrusion problems.

354. Fungi are present everywhere in our environment, both indoors and outdoors. Many molds are beneficial to
355. humans. However, molds have the ability to produce mycotoxins that may have a potential to cause serious
356. health problems, particularly in some immunocompromised individuals and people who have asthma or allergies
357. to mold.

358. To complicate matters, mold growth is often difficult to detect, as it frequently grows within the wall structure. If you
359. have a concern about water intrusion or the resulting mold/mildew/fungi growth, you may want to consider having the
360. Property inspected for moisture problems before entering into a purchase agreement or as a condition of your
361. purchase agreement. Such an analysis is particularly advisable if you observe staining or musty odors on the
362. Property.

363. **R. NOTICE REGARDING PREDATORY OFFENDER INFORMATION:** Information regarding the predatory
364. offender registry and persons registered with the predatory offender registry under MN Statute 243.166
365. may be obtained by contacting the local law enforcement offices in the community where the property
366. is located or the Minnesota Department of Corrections at (651) 361-7200, or from the Department of
367. Corrections web site at <https://coms.doc.state.mn.us/publicregistrantsearch>.

**DISCLOSURE STATEMENT: SELLER'S
PROPERTY DISCLOSURE STATEMENT**

368. Page 9

369. **THE INFORMATION DISCLOSED IS GIVEN TO THE BEST OF SELLER'S KNOWLEDGE.**

370. Property located at 3710 60th Ave SW Rochester MN 55902

371. **S. MN STATUTES 513.52 THROUGH 513.60: SELLER'S MATERIAL FACT DISCLOSURE:**

372. **Exceptions:** The seller disclosure requirements of MN Statutes 513.52 through 513.60 **DO NOT** apply to
- 373. (1) real property that is not residential real property;
 - 374. (2) a gratuitous transfer;
 - 375. (3) a transfer pursuant to a court order;
 - 376. (4) a transfer to a government or governmental agency;
 - 377. (5) a transfer by foreclosure or deed in lieu of foreclosure;
 - 378. (6) a transfer to heirs or devisees of a decedent;
 - 379. (7) a transfer from a co-tenant to one or more other co-tenants;
 - 380. (8) a transfer made to a spouse, parent, grandparent, child, or grandchild of Seller;
 - 381. (9) a transfer between spouses resulting from a decree of marriage dissolution or from a property agreement incidental to that decree;
 - 382. (10) a transfer of newly constructed residential property that has not been inhabited;
 - 383. (11) an option to purchase a unit in a common interest community, until exercised;
 - 384. (12) a transfer to a person who controls or is controlled by the grantor as those terms are defined with respect to a declarant under section 515B.1-103, clause (2);
 - 385. (13) a transfer to a tenant who is in possession of the residential real property; or
 - 386. (14) a transfer of special declarant rights under section 515B.3-104.

389. **MN STATUTES 144.496: RADON AWARENESS ACT**

390. The seller disclosure requirements of MN Statute 144.496 DO NOT apply to (1)-(9) and (11)-(14) above. Sellers
391. of newly constructed residential property must comply with the disclosure requirements of MN Statute 144.496.

392. **Waiver:** The written disclosure required under sections 513.52 to 513.60 may be waived if Seller and the
393. prospective Buyer agree in writing. Waiver of the disclosure required under sections 513.52 to 513.60 does not
394. waive, limit, or abridge any obligation for seller disclosure created by any other law.

395. **No Duty to Disclose:**

- 396. (A) There is no duty to disclose the fact that the Property
 - 397. (1) is or was occupied by an owner or occupant who is or was suspected to be infected with Human
 - 398. Immunodeficiency Virus or diagnosed with Acquired Immunodeficiency Syndrome;
 - 399. (2) was the site of a suicide, accidental death, natural death, or perceived paranormal activity; or
 - 400. (3) is located in a neighborhood containing any adult family home, community-based residential facility, or
 - 401. nursing home.
- 402. (B) **Predatory Offenders.** There is no duty to disclose information regarding an offender who is required to
403. register under MN Statute 243.166 or about whom notification is made under that section, if Seller, in a timely
404. manner, provides a written notice that information about the predatory offender registry and persons
405. registered with the registry may be obtained by contacting the local law enforcement agency where the
406. property is located or the Department of Corrections.
- 407. (C) The provisions in paragraphs (A) and (B) do not create a duty to disclose any facts described in paragraphs
408. (A) and (B) for property that is not residential property.
- 409. (D) **Inspections.**
 - 410. (1) Except as provided in paragraph (2), Seller is not required to disclose information relating to the real
 - 411. Property if a written report that discloses the information has been prepared by a qualified third party
 - 412. and provided to the prospective buyer. For purposes of this paragraph, "qualified third party" means a
 - 413. federal, state, or local governmental agency, or any person whom Seller or prospective buyer reasonably
 - 414. believes has the expertise necessary to meet the industry standards of practice for the type of inspection
 - 415. or investigation that has been conducted by the third party in order to prepare the written report.
 - 416. (2) Seller shall disclose to the prospective buyer material facts known by Seller that contradict any
 - 417. information included in a written report under paragraph (1) if a copy of the report is provided to Seller.

MN:DS:SPDS-9 (8/25)

**DISCLOSURE STATEMENT: SELLER'S
PROPERTY DISCLOSURE STATEMENT**

418. Page 10

419. **THE INFORMATION DISCLOSED IS GIVEN TO THE BEST OF SELLER'S KNOWLEDGE.**

420. Property located at 3710 60th Ave SW Rochester MN 55902

421. **T. ADDITIONAL COMMENTS:** _____

422. _____

423. _____

424. _____

425. _____

426. _____

427. _____

428. _____

429. **U. SELLER'S STATEMENT:**

430. *(To be signed at time of listing.)*

431. Seller(s) hereby states the facts as stated above are true and accurate and authorizes any licensee(s) representing
432. or assisting any party(ies) in this transaction to provide a copy of this Disclosure Statement to any person or entity
433. in connection with any actual or anticipated sale of the Property. A seller may provide this Disclosure Statement
434. to a real estate licensee representing or assisting a prospective buyer. The Disclosure Statement provided to the
435. real estate licensee representing or assisting a prospective buyer is considered to have been provided to the
436. prospective buyer. If this Disclosure Statement is provided to the real estate licensee representing or assisting
437. the prospective buyer, the real estate licensee must provide a copy to the prospective buyer.

438. **Seller is obligated to continue to notify Buyer in writing of any facts that differ from the facts disclosed
439. here (new or changed) of which Seller is aware that could adversely and significantly affect the Buyer's
440. use or enjoyment of the Property or any intended use of the Property that occur up to the time of closing.**

441. To disclose new or changed facts, please use the *Amendment to Disclosure Statement* form.

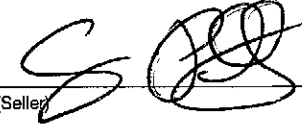
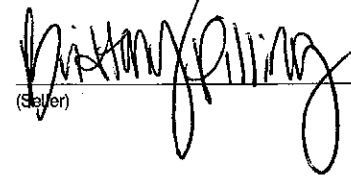
442.  _____ 3/24/26  _____ 3/24/20
(Seller) (Date) (Seller) (Date)

443. **V. BUYER'S ACKNOWLEDGEMENT:**

444. *(To be signed at time of purchase agreement.)*

445. I/We, the Buyer(s) of the Property, acknowledge receipt of this *Seller's Property Disclosure Statement* and agree
446. that no representations regarding facts have been made other than those made above. This Disclosure Statement
447. is not a warranty or a guarantee of any kind by Seller or licensee(s) representing or assisting any party in the
448. transaction and is not a substitute for any inspections or warranties the party(ies) may wish to obtain.

449. The information disclosed is given to the best of Seller's knowledge.

450. _____ (Buyer) _____ (Date) _____ (Buyer) _____ (Date)

451. **LISTING BROKER AND LICENSEES MAKE NO REPRESENTATIONS HERE AND ARE
452. NOT RESPONSIBLE FOR ANY CONDITIONS EXISTING ON THE PROPERTY.**



Radon in Real Estate Transactions

All Minnesota homes can have dangerous levels of radon gas. Radon is a colorless and odorless gas that comes from the soil. The gas can accumulate in the home. When inhaled, its radioactive particles can damage the lungs. Long-term exposure to radon can lead to lung cancer. About 21,000 lung cancer deaths each year in the United States are caused by radon.

The only way to know how much radon gas has entered the home is to conduct a radon test. MDH estimates 2 in 5 homes exceed the 4.0 pCi/L (picocuries per liter) action level. Whether a home is old or new, any home can have high levels of radon.

The purpose of this publication is to educate and inform potential home buyers of the risks of radon exposure, and how to test for and reduce radon as part of real estate transactions.

Disclosure Requirements

Effective January 1, 2014, the Minnesota Radon Awareness Act requires specific disclosure and education be provided to potential home buyers during residential real estate transactions in Minnesota.

Before signing a purchase agreement to sell or transfer residential real property, the seller shall provide this publication and shall disclose in writing to the buyer:

1. whether a radon test or tests have occurred on the property
2. the most current records and reports pertaining to radon concentrations within the dwelling
3. a description of any radon levels, mitigation, or remediation
4. information on the radon mitigation system, if a system was installed
5. a radon warning statement

Radon Facts

How dangerous is radon? Radon is the number one cause of lung cancer in nonsmokers, and the second leading cause overall. Your risk for lung cancer increases with higher levels of radon, prolonged exposure, and whether or not you are a current smoker or former smoker.

Where is your greatest exposure to radon? For most Minnesotans, your greatest exposure is at home where radon can concentrate indoors.

What is the recommended action based on my results? If the average radon in the home is at or above 4.0 pCi/L, the home's radon level should be reduced. Also, consider mitigating if radon levels are between 2.0 pCi/L and 3.9 pCi/L. Any amount of radon, even below the recommended action level, carries some risk. A home's radon levels may change in the future, so test every 2-5 years, or sooner if there is major remodeling or changes to the foundation, heating, cooling, or ventilation.

Radon Warning Statement

"The Minnesota Department of Health strongly recommends that ALL home buyers have an indoor radon test performed prior to purchase or taking occupancy, and recommends having the radon levels mitigated if elevated radon concentrations are found. Elevated radon concentrations can easily be reduced by a qualified, certified, or licensed, if applicable, radon mitigator.

Every buyer of any interest in residential real property is notified that the property may present exposure to dangerous levels of indoor radon gas that may place the occupants at risk of developing radon-induced lung cancer. Radon, a Class A human carcinogen, is the leading cause of lung cancer in nonsmokers and the second leading cause overall. The seller of any interest in residential real property is required to provide the buyer with any information on radon test results of the dwelling."

Radon Testing

Any test lasting less than three months requires **closed-house conditions**. Closed-house conditions include keeping all windows and doors closed, except for normal entry and exit, and temperature set to 65 – 80 °F. For a full list of closed-house conditions please visit mn.gov/radon/notice.

Before testing: Begin closed-house conditions at least 12 hours before the start of the radon test.

During testing: Maintain closed-house conditions during the entire duration of the short-term test. Operate home heating or cooling systems normally during the test.

Where should the test be conducted? Any radon test conducted for a real estate transaction needs to be placed in the lowest livable area of the home suitable for occupancy. This is typically in the basement, whether finished or unfinished. If other foundations are present, such as a crawl space or slab on grade, also test the rooms above these foundations.

Place the test kit:

- 20 inches to 6 feet above the floor
- 3 feet from exterior doors and windows
- 1 foot from exterior walls
- away from heat sources and drafts caused by vents and fans
- not in enclosed areas or areas of high heat/humidity

How are radon tests conducted in real estate transactions?

There are special protocols for radon testing in real estate transactions. Because these tests are time-sensitive there are two testing options. For both tests, test for a minimum of 2 days.

Continuous Radon Monitor (CRM)

MDH recommends CRMs in real estate testing. CRMs are calibrated, provide more data, and may detect tampering. The average of the results are used to make a decision to mitigate.

Simultaneous Short-Term Testing

Two short-term test kits are placed side by side, 4" – 8" apart. The results of the two tests are averaged and used to make a decision to mitigate.

Radon Mitigation

When elevated levels of radon are found, they can be easily reduced by a licensed professional.

Radon mitigation is the process or system used to reduce radon concentrations in the breathing zones of occupied buildings. The goal of a radon mitigation system is to reduce the indoor radon levels to below the action level. This is done by drawing soil gas from under the house and venting it above the roof. A quality mitigation system is often able to reduce the annual average radon level to below 2.0 pCi/L. The cost of a radon mitigation system averages \$1,500 to \$3,000.

After a radon mitigation system is installed perform an independent short-term test to ensure the reduction system is effective. Operate the radon system during the entire test. This short-term test will confirm low levels in the home. Be sure to retest the house every two years to confirm continued radon reduction.

All radon testing and mitigation should be conducted by licensed radon professionals. Radon service providers, such as home inspectors, must be licensed. A list of these licensed radon professionals can be found at MDH's radon web site. MDH conducts free inspections, upon request, of recently installed radon mitigation systems, to check that they meet requirements.

More Radon Information

www.mn.gov/radon

Last Updated 4/2023

MDH Indoor Air Unit

PO Box 64975
St Paul, MN 55164-0975

Contact Information

651-201-4601
800-798-9050
health.indoorair@state.mn.us

DISCLOSURE STATEMENT: SUBSURFACE SEWAGE TREATMENT SYSTEM

This form is approved by the Minnesota Association of REALTORS®, which disclaims any liability arising out of use or misuse of this form. © 2021-2023 Minnesota Association of REALTORS®

- 1. Date _____
- 2. Page 1 of _____ pages:
- 3. THE REQUIRED MAP IS ATTACHED AND MADE A
- 4. PART OF THIS DISCLOSURE.

5. Property located at 3710 60th Ave SW
6. City of Rochester, County of Olmsted

7. State of Minnesota, Zip Code 55902, legally described as follows or on attached sheet:
8. SECT-19 TWP-106 RANGE-014 10.90 AC THE W794FT S594FT NW1/4 SW1/4 SEC 19-106-14 ("Property").

9. This disclosure is not a warranty of any kind by Seller(s) or any licensee(s) representing or assisting any party(ies) in this transaction, and is not a substitute for any inspections or warranties the party(ies) may wish to obtain.

11. **BUYER(S) AND SELLER(S) MAY WISH TO OBTAIN PROFESSIONAL ADVICE AND/OR INSPECTIONS OF THE SUBSURFACE SEWAGE TREATMENT SYSTEM AND TO PROVIDE FOR APPROPRIATE PROVISIONS IN A CONTRACT BETWEEN BUYER(S) AND SELLER(S) WITH RESPECT TO ANY ADVICE/INSPECTION DEFECTS.**

15. **SELLER'S INFORMATION:** The following Seller disclosure satisfies MN Statutes Chapter 115.55. Seller discloses the following information with the knowledge that even though this is not a warranty, prospective Buyers may rely on this information in deciding whether and on what terms to purchase the Property. The Seller(s) authorizes any licensee(s) representing or assisting any party(ies) in this transaction to provide a copy of this statement to any person or entity in connection with any actual or anticipated sale of the Property.

20. Unless Buyer and Seller agree to the contrary in writing before the closing of the sale, a Seller who fails to disclose the existence or known status of a subsurface sewage treatment system at the time of sale, and who knew or had reason to know of the existence or known status of the system, is liable to Buyer for costs relating to bringing the system into compliance with subsurface sewage treatment system rules and for reasonable attorney fees for collection of costs from Seller. An action under this subdivision must be commenced within two years after the date on which Buyer closed the purchase of the real property where the system is located.

26. Legal requirements exist relating to various aspects of location and status of subsurface sewage treatment systems. Buyer is advised to contact the local unit(s) of government, state agency, or qualified professional which regulates subsurface sewage treatment systems for further information about these issues.

29. The following are representations made by Seller(s) to the extent of Seller(s) actual knowledge. This information is a disclosure and is not intended to be part of any contract between Buyer and Seller.

31. **SUBSURFACE SEWAGE TREATMENT SYSTEM DISCLOSURE:** (Check the appropriate boxes.)

32. Seller certifies that the following subsurface sewage treatment system is on or serving the above-described Property.

33. TYPE: (Check appropriate box(es) and indicate location on attached Disclosure Statement: Location Map.)

34. Septic Tank: with drain field with mound system seepage tank with open end

35. Is this system a straight-pipe system? Yes No Unknown

36. Sealed System (holding tank)

37. Other (Describe.): _____

38. Is the subsurface sewage treatment system(s) currently in use? Yes No

39. Is the above-described Property served by a subsurface sewage treatment system located entirely within the Property boundary lines, including setback requirements? Yes No

40. If "No," please explain: _____

41. _____

42. _____

43. Comments: _____

44. _____



DISCLOSURE STATEMENT: SUBSURFACE SEWAGE TREATMENT SYSTEM

45. Page 2

46. Property located at 3710 60th Ave SW Rochester MN 55902

47. Is the subsurface sewage treatment system(s) a shared system? [] Yes [X] No

48. If "Yes,"

49. (1) How many properties or residences does the subsurface sewage treatment system serve?

50. _____

51. (2) Is there a maintenance agreement for the shared subsurface sewage treatment system? [] Yes [X] No

52. If "Yes," what is the annual maintenance fee? \$ _____

53. NOTE: If any water use appliance, bedroom, or bathroom has been added to the Property, the system may no longer comply with applicable sewage treatment system laws and rules.

54. Seller or transferor shall disclose to Buyer or transferee what Seller or transferor has knowledge of relative to the compliance status of the subsurface sewage treatment system.

55. _____

56. _____

57. Any previous inspection report in Seller's possession must be attached to this Disclosure Statement.

58. When was the subsurface sewage treatment system installed? ~ 06/30/2017

59. Installer Name/Phone Hofschulte Backhoe & Septic 507-876-2700

60. Where is tank located? West of the home near the backyard fence

61. What is tank size? 1500 Gal

62. When was tank last pumped? _____

63. How often is tank pumped? _____

64. Where is the drain field located? _____

65. What is the drain field size? _____

66. Describe work performed to the subsurface sewage treatment system since you have owned the Property.

67. _____

68. Date work performed/by whom: _____

69. _____

70. Approximate number of:

71. people using the subsurface sewage treatment system 2

72. showers/baths taken per week 13

73. wash loads per week 8

74. NOTE: Changes in the number of people using the subsurface sewage treatment system or volume of water used may affect the subsurface sewage treatment system performance.

75. Distance between well and subsurface sewage treatment system? _____

76. Have you received any notices from any government agencies relating to the subsurface sewage treatment system? [] Yes [X] No

77. (If "Yes," see attached notice.)

78. Are there any known defects in the subsurface sewage treatment system? [] Yes [X] No

79. If "Yes," please explain: _____

80. _____

81. _____



**DISCLOSURE STATEMENT: SUBSURFACE
SEWAGE TREATMENT SYSTEM**

86. Page 3

87. Property located at 3710 60th Ave SW Rochester MN 55902

88. **SELLER'S STATEMENT:** *(To be signed at time of listing.)*

89. Seller(s) hereby states the facts as stated above are true and accurate and authorizes any licensee(s) representing or
90. assisting any party(ies) in this transaction to provide a copy of this Disclosure Statement to any person or entity in
91. connection with any actual or anticipated sale of the Property. A seller may provide this Disclosure Statement to a
92. real estate licensee representing or assisting a prospective buyer. The Disclosure Statement provided to the real
93. estate licensee representing or assisting a prospective buyer is considered to have been provided to the prospective
94. buyer. If this Disclosure Statement is provided to the real estate licensee representing or assisting the prospective
95. buyer, the real estate licensee must provide a copy to the prospective buyer.

96. **Seller is obligated to continue to notify Buyer in writing of any facts that differ from the facts disclosed here**
97. **(new or changed) of which Seller is aware that could adversely and significantly affect the Buyer's use or**
98. **enjoyment of the Property or any intended use of the Property that occur up to the time of closing.** To disclose
99. new or changed facts, please use the *Amendment to Disclosure Statement* form.

100. _____
(Seller) (Date)  _____ 3/24/20
(Date)

101. **BUYER'S ACKNOWLEDGEMENT:** *(To be signed at time of purchase agreement.)*

102. I/We, the Buyer(s) of the Property, acknowledge receipt of this *Disclosure Statement: Subsurface Sewage Treatment*
103. *System and Disclosure Statement: Location Map* and agree that no representations regarding facts have been made
104. other than those made above.

105. _____
(Buyer) (Date) _____
(Buyer) (Date)

106. **LISTING BROKER AND LICENSEES MAKE NO REPRESENTATIONS HERE AND ARE**
107. **NOT RESPONSIBLE FOR ANY CONDITIONS EXISTING ON THE PROPERTY.**

MN-DS:SSTS-3 (8/25)

DISCLOSURE STATEMENT: WELL

This form is approved by the Minnesota Association of REALTORS®, which disclaims any liability arising out of use or misuse of this form. © 2022-2023 Minnesota Association of REALTORS®

- 1. Date _____
- 2. Page 1 of _____ pages: THE REQUIRED MAP
- 3. IS ATTACHED HERE AND MADE A PART OF THIS
- 4. DISCLOSURE.

5. Minnesota Statute 103I.235 requires that, before signing an agreement to sell or transfer real property, Seller must disclose information in writing to Buyer about the status and location of all known wells on the property. This requirement is satisfied by delivering to Buyer either a statement by Seller that Seller does not know of any wells on the property, or a disclosure statement indicating the legal description and county, and a map showing the location of each well. In the disclosure statement Seller must indicate, for each well, whether the well is in use, not in use or sealed.

10. Unless Buyer and Seller agree to the contrary in writing, before the closing of the sale, a Seller who fails to disclose the existence or known status of a well at the time of sale, and knew or had reason to know of the existence or known status of the well, is liable to Buyer for costs relating to sealing of the well and reasonable attorneys' fees for collection of costs from Seller, if the action is commenced within six years after the date Buyer closed the purchase of the real property where the well is located.

15. Legal requirements exist relating to various aspects of location and status of wells. Buyer is advised to contact the local unit(s) of government, state agency, or qualified professional which regulates wells for further information about these issues. For additional information on wells, please visit the Minnesota Department of Health's website at www.health.state.mn.us.

19. Instructions for completion of this form are on page two (2).

20. **PROPERTY DESCRIPTION:** Street Address: 3710 60th Ave SW

21. City of Rochester, County of Olmsted

22. State of Minnesota, Zip Code 55902

23. **LEGAL DESCRIPTION:** SECT-19 TWP-106 RANGE-014 10.90 AC THE W794FT S594FT NW1/4 SW1/4 SEC 19-106-14

24. _____
 25. _____ ("Property").

26. **WELL DISCLOSURE STATEMENT: (Check appropriate boxes.)**

27. Seller certifies that the following wells are located on the above-described real Property.

28.	MN Unique	Well	Year of	Well	IN USE	NOT IN USE	SHARED	SEALED
29.	Well No.	Depth	Const.	Type		USE		
30.	Well 1	<u>824323</u>	<u>2017</u>	_____	<input checked="" type="checkbox"/>	<input type="checkbox"/>	<input type="checkbox"/>	<input type="checkbox"/>
31.	Well 2	_____	_____	_____	<input type="checkbox"/>	<input type="checkbox"/>	<input type="checkbox"/>	<input type="checkbox"/>
32.	Well 3	_____	_____	_____	<input type="checkbox"/>	<input type="checkbox"/>	<input type="checkbox"/>	<input type="checkbox"/>

33. Is this property served by a well not located on the Property? Yes No

34. If "Yes," please explain: _____

35. _____

36. **NOTE: See definition of terms "IN USE," "NOT IN USE," and "SEALED" on lines 87-97. If a well is not in use, it must be sealed by a licensed well contractor or a well owner must obtain a maintenance permit from the Minnesota Department of Health and pay an annual maintenance fee. Maintenance permits are not transferable. If a well is operable and properly maintained, a maintenance permit is not required.**

40. If the well is, "Shared":

41. (1) How many properties or residences does the shared well serve? 1

42. (2) Who manages the shared well? _____

43. (3) Is there a maintenance agreement for the shared well? Yes No

44. If "Yes," what is the annual maintenance fee? \$ _____

DISCLOSURE STATEMENT: WELL

46. Property located at 3710 60th Ave SW Rochester MN 55902

47. **OTHER WELL INFORMATION:**

48. Date well water last tested for contaminants: 07/11/2017 Test results attached? Yes No

49. Contaminated Well: Is there a well on the Property containing contaminated water? Yes No

50. Comments: _____

51. _____

52. _____

53. _____

54. _____

55. _____

56. _____

57. **SEALED WELL INFORMATION:** For each well designated as sealed above, complete this section.

58. When was the well sealed? 07/2017

59. Who sealed the well? _____

60. Was a Sealed Well Report filed with the Minnesota Department of Health? Yes No

61. **MAP: Complete the attached Disclosure Statement: Location Map showing the location of each well on the**
62. **real Property.**

63. This disclosure is not a warranty of any kind by Seller(s) or any licensee(s) representing or assisting any part/(ies) in
64. this transaction and is not a substitute for any inspections or warranties the party(ies) may wish to obtain.

65. **INSTRUCTIONS FOR COMPLETING THE WELL DISCLOSURE STATEMENT**

66. **DEFINITION:** A "well" means an excavation that is drilled, cored, bored, washed, driven, dug, jetted, or otherwise
67. constructed if the excavation is intended for the location, diversion, artificial recharge, or acquisition of groundwater.

68. **MINNESOTA UNIQUE WELL NUMBER:** All new wells constructed AFTER January 1, 1975, should have been
69. assigned a Minnesota unique well number by the person constructing the well. If the well was constructed after this
70. date, you should have the unique well number in your property records. If you are unable to locate your unique well
71. number and the well was constructed AFTER January 1, 1975, contact your well contractor. If no unique well number
72. is available, please indicate the depth and year of construction for each well.

73. **WELL TYPE:** Use one of the following terms to describe the well type.

74. **WATER WELL:** A water well is any type of well used to extract groundwater for private or public use.
75. Examples of water wells are: domestic wells, drive-point wells, dug wells, remedial wells, and municipal
76. wells.

77. **IRRIGATION WELL:** An irrigation well is a well used to irrigate agricultural lands. These are typically
78. large-diameter wells connected to a large pressure distribution system.

79. **MONITORING WELL:** A monitoring well is a well used to monitor groundwater contamination. The well is
80. typically used to access groundwater for the extraction of samples.

81. **DEWATERING WELL:** A dewatering well is a well used to lower groundwater levels to allow for construction
82. or use of underground spaces.

83. **INDUSTRIAL/COMMERCIAL WELL:** An industrial/commercial well is a nonpotable well used to extract
84. groundwater for any nonpotable use, including groundwater thermal exchange wells (heat pumps and heat
85. loops).

DISCLOSURE STATEMENT: WELL

87. **WELL USE STATUS:** Indicate the use status of each well. CHECK ONLY ONE (1) BOX PER WELL.

88. **IN USE:** A well is "in use" if the well is operated on a daily, regular, or seasonal basis. A well in use includes
89. a well that operates for the purpose of irrigation, fire protection, or emergency pumping.

90. **NOT IN USE:** A well is "not in use" if the well does not meet the definition of "in use" above and has not
91. been sealed by a licensed well contractor.

92. **SEALED:** A well is "sealed" if a licensed contractor has completely filled a well by pumping grout material
93. throughout the entire bore hole after removal of any obstructions from the well. A well is "capped" if it has
94. a metal or plastic cap or cover which is threaded, bolted or welded into the top of the well to prevent entry
95. into the well. A "capped" well is not a "sealed" well.

96. If the well has been sealed by someone other than a licensed well contractor or a licensed well sealing
97. contractor, check the well status as "not in use."

98. If you have any questions, please contact the Minnesota Department of Health, Well Management Section,
99. at (651) 201-4587 (metropolitan Minneapolis-St. Paul) or 1-800-383-9808 (greater Minnesota).

100. **SELLER'S STATEMENT:** *(To be signed at time of listing.)*

101. Seller(s) hereby states that the facts as stated above are true and accurate and authorizes any licensee(s) representing
102. or assisting any party(ies) in this transaction to provide a copy of this Disclosure Statement to any person or entity
103. in connection with any actual or anticipated sale of the Property. A seller may provide this Disclosure Statement to
104. a real estate licensee representing or assisting a prospective buyer. The Disclosure Statement provided to the real
105. estate licensee representing or assisting a prospective buyer is considered to have been provided to the prospective
106. buyer. If this Disclosure Statement is provided to the real estate licensee representing or assisting the prospective
107. buyer, the real estate licensee must provide a copy to the prospective buyer.

108. **Seller is obligated to continue to notify Buyer in writing of any facts that differ from the facts disclosed here**
109. **(new or changed) of which Seller is aware that could adversely and significantly affect the Buyer's use or**
110. **enjoyment of the Property or any intended use of the Property that occur up to the time of closing.** To disclose
111. new or changed facts, please use the *Amendment to Disclosure Statement* form.

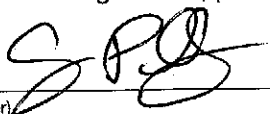
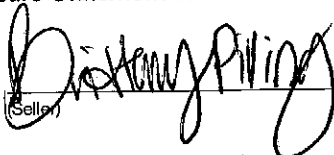
112.  3/24/26  3/24/24
(Seller) (Date) (Seller) (Date)

113. **BUYER'S ACKNOWLEDGEMENT:** *(To be signed at time of purchase agreement.)*

114. I/We, the Buyer(s) of the Property, acknowledge receipt of this *Disclosure Statement: Well* and *Disclosure Statement:*
115. *Location Map* and agree that no representations regarding facts have been made other than those made above.

116. _____
(Buyer) (Date) (Buyer) (Date)

117. **LISTING BROKER AND LICENSEES MAKE NO REPRESENTATIONS HERE AND ARE**
118. **NOT RESPONSIBLE FOR ANY CONDITIONS EXISTING ON THE PROPERTY.**



DISCLOSURE STATEMENT: LOCATION MAP

This form is approved by the Minnesota Association of REALTORS®, which disclaims any liability arising out of use or misuse of this form. © 2021-2023 Minnesota Association of REALTORS®

1. Page 1 of 1 pages

2. Please use the space below to sketch the real property being sold and, to Seller's knowledge, the approximate location of any of the following on the property.

4. SUBSURFACE SEWAGE TREATMENT SYSTEM WELL METHAMPHETAMINE PRODUCTION AREA
(Check all that apply.)

5. Include approximate distances from fixed reference points such as streets, buildings and landmarks.

6. Property located at 3710 60th Ave SW Rochester MN 55902

7. SECT-19 TWP-106 RANGE-014 10.90 AC THE W794FT S594FT NW1/4 SW1/4 SEC 19-106-14

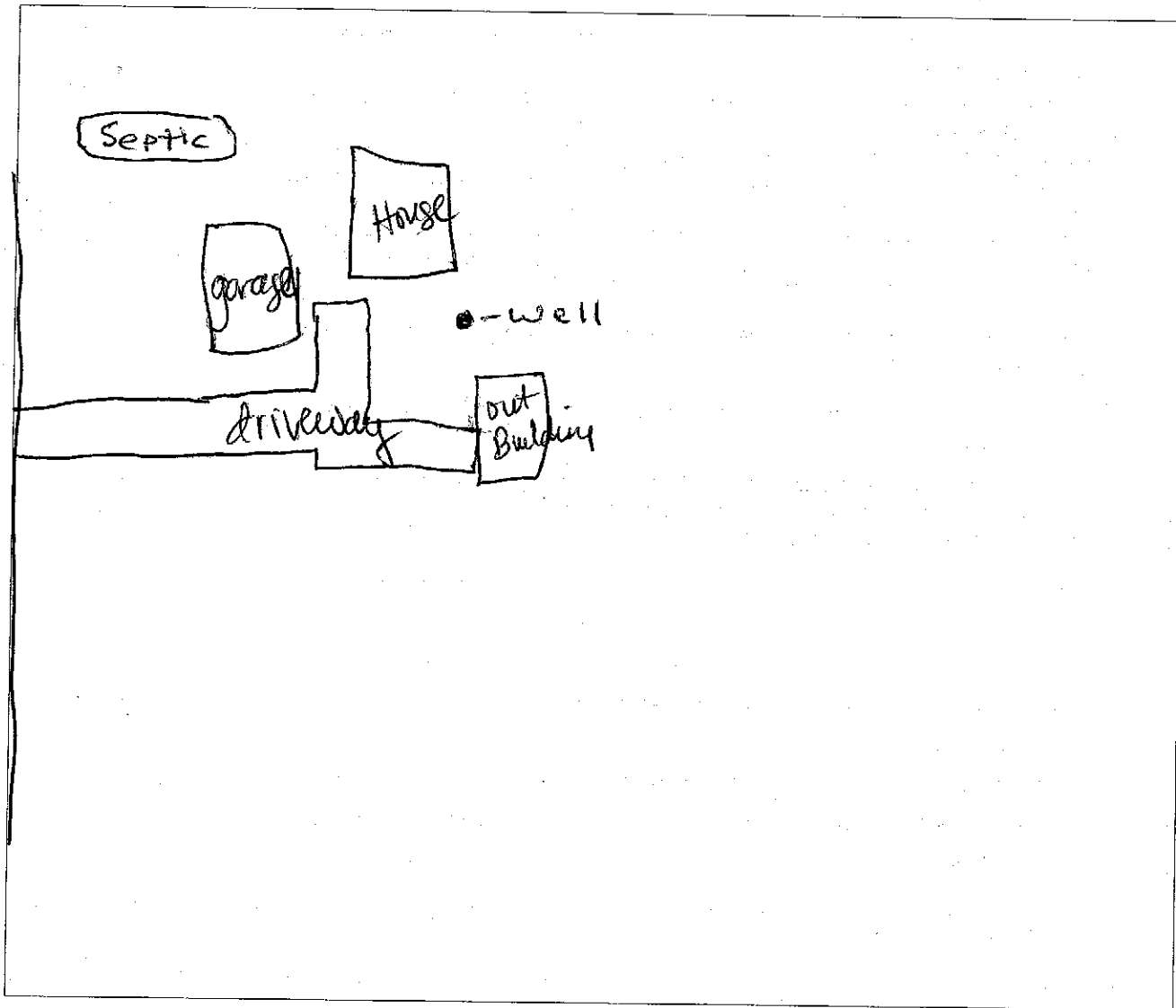

8. ATTACH ADDITIONAL SHEETS AS NEEDED.

9. Seller and Buyer initial: CP 3/24/26 _____
(Seller) (Date) (Buyer) (Date)

10. RP 3/24/26 _____
(Seller) (Date) (Buyer) (Date)

11. ORIGINAL COPY TO LISTING BROKER; COPIES TO SELLER, BUYER, SELLING BROKER

MN-IM (8/25)



**ADDENDUM TO PURCHASE AGREEMENT:
DISCLOSURE OF INFORMATION ON
LEAD-BASED PAINT AND LEAD-BASED
PAINT HAZARDS**

This form is approved by the Minnesota Association of REALTORS®, which disclaims any liability arising out of use or misuse of this form.
© 2020-2023 Minnesota Association of REALTORS®

1. Date _____
2. Page 1

3. Addendum to Purchase Agreement between parties, dated _____
4. (Date of this Purchase Agreement), pertaining to the purchase and sale of the Property at
5. 3710 60th Ave SW Rochester MN 55902

6. **Lead Warning Statement**

7. *Every buyer of any interest in residential real property on which a residential dwelling was built prior to 1978 is notified*
8. *that such property may present exposure to lead from lead-based paint that may place young children at risk of*
9. *developing lead poisoning. Lead poisoning in young children may produce permanent neurological damage, including*
10. *learning disabilities, reduced intelligence quotient, behavioral problems, and impaired memory. Lead poisoning also*
11. *poses a particular risk to pregnant women. The seller of any interest in residential real property is required to provide*
12. *the buyer with any information on lead-based paint hazards from risk assessments or inspections in the seller's*
13. *possession and notify the buyer of any known lead-based paint hazards. A risk assessment or inspection for possible*
14. *lead-based paint hazards is recommended prior to purchase.*

15. **Seller's Disclosure (Check one.)**

16. Seller has no knowledge of, or records or reports relating to, lead-based paint and/or lead-based paint hazards
17. in the housing.

18. Seller has knowledge of lead-based paint and/or lead-based paint hazards in the housing and has provided Buyer
19. with all available details, records, and reports, if any, pertaining to lead-based paint and/or lead-based paint
20. hazards in the housing. (Please explain and list documents below.):

21. _____
22. _____
23. _____

24. **Buyer's Acknowledgment**

25. Buyer has received copies of all information listed above, if any.

26. Buyer has received the pamphlet, *Protect Your Family from Lead in Your Home*.

27. Buyer has: (Check one.)

28. Waived the opportunity to conduct a risk assessment or inspection for the presence of lead-based paint and/or
29. lead-based paint hazards; or

30. Received a 10-day opportunity (or mutually agreed-upon period) to conduct a risk assessment or inspection for
31. the presence of lead-based paint and/or lead-based paint hazards.

32. If checked, this contract is contingent upon a risk assessment or an inspection of the property for the presence of lead-
33. based paint and/or lead-based paint hazards to be conducted at Buyer's expense. The assessment or inspection

34. shall be completed within **TEN (10)** _____ calendar days after Final Acceptance of the Purchase
----- (Check one.) -----

35. Agreement.

**ADDENDUM TO PURCHASE AGREEMENT:
DISCLOSURE OF INFORMATION ON
LEAD-BASED PAINT AND LEAD-BASED
PAINT HAZARDS**

36. Page 2

37. Property located at 3710 60th Ave SW Rochester MN 55902

38. This contingency shall be deemed removed, and the Purchase Agreement shall be in full force and effect,
39. unless Buyer or real estate licensee representing or assisting Buyer delivers to Seller or real estate licensee
40. representing or assisting Seller, within three (3) calendar days after the assessment or inspection is timely
41. completed, a written list of the specific deficiencies and the corrections required, together with a copy of any risk
42. assessment or inspection report. If Buyer and Seller have not agreed in writing within three (3) calendar days
43. after delivery of the written list of required corrections that:
44. (A) some or all of the required corrections will be made; or
45. (B) Buyer waives the deficiencies; or
46. (C) an adjustment to the purchase price will be made;
47. this Purchase Agreement is canceled. Buyer and Seller shall immediately sign a *Cancellation of Purchase*
48. *Agreement* confirming said cancellation and directing all earnest money paid here to be refunded to Buyer. It is
49. understood that Buyer may unilaterally waive deficiencies or defects, or remove this contingency, providing that
50. Buyer or real estate licensee representing or assisting Buyer notifies Seller or real estate licensee representing or
51. assisting Seller of the waiver or removal, in writing, within the time specified.

52. **Real Estate Licensee's Acknowledgment**

53. Real estate licensee has informed Seller of Seller's obligations under 42 U.S.C. 4852(d) and is aware of licensee's
54. responsibility to ensure compliance.

55. **Certification of Accuracy**

56. The following parties have reviewed the information above and certify, to the best of their knowledge, that the
57. information provided by the signatory is true and accurate.

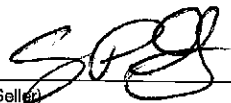
58.  3/24/26 _____
(Seller) (Date) (Buyer) (Date)

59.  3/24/26 _____
(Seller) (Date) (Buyer) (Date)

60. _____
(Real Estate Licensee) (Date) (Real Estate Licensee) (Date)

TLX:SALE-2 (8/25)

3710 60 AVE SW ROCHES X

Show search results for 3710 60...



(1 of 3)

Parcels - Composite: Land Parcel 641932067816	
FIN	067816
Floor	NA
Parcel Type	Land Parcel
Tax Year	2026
PARID	641932067816
Class	1a/4b(1) RESIDENTIAL SINGLE UNIT
City/Zip Code	010015
Plot Number	
Plot Name	
Lot	
Block	
EA/PL and	200.000
Zoom to	***

