



StandID

- Natural Pine, Upland (+/- 81.5 ac)
- Non-Timbered, Cemetery (+/- 0.2 ac)

TType Map
Woody Harrell Properties, LLC
 +/- 80 acres (Taxes)
 Sec. 11-13S/19W
 Ouachita Co., AR

— = property boundary

1 in = 660 feet
 0 330 660
 Feet

Created By: DN
 Neeley Forestry Service, Inc.
 915 Pickett St., Camden, AR 71701
 Date: 11/21/2019

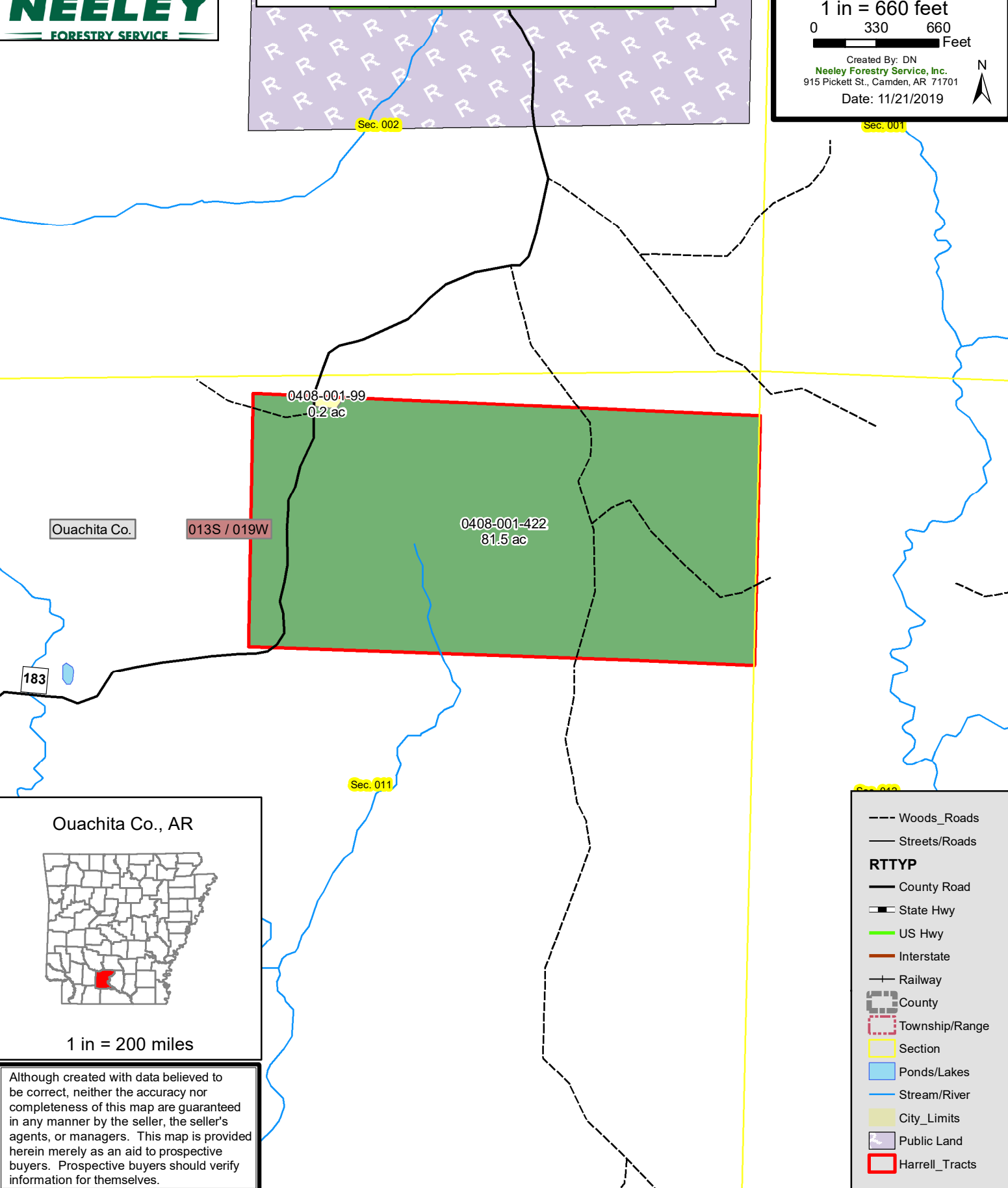

Ouachita Co.

013S / 019W

0408-001-422
81.5 ac

0408-001-99
0.2 ac

183

Sec. 011

Sec. 002

Ouachita Co., AR

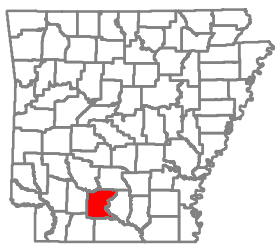

1 in = 200 miles

Although created with data believed to be correct, neither the accuracy nor completeness of this map are guaranteed in any manner by the seller, the seller's agents, or managers. This map is provided herein merely as an aid to prospective buyers. Prospective buyers should verify information for themselves.

- Woods_Roads
- Streets/Roads
- RTTYP**
- County Road
- State Hwy
- US Hwy
- Interstate
- Railway
- County
- Township/Range
- Section
- Ponds/Lakes
- Stream/River
- City_Limits
- Public Land
- Harrell_Tracts