

Copyright: NTREIS 2025 All rights reserved.

This represents an estimated sale price for this property. It is not the same as the opinion of value in an appraisal developed by a licensed appraiser under the Uniform Standards of Professional Appraisal

\$16,150



PREMIER FOUNDATION REPAIR, INC.

STRUCTURAL REPAIR CONTRACTORS

www.premierfoundationrepair.com • info@premierfoundationrepair.com  
14902 Preston Road #404-416 • Dallas TX 75254  
work 972.417.0823 • mobile 214.534.8300

CLIENT NAME / COMPANY NAME Chanh Ngo DATE 9-11-20  
ADDRESS 2700 Lake Crest Dr PHONE 469-766-6473  
CITY Flower Mound, Tx STATE Tx ZIP 75022 SOURCE shaango@hotmail.com  
E-MAIL

PREMIER FOUNDATION REPAIR, INC. agrees to furnish all labor, materials and to install the following foundation system at the above address as specified in PLAN OF REPAIR:

- Install 26 Perimeter Piers  Install \_\_\_\_\_ Interior Piers  Pier Type DynaPier & Steel  Re-shim \_\_\_\_\_  Adjust \_\_\_\_\_ Existing Piers
- Lift Perimeter / Beam(s) to Structural Tolerance  Furnish Engineering Report  City Permit  Mark Utilities  Remove / Patch Concrete for Pier Installation
- Plumbing Test (Provided Sewer Clean-outs are Available and Accessible)  Haul Off Excess Soil  Mud Jacking \$ \_\_\_\_\_ / day(s) / includes \_\_\_\_\_ yards
- Patch Exterior Brick Mortar Crack  LIFETIME TRANSFERABLE WARRANTY on New Pier Installation  Other \_\_\_\_\_

22,100<sup>00</sup>  
- 750 Coupon

COMPENSATION / TERMS OF PAYMENT / TOTAL COST OF SPECIFIED ESTIMATE \$ DynaPier 21,350<sup>00</sup> Up to 20' deep. 25<sup>00</sup> per ft. thereafter.

\* For the services rendered by the contractor, as required by this Agreement, the Client will provide compensation as follows:

50% DEPOSIT \$ 10,675<sup>00</sup> DUE AT SIGNING OF AGREEMENT / 50% BALANCE \$ 10,675<sup>00</sup> DUE ON COMPLETION

\*PLEASE NOTE: PRICE QUOTED IS GUARANTEED IF ACCEPTED WITHIN 30 DAYS OF RECEIVING ESTIMATE\*

DIAGRAM FOR PLAN OF REPAIR BASED UPON ESTIMATE: Steel Pier's 16,900 up to 20' deep. 25<sup>00</sup>/ft  
750 thereafter.  
16,150<sup>00</sup>

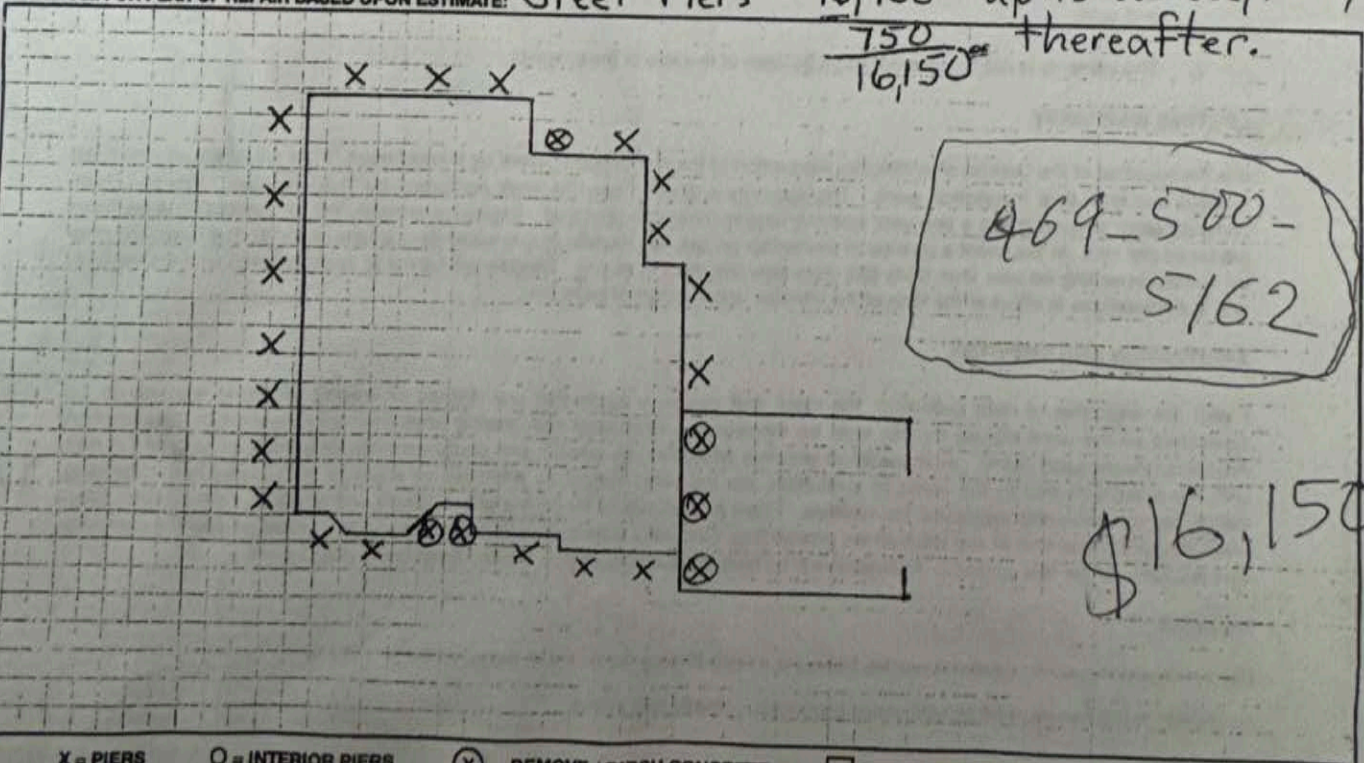

469-500-5162

\$16,150

X = PIERS    O = INTERIOR PIERS    (X) = REMOVE / PATCH CONCRETE    [X] = EXISTING PIERS    ● = ADJUST PIERS