

# Exhibit

## Boathouse Layout

Date: September 3, 2025  
Job No. 25.1761

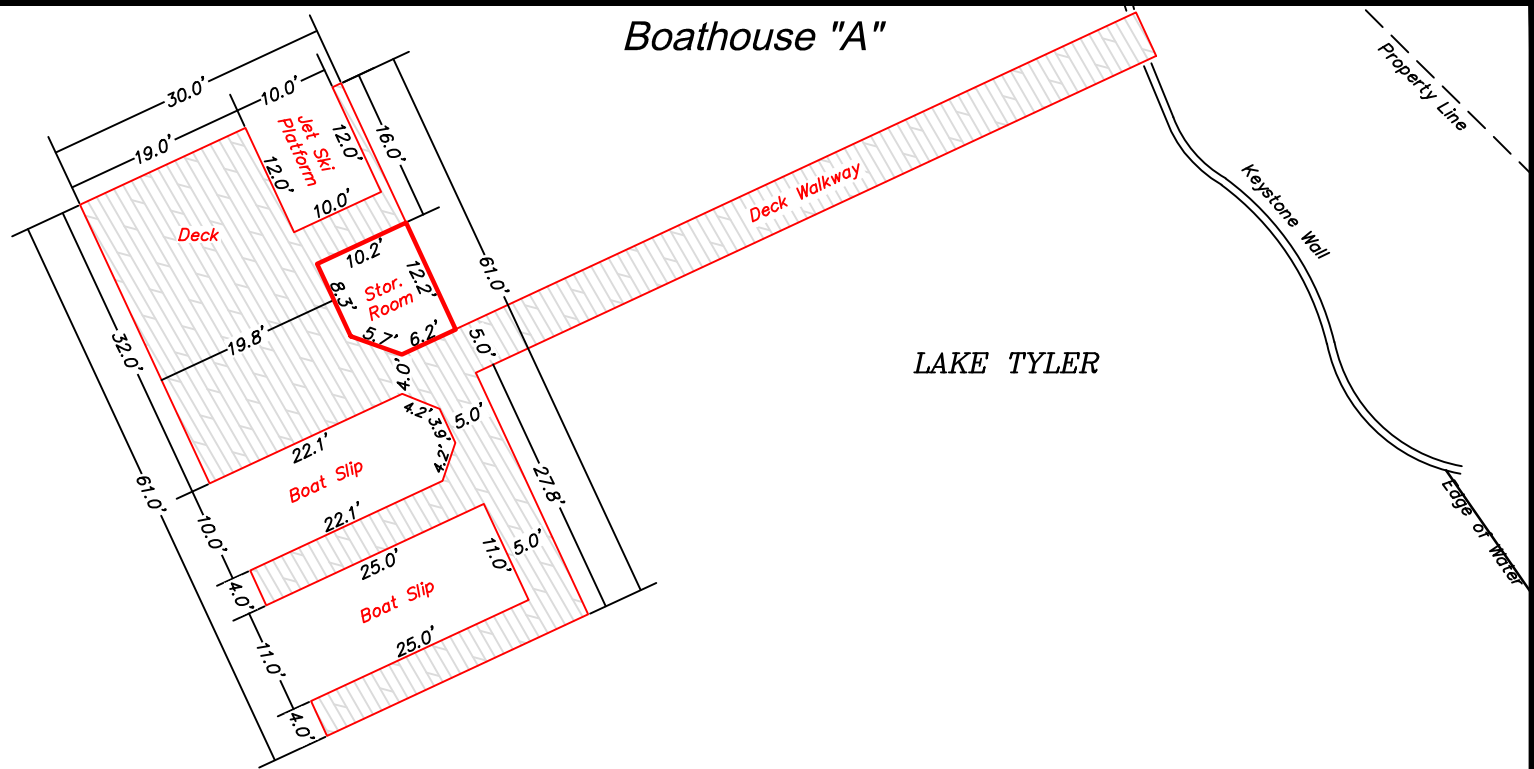

### **Boathouse "A"**

The dimensions of the current boathouse were taken from measurements as surveyed. (30 foot by 61 foot)

### **Boathouse "B"**

Boathouse was modified by excluding the jet ski platform and decking northwest of the storage room. (30 foot by 45 foot)

Drawn By: C.JZ  
Job No. 25.1761

