

Sharon K. Frazee
October 31, 1993
Volume 2573
Real Property

N00°10'34"

SET 1/2' RGR

S80°53'30"W 364.07'

COUNTY ROAD NO. 1130

JOHN H. SMITHSON HRS

CA 10' GRAVEL DPT

SET 1/2' RGR

S04°5'

GRAPHIC SCALE

1"=40'





United States of America tract
(Red River Arsenal Plant)
Volume 190, Page 259
Deed Records

96
39e 148
Records

E 353.02'

SET 1/2" RSH

261.79'

S89°43'57"E 383.56'

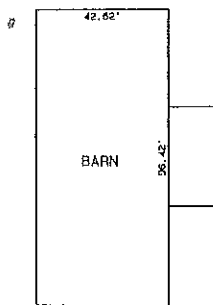

119748SQ FT
2.749ACRES

ROBERT H. HAMILTON HRS
PORTLAND
EMV

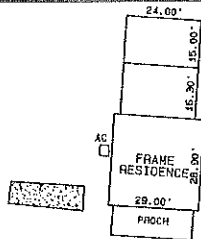

5.54" W X 2.00" H

—X—

72
in

THIS IS TO CERTIFY: that this plat and field notes correctly reflect survey made by us on the ground covering all that certain tract or part situated in the JOHN H. SMITHSON HEADRIGHT SURVEY, Abstract No. 794, County, Texas, and the ROBERT H. HAMILTON HEADRIGHT SURVEY, Abstract No. 275, Bowie County, Texas, and being a part of that certain 40 acre tract from Sam Graham, et ux, by Deed recorded in Volume 247, Pages 419-420 Deed Records of Bowie County, Texas, and being a part of a certain 5 acre tract conveyed from Jerry McEntire and H. E. Fagan to Milton Smith and wife Smith by Deed recorded in Volume 595, Page 144 of the Deed Records of Bowie County, Texas, and the herein described tract of land being more part described by metes and bounds as follows:

BEGINNING at a 1/2 inch reinforcing steel rod set for corner at an existing corner at the Northeast corner of a certain 1 acre tract conveyed to Milton Ingram by Deed dated October 31, 1996 and recorded in Volume 2573, Page 148 Property Records of Bowie County, Texas, and the said Point of beginning 89° 43' 57" W, 261.79 feet from the Northwest corner of R. H. Hamilton Survey;

THENCE: S 89° 43' 57" E, 261.79 feet with the South line of the United States tract (Red River Arsenal Plant) recorded in Volume 190, Page 148 Deed Records of Bowie County, Texas, and with the North line of said tract to the Northeast corner of the said John H. Smithson Headright Survey Northwest corner of the said Robert H. Hamilton Headright Survey, and 89° 43' 57" E, 121.77 feet for a total distance of 383.56 feet to a 1 inch steel rod found for corner at the Northwest corner of a certain tract Milton Ingram by Deed recorded in Volume 1654, Page 215 of the Real Property Records of Bowie County, Texas:

Milton
Volume
Real

THENCE: S 80° 53' 30" W. 364.07 feet with the North right-of-way line
County Road No. 1130;
THENCE: S 80° 53' 30" W. 364.07 feet with the North right-of-way line
No. 1130 to a 1/2 inch reinforcing steel rod set for corner at the So
said Frank tract;
THENCE: N 00° 10' 31" E. 353.02 feet with the East line of said Frank
POINT OF BEGINNING and containing 2.749 acres of land, more or less.

Basis of Bearings: .The North line of 5 acre tract and the South line
Red River Arsenal Plant tract.

TO THE LIENHOLDERS AND/OR THE OWNERS OF THE PREMISES SURVEYED AND
TO THE TITLE COMPANY: The undersigned does hereby certify that this
this day made on the ground of the property legally described hereon
and that any discrepancies, conflicts, shortages in area, boundary li
encroachments of improvements, apparent or visible easements or right
as shown hereon and/or described herein as best can be determined by
provided and as per on the ground survey, and that said property has
from a dedicated roadway.

According to the Federal Emergency Management Agency Flood Insurance
Map, Community Panel No. 481194 0225 B, effective date, September 27,
herein described tract of land does not appear to lie within a Specia
Area.



Wallace D.
WALLACE D. ROY
REGISTERED
LAND SURVEYOR
TEXAS NO.

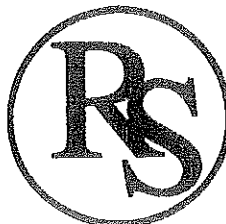

2.749 Acres
JOHN H. SMITHSON HEADRIGHT SURVEY, A
ROBERT H. HAMILTON HEADRIGHT SURVEY,
Bowie County, Texas,

SCALE: 1" = 40'

APPROVED BY:

DATE: 9-25-2008

ROY SURVEYING
4203 RICHMOND PI
TEXARKANA, TEXAS
(903-832-3451)

JOB NUMBER: 08-9-1