

Soils Map

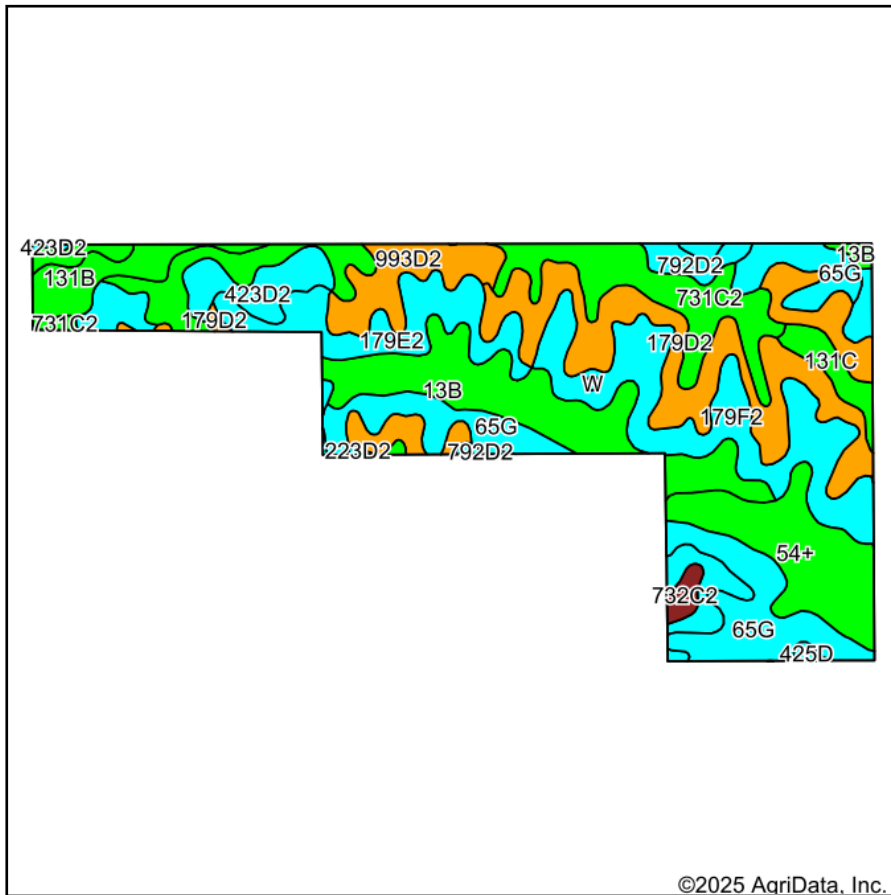

Soils data provided by USDA and NRCS.

Boundary Lines are Approximate

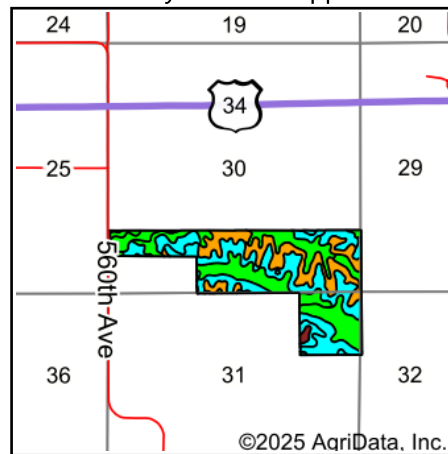

State: **Iowa**
 County: **Monroe**
 Location: **30-72N-18W**
 Township: **Guilford**
 Acres: **168**
 Date: **11/21/2025**



**Hawkeye
Real Estate**

Maps Provided By:



© AgriData, Inc. 2025

www.AgriDataInc.com



Area Symbol: IA135, Soil Area Version: 33

Code	Soil Description	Acres	Percent of field	CSR2 Legend	Non-Irr Class *c	CSR2**	CSR	*n NCCPI Corn	*n NCCPI Soybeans
179D2	Gara loam, 9 to 14 percent slopes, moderately eroded	24.67	14.6%		IVe	36	43	64	47
65G	Lindley loam, 18 to 40 percent slopes	22.24	13.2%		Vlle	6	5	21	11
179F2	Gara loam, 18 to 24 percent slopes, moderately eroded	21.57	12.8%		Vle	12	13	54	36
731C2	Pershing silty clay loam, 5 to 9 percent slopes, moderately eroded	20.71	12.3%		Ille	62	45	68	56
13B	Olmitz-Colo-Vesser complex, 2 to 5 percent slopes	19.07	11.4%		llw	82	60	70	71
54+	Zook silt loam, heavy till, 0 to 2 percent slopes, occasionally flooded, overwash	14.06	8.4%		llw	68	70	66	73
179E2	Gara loam, 14 to 18 percent slopes, moderately eroded	11.02	6.6%		Vle	26	33	62	45
993D2	Gara-Armstrong loams, 9 to 14 percent slopes, moderately eroded	9.90	5.9%		IVe	35	20	66	48
423D2	Bucknell silty clay loam, 9 to 14 percent slopes, moderately eroded	8.00	4.8%		IVe	6	13	62	48
131B	Pershing silt loam, 2 to 5 percent slopes	5.51	3.3%		Ille	70	67	74	59
424E2	Lindley-Keswick loams, 14 to 18 percent slopes, moderately eroded	3.49	2.1%		Vle	24	5	59	46
131C	Pershing silt loam, 5 to 9 percent slopes	3.19	1.9%		Ille	65	49	72	58
792D2	Armstrong loam, 9 to 14 percent slopes, moderately eroded	2.64	1.6%		IVe	9	13	62	43
732C2	Weller silty clay loam, 5 to 9 percent slopes, moderately eroded	1.22	0.7%		Ille	59	40	81	67
425D	Keswick loam, 9 to 14 percent slopes	0.39	0.2%		IVe	8	16	62	48

Soils data provided by USDA and NRCS.



Code	Soil Description	Acres	Percent of field	CSR2 Legend	Non-Irr Class *c	CSR2**	CSR	*n NCCPI Corn	*n NCCPI Soybeans	
223D2	Rinda silty clay loam, 9 to 14 percent slopes, moderately eroded	0.17	0.1%		IVe	19	9	57	43	
W	Water	0.15	0.1%			0	0			
Weighted Average						*-	39	34.6	*n 58.7	*n 47.4

**IA has updated the CSR values for each county to CSR2.

*n: The aggregation method is "Weighted Average using all components"

*c: Using Capabilities Class Dominant Condition Aggregation Method

*- Non Irr Class weighted average cannot be calculated on the current soils data due to missing data.