

### Certification

I certify that this plat represents a survey in December, 2008, by me or under my supervision from existing monuments and plats in the area and is true and correct to the best of my knowledge.

#### NOTES:

- This survey and certification is the property of the surveyor and is intended for the use and benefit of the surveyor and the clients listed.
- The certification of this survey expires ninety days from the date of the surveyor's signature for the purpose of new or revised financing.
- All iron pins set are 1/2" Rebar, unless noted otherwise.
- Only copies with surveyor's signature in red ink are valid copies.
- This research completed for this survey includes the description furnished by clients, and previous surveys by PLS #748 and PLS #1273.
- Surveyor has made no investigation or independent search for easements of record, Encumbrances, restrictive covenants, ownership, title evidence, or any other facts that an accurate and current title search may disclose.
- As a boundary survey there has not been any attempt to obtain or show any existence, location of any overhead or underground utilities or their right of way width. For any information regarding any utilities contact the appropriate agencies.

### Legal Description

The E 1/2 of the S 1/2 of the NE 1/4 of the NE 1/4 of Section 23, T-7-N, R-9-W, containing 10.14 acres, more or less. Subject to all existing easements for roads or other purposes.

ALSO a 45 foot wide easement for ingress and egress purposes, described as follows: The West 45 feet of the W 1/2 of the S 1/2 of the NE 1/4 of the NE 1/4 of Section 23, T-7-N, R-9-W.

ALSO a 25 foot wide easement for ingress and egress purposes, described as follows: The North 25 feet of the W 1/2 of the S 1/2 of the NE 1/4 of the NE 1/4 of Section 23, T-7-N, R-9-W.

### Legend

- Found Rebar
- ◆ Found State Monument
- ◆ Found Square Rod
- Found Bolt
- Set 1/2" Rebar (capped #1543)
- - - Fence Line
- - - Easement Line

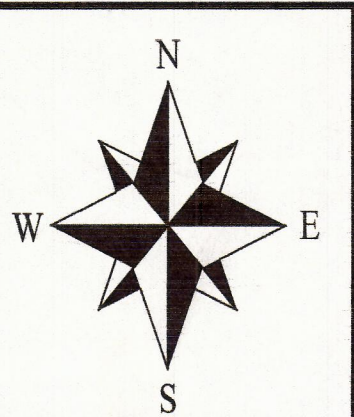
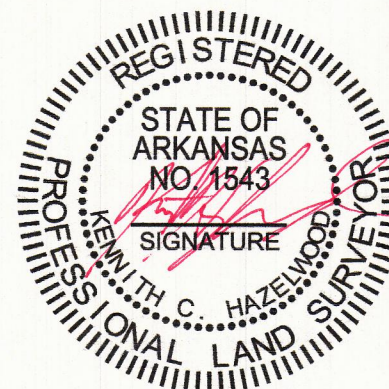
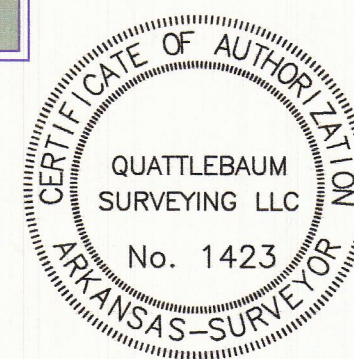

BASIS OF BEARINGS DERIVED FROM PREVIOUS SURVEY BY PLS #1273 DATED JUNE, 2000.

SURVEY CODE:  
500-07N-09W-0-23-110-73-1543

**BOUNDARY SURVEY  
FOR:  
PHILIP AND CHARLOTT  
STROUD**

No.	Revisions	Date	By
1.	Correction to typo in Legal	12/05/08	JDC
2.	Move 25' Easement to North side	12/22/08	JDC

301 EAST LINCOLN AVE.  
SEARCY, ARKANSAS 72143  
(501) 268-2174 (501) 279-3698 FAX

**QUATTLEBAUM  
SURVEYING, LLC**  
BOUNDARY • TOPO • CONSTRUCTION

DRAWN BY	DATE	APPROVED	DATE
JDC	12/22/08	KH	12/22/08
PROJECT	SCALE	SHEET	
23-7-9 Box	1" = 100'	1 of 1	