

Soils Map

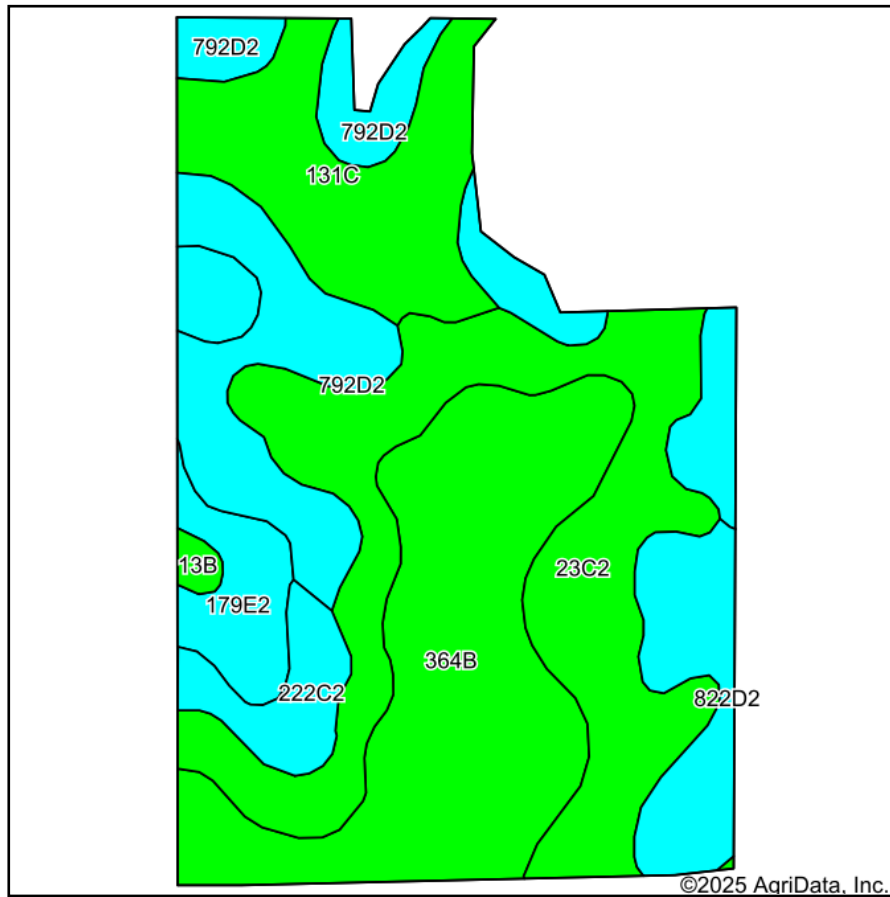

Soils data provided by USDA and NRCS.

Boundary Lines Are Approximate

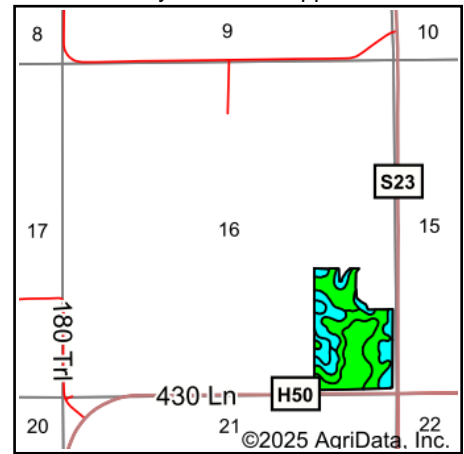

State: **Iowa**
 County: **Lucas**
 Location: **16-71N-22W**
 Township: **Warren**
 Acres: **45.26**
 Date: **7/9/2025**

Hawkeye Farm Mgmt & Real Estate



22 N Main, Albion IA Phone: 641-932-7796
 Email: hawkeye@uciowa.com
 On the web: www.uciowa.com;
 www.iowawhitetailfarms.com

Maps Provided By:



Area Symbol: IA117, Soil Area Version: 33

Code	Soil Description	Acres	Percent of field	CSR2 Legend	Non-Irr Class *c	CSR2**	CSR	*n NCCPI Corn	*n NCCPI Soybeans
23C2	Arispe silty clay loam, 5 to 9 percent slopes, moderately eroded	12.14	26.8%		IIIe	62	50	73	68
364B	Grundy silty clay loam, 2 to 5 percent slopes	11.51	25.4%		Ile	72	75	79	68
792D2	Armstrong clay loam, 9 to 14 percent slopes, moderately eroded	8.18	18.1%		IVe	5	13	58	42
131C	Pershing silt loam, 5 to 9 percent slopes	5.86	12.9%		IIIe	65	49	72	58
822D2	Lamoni silty clay loam, 9 to 14 percent slopes, moderately eroded	2.98	6.6%		IVe	10	15	63	49
179E2	Gara clay loam, 14 to 18 percent slopes, moderately eroded	2.64	5.8%		VIe	23	33	62	42
222C2	Clarinda silty clay loam, 5 to 9 percent slopes, moderately eroded	1.70	3.8%		IVw	28	25	54	42
13B	Zook-Olmitz-Vesser complex, 0 to 5 percent slopes	0.25	0.6%		IIw	68	53	70	74
Weighted Average					3.20	47.7	45.3	*n 69.7	*n 58.3

**IA has updated the CSR values for each county to CSR2.

*n: The aggregation method is "Weighted Average using all components"

*c: Using Capabilities Class Dominant Condition Aggregation Method