

Soils Map

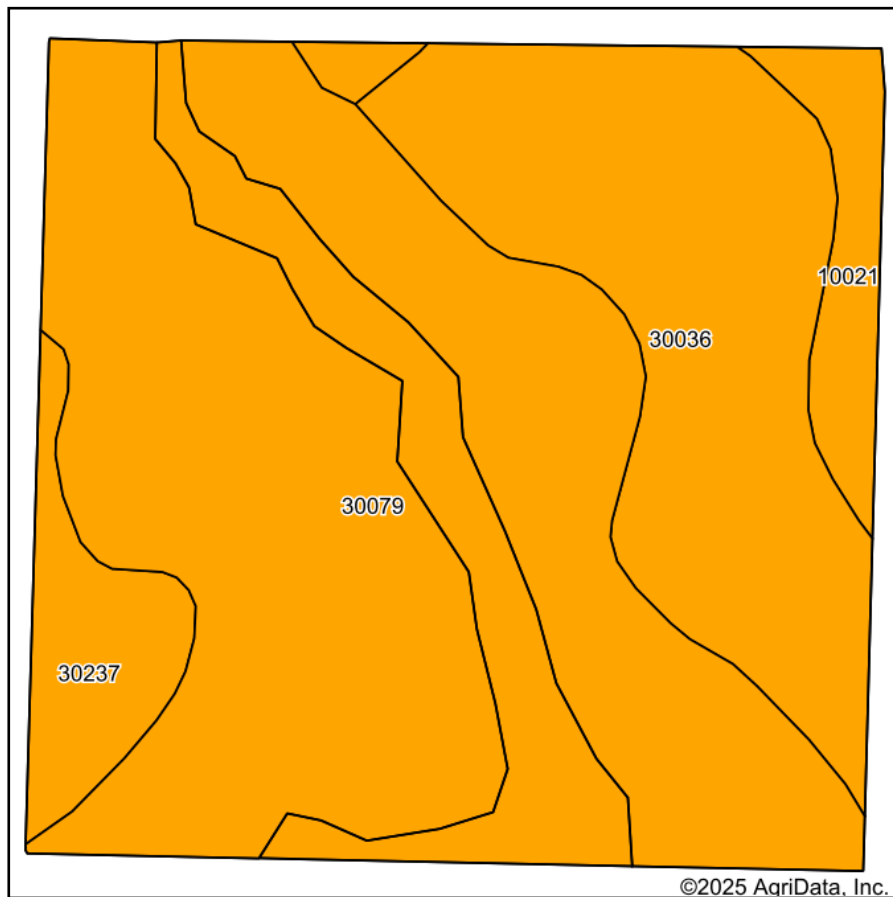

Soils data provided by USDA and NRCS.

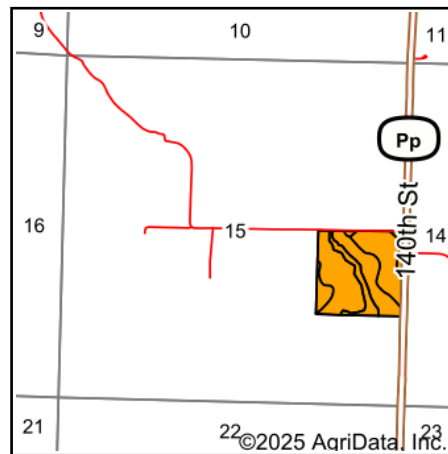

State: **Missouri**
 County: **Daviess**
 Location: **15-61N-29W**
 Township: **Benton**
 Acres: **40.03**
 Date: **3/20/2025**

United Country
 Property
 Solutions, LLC

Maps Provided By:

surety
 CUSTOMIZED ONLINE MAPPING
 © AgriData, Inc. 2023 www.AgriDataInc.com



Area Symbol: MO061, Soil Area Version: 27

Code	Soil Description	Acres	Percent of field	Non-Irr Class Legend	Non-Irr Class *c	Alfalfa hay Tons	Caucasian bluestem Tons	Common bermudagrass Tons	Orchardgrass red clover Tons	Tall fescue Tons	Warm season grasses Tons	*n NCCPI Overall	*n NCCPI Corn	*n NCCPI Soybeans
30079	Greenton silt loam, 5 to 9 percent slopes	25.42	63.5%		Ille							59	49	56
30036	Armstrong loam, 5 to 9 percent slopes	10.36	25.9%		Ille	5	7	6	7	6	7	56	52	52
30237	Greenton silty clay loam, 2 to 5 percent slopes, eroded	2.55	6.4%		Ille	5	8	7	8	7	8	61	61	51
10021	Greenton silty clay loam, 5 to 9 percent slopes, eroded	1.70	4.2%		Ille	5	8	7	8	7	8	55	55	45
Weighted Average					3.00	1.8	2.7	2.3	2.7	2.3	2.7	*n 58.2	*n 50.8	*n 54.2

*n: The aggregation method is "Weighted Average using all components"

*c: Using Capabilities Class Dominant Condition Aggregation Method

Soils data provided by USDA and NRCS.