

Soils Map

Boundary Lines Are Approximate

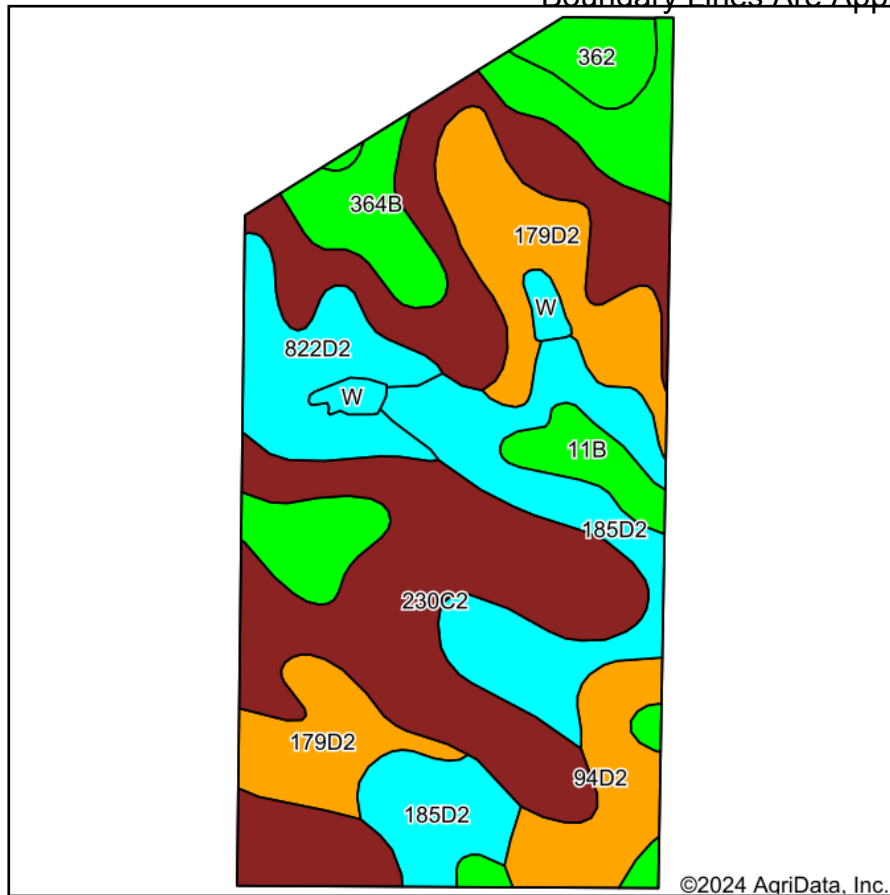

Soils data provided by USDA and NRCS.

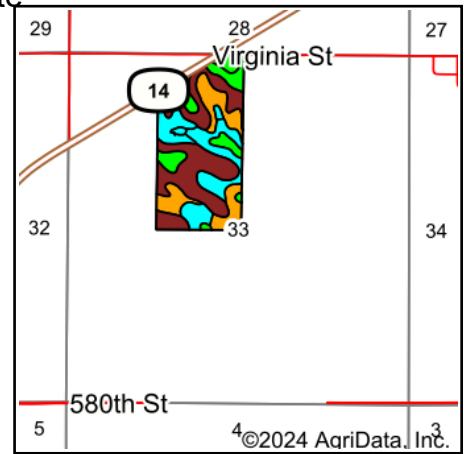

State: **Iowa**
 County: **Marion**
 Location: **33-74N-20W**
 Township: **Washington**
 Acres: **73**
 Date: **10/29/2024**

Hawkeye Farm Mgmt & Real Estate



22 N Main, Albion IA Phone: 641-932-7796
 Email: hawkeye@uciowa.com
 On the web: www.uciowa.com
 www.iowawhitetailfarms.com

Maps Provided By:



Area Symbol: IA125, Soil Area Version: 33

Code	Soil Description	Acres	Percent of field	CSR2 Legend	Non-Irr Class *c	CSR2**	CSR	*n NCCPI Corn	*n NCCPI Soybeans
230C2	Clearfield-Arispe silty clay loams, 5 to 9 percent slopes, moderately eroded	26.94	37.0%		IIIw	58	53	69	63
185D2	Bauer silt loam, 9 to 14 percent slopes, moderately eroded	12.29	16.8%		VIe	13	20	36	19
179D2	Gara loam, 9 to 14 percent slopes, moderately eroded	10.24	14.0%		IVe	38	43	66	48
364B	Grundy silty clay loam, 2 to 5 percent slopes	8.38	11.5%		Ile	72	80	79	68
822D2	Lamoni silty clay loam, 9 to 14 percent slopes, moderately eroded	5.15	7.1%		IVe	10	15	63	49
94D2	Caleb-Mystic loams, 9 to 14 percent slopes, moderately eroded	4.30	5.9%		IVe	34	35	73	53
11B	Colo-Ely silty clay loams, 2 to 5 percent slopes	2.73	3.7%		Ile	81	65	84	79
362	Haig silt loam, 0 to 2 percent slopes	2.06	2.8%		IIw	83	75	74	65
W	Water	0.91	1.2%			0	0		
Weighted Average					*-	45.3	45.8	*n 63.8	*n 52.4

**IA has updated the CSR values for each county to CSR2.

*n: The aggregation method is "Weighted Average using all components"

*c: Using Capabilities Class Dominant Condition Aggregation Method

*- Non Irr Class weighted average cannot be calculated on the current soils data due to missing data.