

Soils Map

Boundary Lines Are Approximate

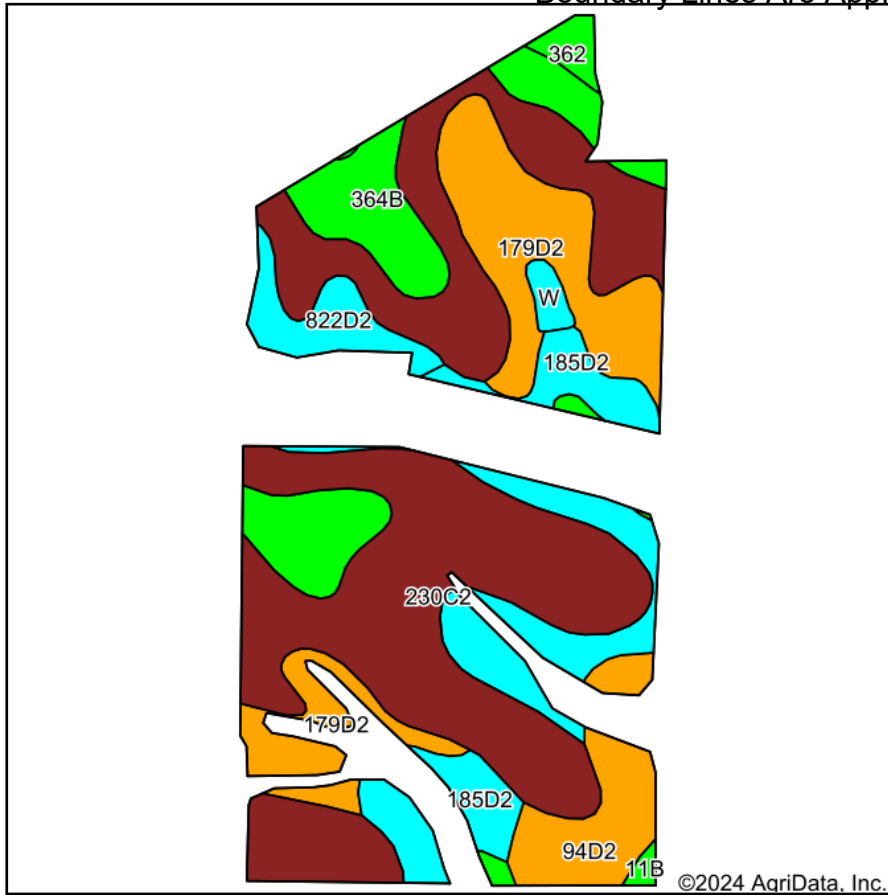

Soils data provided by USDA and NRCS.

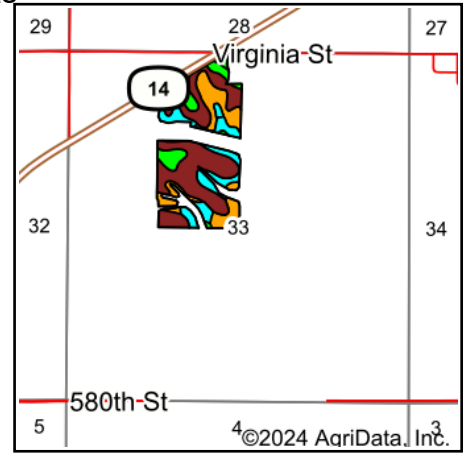

State: **Iowa**
 County: **Marion**
 Location: **33-74N-20W**
 Township: **Washington**
 Acres: **55.57**
 Date: **10/29/2024**

Hawkeye Farm Mgmt & Real Estate



22 N Main, Albion IA Phone: 641-932-7796
 Email: hawkeye@uciowa.com
 On the web: www.uciowa.com
 www.iowawhitetailfarms.com

Maps Provided By:



Area Symbol: IA125, Soil Area Version: 33

Code	Soil Description	Acres	Percent of field	CSR2 Legend	Non-Irr Class *c	CSR2**	CSR	*n NCCPI Corn	*n NCCPI Soybeans
230C2	Clearfield-Arispe silty clay loams, 5 to 9 percent slopes, moderately eroded	25.85	46.5%		IIIw	58	53	69	63
179D2	Gara loam, 9 to 14 percent slopes, moderately eroded	8.61	15.5%		IVe	38	43	66	48
185D2	Bauer silt loam, 9 to 14 percent slopes, moderately eroded	7.55	13.6%		Vle	13	20	36	19
364B	Grundy silty clay loam, 2 to 5 percent slopes	6.49	11.7%		Ile	72	80	79	68
94D2	Caleb-Mystic loams, 9 to 14 percent slopes, moderately eroded	3.40	6.1%		IVe	34	35	73	53
822D2	Lamoni silty clay loam, 9 to 14 percent slopes, moderately eroded	2.11	3.8%		IVe	10	15	63	49
362	Haig silt loam, 0 to 2 percent slopes	0.62	1.1%		IIw	83	75	74	65
11B	Colo-Ely silty clay loams, 2 to 5 percent slopes	0.48	0.9%		Ile	81	65	84	79
W	Water	0.46	0.8%			0	0		
Weighted Average					*-	47.1	47.5	*n 64.9	*n 53.8

**IA has updated the CSR values for each county to CSR2.

*n: The aggregation method is "Weighted Average using all components"

*c: Using Capabilities Class Dominant Condition Aggregation Method

*- Non Irr Class weighted average cannot be calculated on the current soils data due to missing data.

Soils data provided by USDA and NRCS.