



**TENNESSEE DEPARTMENT OF ENVIRONMENT AND CONSERVATION  
DIVISION OF WATER RESOURCES  
PERMIT FOR CONSTRUCTION OF SUBSURFACE SEWAGE DISPOSAL SYSTEM**

Issued to: Dan and Lori Melsom

Owner, Developer, Contractor, Installer, Etc.

Location:

4325 Cave Springs Rd

Columbia, TN 38401-

County: Maury

Map/Group: - Parcel: 0

Subdivision: N/A

Lot:

Evaluation Based Upon:

1. Soil Typing by Soil Scientist

a. General

b. High Intensity

c. Extra High Intensity

2. Soil Percolation Test

3. Environmental Specialist

Estimated Absorption Rate: 45 MPI

Type of System:

1. Conventional

2. Modified Conventional

3. Conventional System Substitute

Chamber

Expanded Polystyrene

Large Diameter Gravelless Pipe

Gravel backfill in a

24" wide trench \_\_\_\_\_

required?

4. Low Pressure Pipe

5. Mound

6. Lagoon

7. Subsurface Drip System

8. Other

Installation:

1. New Installation

2. Repair to Existing System

3. System Modification

Establishment:

1. Residential: # Bedrooms 4

2. Other: \_\_\_\_\_

Gal/Day 0

Approval Based Upon: State No. T.C.A. 68-221-403

(c) Percolation Test

(i) 9" buffer required (24"-36" total soil depth)

(d) Grandfather clause - Current standards except those specified

(k) Grandfather clause - meets June 30, 1990 standards (repair only)

(f) 12" (karst) and 6" (non-karst) buffer required

Current Standards

Other: \_\_\_\_\_

This system shall consist of a two compartment septic tank holding 1000 gallons, with 400 linear feet in 4 trenches, 36 inches wide and 22 (min) to 27 (max) inches deep. (Depth of gravel: 12 inches)

**General Comments:** Locate fieldlines to rear of house as shown.

Also required:

1. Soil Improvement Practice (SIP)

Curtain Drain

Drawdown Drain

Interceptor Drain

2. Flow Diversion Valve

3. Sewage Pump

Pump Flow Rate (gpm) \_\_\_\_\_

TDH (ft) \_\_\_\_\_

4. Other: \_\_\_\_\_

All installers of subsurface sewage disposal systems must hold a valid annual license from the Tennessee Department of Environment and Conservation.

Please see attached drawing and supporting documentation.

The recipient of this permit agrees to construct or have constructed the above described system in accordance with T.C.A. 68-221-401 et. seq. and The Regulations To Govern Subsurface Sewage Disposal Systems. If any part of the system is covered before inspected and approved, it shall be uncovered by the recipient of the permit at the direction of personnel of the Department of Environment and Conservation. **Any cutting, filling or alterations of the soil conditions on the aforementioned property after this day may render this approval null and void.**

By Alan Floyd

Date 09/06/2018

(Date of issue)

This is a permit to construct and is not intended to imply approval of any work proposed or completed on this lot.

Point

Dup Alert

100'  
100'  
100'  
100'

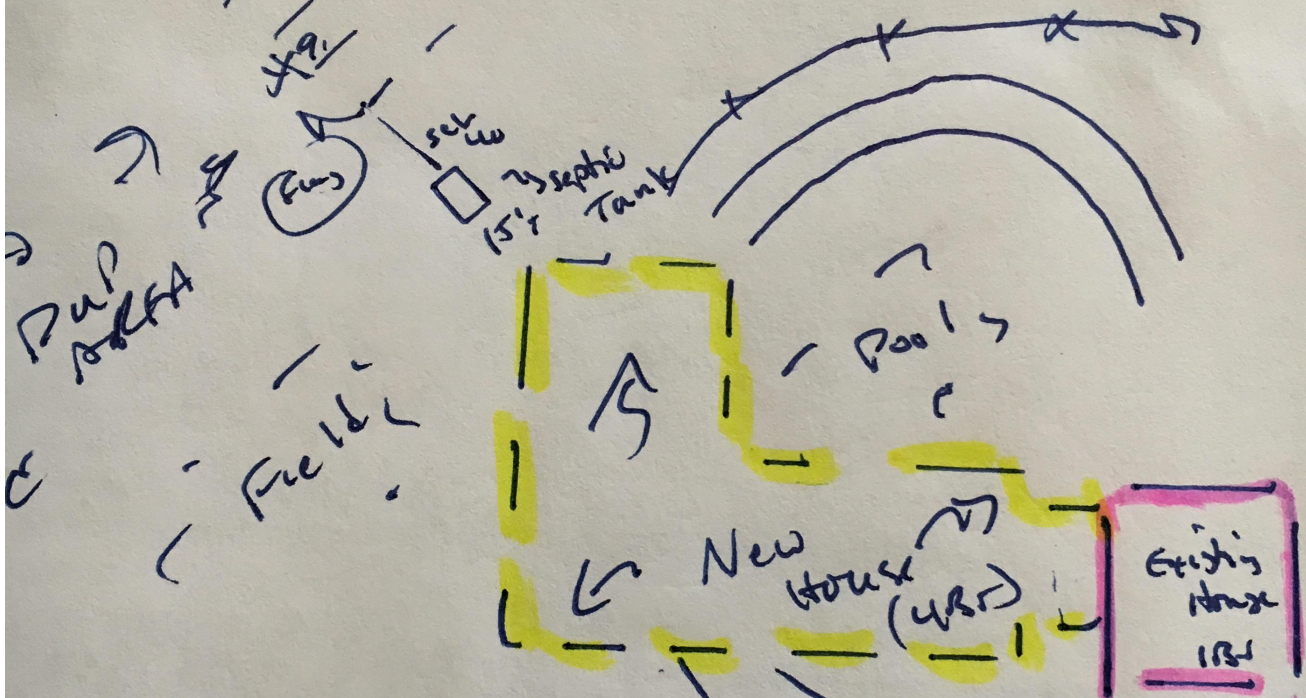

\* Locate this to rear of new house  
 @ orange flag as shown.  
 \* keep ST 15' off basement ent.

\* keep well 50' of septic tank and field lines

\* well water  
 \* No close L's

Cave Springs Rd



System Plan Review .....	\$ _____	780
System Plan Review* .....	\$ _____	780
Plan Review* .....	\$ _____	780
on: Lots: _____ *	\$ _____	780
oe(s) _____ *	\$ _____	780
.....	\$ _____	780
Disposal Site Permit.....	\$ _____	780

requests with a staff member prior to processing application.

elson                      **APPLICANT**                      **ORIGINAL OWNER**  
 Names: \_\_\_\_\_                      Name: Thomas  
 Address: same \_\_\_\_\_  
Spring Rd \_\_\_\_\_  
38401 \_\_\_\_\_  
67 \_\_\_\_\_                      Day Phone: \_\_\_\_\_

a) in a subdivision? \_\_\_\_\_ b) Name: \_\_\_\_\_  
 Specific directions and address to the lot or site Hwy 7 → Leipers Creek, +. rt  
 Parcel \_\_\_\_\_

Size of lot \_\_\_\_\_ b) Number of Bedrooms 4  
 Excavated Basement? Yes  No \_\_\_\_\_

es  No \_\_\_\_\_  
 gallons) \_\_\_\_\_ Email lori@medexperts.org  
 Well \_\_\_\_\_ Spring \_\_\_\_\_

If not, date it will be staked: \_\_\_\_\_  
 If not, date it will be staked: \_\_\_\_\_

LY: Will pick up \_\_\_\_\_ Please mail \_\_\_\_\_  
 b) Is house vacant? \_\_\_\_\_ How long? \_\_\_\_\_

Inspected \_\_\_\_\_  
 plumbing fixtures? \_\_\_\_\_ Surfacing on the ground? \_\_\_\_\_  
 machines routed into septic tank \_\_\_\_\_

c) Source of Supply: Spring \_\_\_\_\_ Well \_\_\_\_\_  
 c) Is the source chlorinated? \_\_\_\_\_  
 the ground? \_\_\_\_\_ Is a sanitary seal on the casing? \_\_\_\_\_

CK OF THIS **WHITE** PAGE SHOWING DIRECTIONS TO PROPERTY, PROPERTY LIN  
 TION, PLANNED DRIVEWAY AND UTILITIES.

D ARE NON-REFUNDABLE (except upon appeal). See Fee Schedule on reverse.  
**CR, STATE OF TENNESSE.**

true and correct to the best of my knowledge; **I have been authorized by the above named I**  
 he Division of Water Resources.

Lori Nelson                      AMOUNT PAID: \$ 500.00                      RECEIPT NUM