

As of: 3/7/2019

Property Owner**Name:** EVANS, EVELYN**Property Information****Physical Address:** 428 HWY 62 E**Mailing Address:** PO BOX 568
YELLVILLE, AR 72687**Subdivision:****Block / Lot:** N/A / N/A**Type:** (RI) Res. Improv.**S-T-R:** 04-18-16**Tax Dist:** (4Y) Yellville-Summit SD**Size (Acres):** 2.680**Millage Rate:** 51.88

Extended Legal: SE SE BEG AT PT TH IS 1514'E QTR SEC COR TH GO E163' AL N R/W HWY 62 TO SW COR OLSEN PROP GO N AL W BNDRY OLSEN TRACT TO PT IN LN W/N EDGE CONCRETE WALL W/CHAIN LINK FENCE; TH LEAVE OLSEN PROP GO W AL N EDGE SD CONCRETE WALL TO PT OF DEFLECTION IN WALL TO SW TH FOLLOW N EDGE OF WALL IN A SOUTHWESTERLY DIR TO PT IN CTR CONCRETE SPILLWAY TH S AL CTR SD CONCRETE TO POB ALSO SE SE MPDA FROM QTR SEC COR SEC 4/9 S87*E1285.38' TH N00* E212.61' TH N85*E33'TH N00*W95' TO POB TH N06*W121.07' TO PT AT BASE ROCK WALL TH AL SD ROCK WALL N81*E427.04' S04*W232.54' TO PT EDGE OF CONCRETE WALL W/CHAIN LINK TH GO AL SD CONCRETE WALL N84*W159.82' S64*W28.77' TH GO AL CONCRETE WALL N41*W29.48' S87*W 98.38' S86*W15' TH N02*E16.91' TH N82*W 71' TO POB CONTAINING .02 ACRES IN SW SE AND 1.66 ACRES IN SE SE FOR AGGREGATE OF 1.68 ACRES

Market and Assessed Values**Taxes**

	Estimated Market Value	Full Assessed (20% Mkt Value)	Taxable Value	Estimated Taxes:	\$1,201
Land:	\$24,700	\$4,940	\$4,940	Homestead Credit:	\$350
Building:	132200	26440	18210	Note: Tax amounts are estimates only. Contact the county/parish tax collector for exact amounts.	
Total:	\$156,900	\$31,380	\$23,150		

Land

Land Use	Size	Units
Homesite	1	Acres
Homesite	1	Acres
Homesite	0.68	Acres
Total	2.680	

Deed Transfers

Deed Date	Book	Page	Deed Type	Stamps	Est. Sale	Grantee	Code	Type
12/29/2016	2017	ADVR	ADVR	0.00	\$0	DECEASED	N/A	Improve d
1/15/1993	389	28	N/A	0.00	\$65,000	EVANS	N/A	N/A
7/31/1992	384	46	N/A	0.00	\$70,000	GUARDIAN DEED	N/A	N/A
1/1/1980	389	29	N/A	0.00	\$0	S/36 RECORD	N/A	N/A

Not a Legal Document.

Subject to terms and conditions.

www.actDataScout.com

Reappraisal Value History

Tax Year	Total Value	Total Assessed
2015	\$196,850.00	\$23,150.00
2016	\$156,900.00	\$23,150.00
2017	\$156,900.00	\$23,150.00
2018	\$156,900.00	\$23,150.00

As of: 3/7/2019

Details for Residential Card 1

Occupancy	Story	Construction	Total Liv	Grade	Year Built	Age	Condition	Beds
Single Family	ONE	N/A	1,792	4		22	N/A	

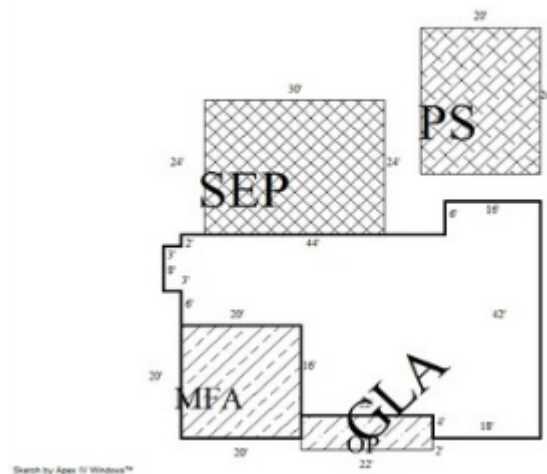
Exterior Wall: Masonary**Foundation:** Closed Piers**Floor Struct:** Wood with subfloor**Floor Cover:** Carpet & Tile**Insulation:** Ceilings Floors Walls**Roof Cover:** Fiberglass Shingle**Roof Type:** Hip**Plumbing:** Full: 2 Half: 1**Fireplace:** Type: 1sg Qty: 1**Heat / Cool:** Central**Basement:** FinPart**Basement Area:** 1500**Year Remodeled:****Style:**

Outbuildings and Yard Improvements

Item	Type	Size/Dim	Unit Multi.	Quality	Age
Garage - masonry finished, att		400			
Porch, open		132			
Patio slab		520			
Porch, screen enclosed		720			
Driveway, concrete		3000			22
Fence, chain link 4'	NV	160			
MT STG		1			
Wall, masonry (brick or stone)		740			22

Map



Map unavailable
for this parcel.