

Original upload for Registry: 55-239856

Record updated:

10/23/2023

--- The document starts on the next page. ---

Run Date: 10/23/2023

AZ DEPARTMENT OF WATER RESOURCES

WELL REGISTRY REPORT - WELLS55

Location B 5.0 13.0 23 D A A Well Reg.No 55 - 239856 AMA NOT WITHIN ANY AMA OR INA

Registered Name BBJ RANCHES LLC
 22294 NW HOLSEY ACRES RD.
 INDIAHOMA OK 73552
 File Type NEW WELLS (INTENTS OR APPLICATIONS)
 Application/Issue Date 10/10/2023

Owner OWNER Well Type EXEMPT
 Driller No. 374 SubBasin MCMULLEN VALLEY
 Driller Name Q MOUNTAIN DRILLING Watershed LOWER GILA RIVER
 Driller Phone 928-851-2537 Registered Water Uses DOMESTIC
 County LA PAZ Registered Well Uses WATER PRODUCTION
 Parcel No. 304-72-017Y Discharge Method NO DISCHARGE METHOD LISTED
 Intended Capacity GPM 25.00 Power NO POWER CODE LISTED

Well Depth 0.00 Case Diam 0.00 Tested Cap 0.00
 Pump Cap. 0.00 Case Depth 0.00 CRT
 Draw Down 0.00 Water Level 0.00 Log
 Acres Irrig 0.00 Finish NO CASING CODE LISTED

Contamination Site: YES - FUDS IDENTIFIED BY DEQ, DETAILS PENDING

Tribe: Not in a tribal zone

Comments

Places Of Use

B 5.0 13.0 23 D A A



55-239856

Current Action

10/16/2023 555 DRILLER & OWNER PACKETS MAILED
 Action Comment: ajf

Action History

10/16/2023 550 DRILLING AUTHORITY ISSUED
 Action Comment: ajf
 10/10/2023 150 NOI RECEIVED FOR A NEW PRODUCTION WELL
 Action Comment: rtn

ARIZONA DEPARTMENT OF WATER RESOURCES
1110 W. Washington St. Suite 310
Phoenix, Arizona 85007

ANY DEVIATION IN WELL LOCATION FROM THE PLOT PLAN APPROVED FROM THE COUNTY OR LOCAL HEALTH AUTHORITY MUST BE RE-SUBMITTED FOR APPROVAL

NOTICE! This well is located in or near an area of groundwater contamination (WQARF/CERCLA/DOD or Other). Be advised that special requirements may apply.

THIS AUTHORIZATION SHALL BE IN POSSESSION OF THE DRILLER DURING ALL DRILLING OPERATIONS

WELL REGISTRATION NO: 55-239856

AUTHORIZED DRILLER: Q MOUNTAIN DRILLING

LICENSE NO: 374

NOTICE OF INTENTION TO DRILL EXEMPT WELL(S) HAS BEEN FILED WITH THE DEPARTMENT BY:

WELL OWNER: BBJ RANCHES LLC 22294 NW HOLSEY ACRES RD. INDIAHOMA, OK, 73552

THE WELL(S) IS/ARE TO BE LOCATED IN THE:

NE 1/4 of the NE 1/4 of the SE 1/4 Section 23 Township 5.0 NORTH Range 13.0 WEST

NO. OF WELLS IN THIS PROJECT: 1

ASSESSOR'S PARCEL NO: 304-72-017Y

THIS AUTHORIZATION EXPIRES AT MIDNIGHT ON THE DAY OF October 11, 2024

Suzanne Muriello

GROUNDWATER PERMITTING AND WELLS

THE DRILLER MUST FILE A LOG OF THE WELL WITHIN 30 DAYS OF COMPLETION OF DRILLING.

NOTICE! The Authorization to drill this well DOES NOT constitute or guarantee an approval to use the well for the purpose of withdrawing groundwater for transportation to an Active Management Area (AMA) pursuant to A.R.S. § 45-552, 45-553, 45-554 or 45-555(A) without official prior approval from the Department.



ARIZONA DEPARTMENT of WATER RESOURCES
1110 W. Washington St. Suite 310
Phoenix, AZ 85007
602-771-8500
azwater.gov



October 16, 2023

BBJ RANCHES LLC
22294 NW HOLSEY ACRES RD.
INDIAHOMA, OK 73552

Registration No. 55- 239856
File Number: B(5-13) 23 DAA

KATIE M. HOBBS
Governor

THOMAS BUSCHATZKE
Director

Dear Well Applicant:

Enclosed is a copy of the Notice of Intention to Drill (NOI) a well which you or your driller recently filed with the Department of Water Resources. This letter is to inform you that the Department has approved the NOI and has mailed, or made available for download, a drilling authorization card to your designated well drilling contractor. The driller may not begin drilling until he/she has received the authorization, and must keep it in their possession at the well site during drilling. Although the issuance of this drill card authorizes you to drill the proposed well under state law, the drilling of the well may be subject to restrictions or regulations imposed by other entities.

Well drilling activities must be completed within one year after the date the NOI was filed with the Department. If drilling is not completed within one year, a new NOI must be filed and authorization from this Department received before proceeding with drilling. If the well cannot be successfully completed as initially intended (dry hole, cave in, lost tools, etc.), the well must be properly abandoned and a Well Abandonment Completion Report must be filed by your driller [as required by A.A.C. R12-15-816(F)].

If you change drillers, you must notify the Department of the new driller's identity on a Request to Change Well Drilling Contractor (form 55-71B). Please ensure that the new driller is licensed by the Department to drill the type of well you require. A new driller may not begin drilling until he/she receives a new drilling authorization card from the Department. Forms may be obtained by contacting the Department, or online at: <https://new.azwater.gov/permitting-wells/well-forms-and-applications>.

If you find it necessary to change the location of the proposed well(s), you may not proceed with drilling until you file an amended NOI with the Department. An amended drilling authorization card will then be issued to the well drilling contractor, which must be in their possession before drilling begins.

Arizona statute [A.R.S. § 45-600] requires registered well owners to file a Pump Installation Completion Report (form 55-56) with the Department within 30 days after the installation of pumping equipment, if authorized. A blank report is enclosed for your convenience. State statute also requires the driller to file a complete and accurate Well Drillers Report and Well Log (form 55-55) within 30 days after completion of drilling. A blank report form was provided to your driller with the drilling authorization card. You should insist and ensure that all of the required reports are accurately completed and timely filed with the Department.

Please be advised that Arizona statute [A.R.S. § 45-593(C)] requires a registered well owner to notify the Department of a change in ownership of the well and/or information pertaining to the physical characteristics of the well in order to keep this well registration file current and accurate. Any change in well information must be filed on a Request to Change Well Information form (form 55-71A). Forms may be obtained by contacting the Department, or online at: <https://new.azwater.gov/permitting-wells/well-forms-and-applications>.

Sincerely,

Alicia Flores

Groundwater Permitting and Wells Section

ARIZONA DEPARTMENT of WATER RESOURCES
1110 W. Washington St. Suite 310
Phoenix, AZ 85007
602-771-8500
azwater.gov



KATIE M. HOBBS
Governor

THOMAS BUSCHATZKE
Director

10/16/2023

Registration No. 55- 239856
File Number: B(5-13) 23 DAA

Attn Well Owner and Well Driller:

The Department of Water Resources has approved the Notice of Intent (NOI) to drill your well(s) that you recently submitted. The proposed well(s) is/are located in or near an area of known groundwater contamination referred to as a remedial action site, as shown on the enclosed map. Please be aware that groundwater produced from the proposed well(s) may not meet applicable federal, state, county or local water quality standards.

If your NOI was filed using paper forms, the drilling authorization for your well(s) was granted based on a determination that the proposed well design indicated on the NOI complies with the Department's minimum well construction standards and any special well construction standards that prevent the spread of existing groundwater contamination or other special aquifer conditions.

If your NOI was filed using the electronic (e-NOI) system, the drilling authorization for your well(s) was based on your driller's certification that your well(s) shall be constructed in compliance with the Department's minimum well construction standards and any special well construction requirements that prevent the spread of existing groundwater contamination or other special aquifer conditions.

You are required to construct the well(s) as shown in the proposed design, unless the Department has approved a modification to the proposed design. A request to modify the proposed design must be submitted in writing to the Department for approval.

Mailing Address:
Arizona Department of Water Resources
Groundwater Permitting and Well Section
1110 W. Washington St. Suite 310 * Phoenix, Arizona 85007

Facsimile Number:
602-771-8681

If you have any questions, please contact us at (602) 771-8527

Proposed Domestic Well 55-239856 - Laguna Maneuver Area FUDS

2 messages

Alicia Flores <aflores@azwater.gov>

Mon, Oct 16, 2023 at 8:39 AM

To: Karin Harker <harker.karin@azdeq.gov>, Natalie Romanoff <romanoff.natalie@azdeq.gov>

Cc: Jerry Helton <helton.jerry@azdeq.gov>, harry.r.hendler@usace.army.mil

Bcc: Melissa Lopez <mlopez@azwater.gov>

Hello,

We received an NOI to drill a domestic well for BBJ Ranches LLC.
The proposed well, 55-239856, will be located within the Laguna Maneuver Area FUDS site.
Please see location map and NOI application attached.

Let me know if you have any comments or concerns.

Sincerely,

--

Alicia Flores

Groundwater Permitting and Wells
Arizona Department of Water Resources
602-771-8534



PROTECTING ARIZONA'S
WATER SUPPLIES
for ITS NEXT CENTURY

2 attachments

 **55-239856.pdf**
1702K

 **55-239856 Map.pdf**
1230K

Natalie Romanoff <romanoff.natalie@azdeq.gov>

Mon, Oct 23, 2023 at 2:01 PM

To: Alicia Flores <aflores@azwater.gov>

Cc: Karin Harker <harker.karin@azdeq.gov>, Jerry Helton <helton.jerry@azdeq.gov>, harry.r.hendler@usace.army.mil

Well #55-239856 in Salome, AZ is located **outside** the Interim Risk Management (IRM) area for Laguna Maneuver Area 5 Munitions Response Site (MRS) 03 - South Maneuver Area.

Even though this parcel is outside the IRM, it is still within the Formerly Used Defense Sites (FUDS) MRS footprint. If an unknown item is discovered, please follow the 3Rs:

- Recognize — when you may have encountered a munition, and that munitions are dangerous.
- Retreat — do not approach, touch, move or disturb a munition, but carefully leave the area.
- Report — call 911 and advise the police of what you saw and where you saw it.

For additional information please contact the U.S. Army Corps of Engineers FUDS Site Program Manager:

Harry Hendler

213.819.6510

Harry.R.Hendler@usace.army.mil



**Proposed Domestic
Well #55-239856
BBJ Ranches LLC
La Paz, AZ**

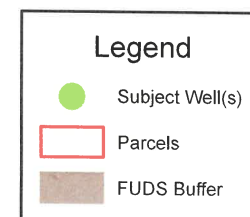

Maxar



Arizona Department of Water Resources
Groundwater Permitting and Wells Section
1802 W Jackson St. Box 79, Phoenix, AZ 85007
(602) 771-8527 • www.azwater.gov

RECEIVED

OCT 10 2023

\$150 or \$100 FEE

Notice of Intention to

Drill, Deepen, Replace or Modify a Well

(except a Non-Exempt Well in an Active Management Area)

- Review instructions prior to completing form in black or blue ink.
- You must include with your Notice:
 - Check or money order in the amount of the appropriate filing fee.
 - For a well located within an AMA or INA, the fee is \$150.00.
 - For a well not located within an AMA or INA, the fee is \$100.00 if the well will be used solely for domestic purposes (see page 2 and instructions) and will have a pump with a maximum capacity of not more than 35 gallons per minute. Otherwise, the fee is \$150.00.
- Shared wells: While Arizona water law governs how a well subject to a well sharing agreement is to be drilled and located, it DOES NOT govern the operation or management of a well sharing agreement.
- Authority for fee: A.R.S. § 45-596 and A.A.C. R12-15-104.

TO BE COMPLETED BY ADWR		FILE NUMBER
AMA/INA	B	SB
MMU	50	B(5-13)230AA
RECEIVED DATE	WS	WELL REGISTRATION NUMBER
10/10/23	15	55 - 239856
ISSUED DATE	REMEDIAL ACTION SITE	
10/16/23	449	
LEGAL REVIEW IF APP	REASONING	
<input checked="" type="checkbox"/> FILING MANUALLY		
<input type="checkbox"/> FILING ELECTRONICALLY (driller's email required)		

SECTION 1. COUNTY OR LOCAL HEALTH AUTHORITY APPROVAL (if applicable)

If water from the proposed well will be used for domestic purposes on a parcel of land of 5 or fewer acres, the applicable county or local health authority must endorse all items in Section 1 within one year before submission to the Department of Water Resources. You must also attach a site plan (pg. 3).

CHECK ONE

County or Local Health Authority Recommends Approval (pursuant to A.R.S. § 45-596 (G) and (F))

Field Inspection Performed

Site Plan Review Only

Insufficient Information to Make a Determination – If checked, please submit supplemental form 55-40C. A.R.S. § 45-596 (G) and (F)

COUNTY OR LOCAL AUTHORITY NAME AND TITLE

TELEPHONE NUMBER

DATE

Official County or Local Seal or Stamp

COUNTY OR LOCAL AUTHORITY SIGNATURE

SECTION 2. REGISTRY INFORMATION

To determine the place of water use and location of well, please refer to the Well Registry Maps and Google Earth at: (<https://azwatermaps.azwater.gov/wellreg>) and (<http://www.earthpoint.us/townships.aspx>)

Well Type	Proposed Action	Location of Well
CHECK ONE	CHECK ONE	WELL LOCATION ADDRESS (IF ANY)
<input checked="" type="checkbox"/> Exempt (Pump has a maximum capacity of not more than 35 gpm and water is not used for irrigation purposes inside an AMA.) (See instructions)	<input checked="" type="checkbox"/> Drill New Well	67992 65 1/2 St.
<input type="checkbox"/> Non-Exempt (Pump has a maximum capacity of more than 35 gpm and the well is located outside an AMA.) (See instructions)	<input type="checkbox"/> Deepen	TOWNSHIP (NS) RANGE (EW) SECTION
	<input type="checkbox"/> Replace	5N 13W 23
	<input type="checkbox"/> Modify	160 ACRE 40 ACRE 10 ACRE
	If Deepening, Replacing or Modifying:	NE 1/4 NE 1/4 SE 1/4
	ORIGINAL WELL REGISTRATION NUMBER	COUNTY ASSESSOR'S PARCEL ID NUMBER
	55 -	BOOK MAP PARCEL # OF ACRES
	MAXIMUM CAPACITY OF ORIGINAL WELL	304 72 0174 9.60
	Gallons Per Minute	EXPECTED LATITUDE EXPECTED LONGITUDE
DESIGN PUMP CAPACITY	DISTANCE & DIRECTION FROM ORIGINAL WELL	33° 45' 684" N 113° 34' 614" W
25 Gallons Per Minute	Feet	Place of Water Use (Mandatory information, see instructions)
		Is the groundwater basin where the well will be drilled the same as the place where the water will be used?
		Yes No
		<input checked="" type="checkbox"/> <input type="checkbox"/>
		TOWNSHIP (NS) RANGE (EW) SECTION 160 ACRE 40 ACRE 10 ACRE
		5N 13W 23 NE 1/4 NE 1/4 SE 1/4

SECTION 3. OWNER INFORMATION

Land Owner	Well Owner (check this box if Land Owner and Well Owner are same <input checked="" type="checkbox"/>)
FULL NAME OF COMPANY, ORGANIZATION, OR INDIVIDUAL	FULL NAME OF COMPANY, GOVERNMENT AGENCY, OR INDIVIDUAL
BBJ Ranches LLC	
MAILING ADDRESS	MAILING ADDRESS
22794 NW Holsey Acres Rd.	
CITY / STATE / ZIP CODE	CITY / STATE / ZIP CODE
Indiahoma Ok 73552	
CONTACT PERSON NAME AND TITLE	CONTACT PERSON NAME AND TITLE
Bobby Payne / owner	
TELEPHONE NUMBER	TELEPHONE NUMBER
580 585 2523	
EMAIL	EMAIL
bobbypayne65@gmail.com	

RTN

Notice of Intent to Drill, Deepen, Replace or Modify a Well

WELL REGISTRATION NUMBER
55 - 239856

SECTION 4.			
Questions	Yes	No	If Yes:
1. Is the proposed well site within 100 feet of a septic tank system, sewer disposal area, landfill, hazardous materials or petroleum storage area or tank?	<input type="checkbox"/>	<input checked="" type="checkbox"/>	You must also request a variance (A.A.C. R12-15-818).
2. Is there another well name or identification number associated with this well (e.g., Lot 35 Well, Smith Well, etc.)?	<input type="checkbox"/>	<input checked="" type="checkbox"/>	(please state)
3. Is the proposed well a NEW well to be located within an Active Management Area? (See instructions)	<input type="checkbox"/>	<input checked="" type="checkbox"/>	You must also file a supplemental form 55-40A, unless the well is a replacement well and the total number of operable exempt wells on the land is not increasing. A.R.S. § 45-454(C) & (D)
4. Is the proposed well the second exempt well on this parcel for the same use?	<input type="checkbox"/>	<input checked="" type="checkbox"/>	You must also file a supplemental form 55-40B, if the proposed well is in an Active Management Area. A.R.S. § 45-454(I)

SECTION 5. DRILLING AUTHORIZATION

Drilling Firm

NAME *Q Mountain Drilling*

DWR LICENSE NUMBER *374* ROC LICENSE CATEGORY *R53-A4*

TELEPHONE NUMBER _____ FAX NUMBER _____

MAILING ADDRESS *P.O. Box 491*

CITY / STATE / ZIP CODE *Salome Ariz. 85348*

DRILLERS EMAIL _____

DATE CONSTRUCTION IS SCHEDULED TO BEGIN *10/23*

SECTION 6. WATER / SITE INFORMATION

Principal Use of Water	Other Uses of Water
CHECK ONE	CHECK ALL THAT APPLY
<input type="checkbox"/> Irrigation*	<input type="checkbox"/> Irrigation
<input checked="" type="checkbox"/> Commercial	<input checked="" type="checkbox"/> Commercial
<input checked="" type="checkbox"/> Domestic <i>per owner sym</i>	<input checked="" type="checkbox"/> Domestic
<input type="checkbox"/> Municipal	<input type="checkbox"/> Municipal Reset Other Water Uses
<input type="checkbox"/> Industrial	<input type="checkbox"/> Industrial
<input type="checkbox"/> Stock	<input type="checkbox"/> Stock
<input type="checkbox"/> Remediation	<input type="checkbox"/> Remediation
<input type="checkbox"/> Dewatering	<input type="checkbox"/> Dewatering
<input type="checkbox"/> Other (please specify):	<input type="checkbox"/> Other (please specify):

*Pursuant to ARS § 45-402(23) Irrigation is defined as applying water to two or more acres of land to produce plants or parts of plants for sale or human consumption, or for use as feed for livestock, range livestock or poultry.

NOTE: If this is a Notice of Intent to construct a new well that will be used for the purpose of withdrawing groundwater for transportation to an Active Management Area (AMA) pursuant to A.R.S. § 45-552, 45-553, 45-554 or 45-555(A), the authorization to drill the well issued in association with this Notice shall not be considered the approval to transport groundwater to an AMA. (See instructions)

SECTION 7. PROPOSED WELL CONSTRUCTION DESIGN (attach separate sheet if needed)

Borehole			Casing														
DEPTH FROM SURFACE		BOREHOLE DIAMETER (inches)	DEPTH FROM SURFACE		OUTER DIAMETER (inches)	MATERIAL TYPE (T)				PERFORATION TYPE (T)					GROUTING MATERIAL		
FROM (feet)	TO (feet)		FROM (feet)	TO (feet)		STEEL	PVC	ABS	IF OTHER TYPE, DESCRIBE	BLANK OR NONE	WIRE WRAP	SHUTTER SCREEN	MILLS KNIFE	SLOTTED		IF OTHER TYPE, DESCRIBE	
<i>0'</i>	<i>20'</i>	<i>13.5"</i>	<i>0'</i>	<i>20'</i>	<i>8.5"</i>	<input checked="" type="checkbox"/>											CEMENT
<i>20'</i>	<i>250'</i>	<i>7"</i>	<i>0'</i>	<i>190'</i>	<i>4.95"</i>		<input checked="" type="checkbox"/>										
			<i>190'</i>	<i>250'</i>	<i>4.95"</i>												

* ADWR well construction standards require a surface seal consisting of a minimum of 20 feet of steel casing. Cement grout must be used to fill the annular space between the surface casing and the borehole. (A.A.C. R12-15-811(B))

The Department's issuance of an authorization to drill a well is not a determination of whether water withdrawn from the well is legally surface water or groundwater. The legal nature of the water withdrawn from the well may be the subject of court action in the future as part of a determination of surface water rights in your area. If there are court proceedings that could affect your well, you will be notified and be given the opportunity to participate. If you have questions regarding the legal nature of the water to be withdrawn from your proposed well, please consult with an experienced civil engineer, hydrologist or water rights attorney.

For the purposes of determining appropriate fees outside AMAs or INAs, "domestic purposes" is defined as "uses related to the supply, service and activities of households and private residences and includes the application of water to less than 2 acres of land to produce plants or parts of plants for sale or human consumption, or for use as feed for livestock, range livestock or poultry, as such terms are defined in A.R.S. § 3-1201."

Notice of Intent to Drill, Deepen, Replace or Modify a Well

SECTION 8. PERMISSION TO ACCESS

By checking this box, I hereby provide ADWR permission to enter the property for the purpose of taking water level measurements at this well. Advance notice can be provided. (See instructions)

SECTION 9. WELL SITE PLAN

- ❖ If this well will be a domestic well on 5 acres or less, please draw the following: (1) the boundaries of your property; (2) the proposed well location; (3) the locations of all septic tank systems and sewer systems on the property or within 100 feet of the well location, even if on neighboring properties; and (4) any permanent structures on the property that may aid in locating the well. If the parcel is vacant land or lacks a septic tank or sewer system, please indicate this.
- ❖ Indicate the distance between the proposed well location and any septic tank system or sewer system. County Assessor's ID# _____ - _____ - _____

COUNTY OR LOCAL HEALTH AUTHORITY APPROVAL CODE

If applicant is filing this NOI electronically via the ADWR website and County approval is required, please indicate approval by providing a County Approval Code.

COUNTY APPROVAL CODE

SECTION 10. LAND OWNER AND WELL OWNER SIGNATURE

I state that this notice is filed in compliance with A.R.S. § 45-596 and is complete and correct to the best of my knowledge and belief.

Land Owner

Well Owner (if different from Land Owner; See instructions)

PRINT NAME AND TITLE
Bobby Payne / owner
SIGNATURE OF LAND OWNER
Bobby Payne
DATE
21 August 2023

PRINT NAME AND TITLE
SIGNATURE OF WELL OWNER
DATE

By checking this box, you agree to allow ADWR to contact you via electronic mail.

By checking this box, you agree to allow ADWR to contact you via electronic mail.

EMAIL ADDRESS
bobby.payne.65@gmail.com

EMAIL ADDRESS

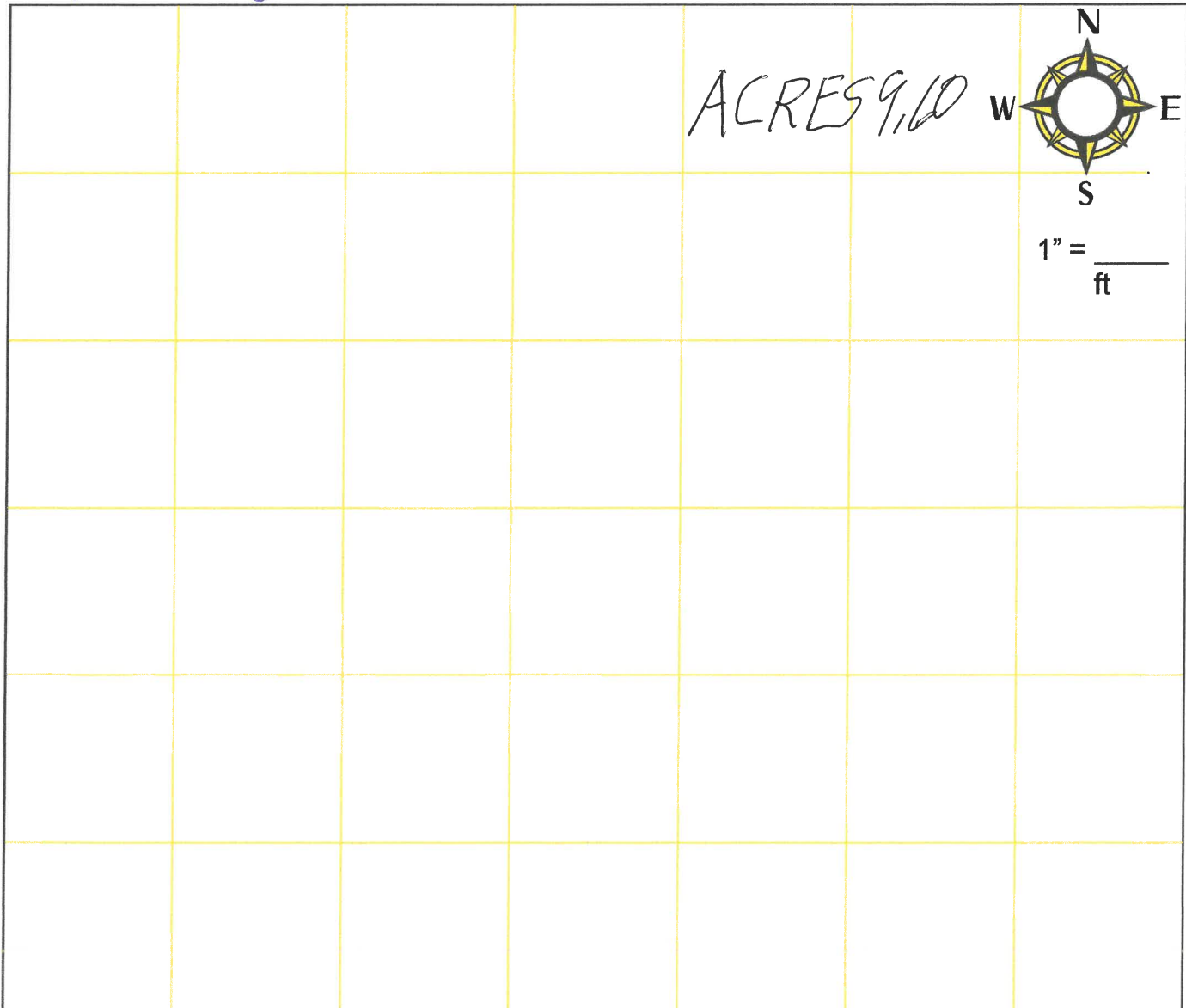

Account: R0011352

Location

Situs Address 67992 65 1/2 STREET
Parcel Number 304-72-017-Y
Parcel Size 9.60
Property Use 0004 - VACANT
 UNDETERMINED RURAL NONSUBDIVID
Neighborhood 02.05 - SALOME

Legal Summary (Note: Not to be used on legal documents) Section: 23 Township: 5N Range: 13W NE4 NE4 SE4 T5N R13W SEC 23 EXCEPT ELY 33' SHOWN AS 'LOT 2' ON SURVEY 2000-4478 EASEMENT OVER SLY 25' OF SE4 NE4 NE4 SE4 (2003-0932)

Code

Tax Area 3005 - SD #30 SD #76 FD
 MCMULLEN VALLEY IRRG MCMULLEN VALLEY

Owner Information

Owner Name BBJ RANCHES LLC
Owner Address 22294 HOLSEY ACRES RD
 INDIAHOMA, OK 73552

Assessment History

Full Cash Value (FCV) \$39,360
Limited Property Value (LPV) \$16,128
Primary Assessed \$2,419
Secondary Assessed \$5,904

Tax Area: 3005 **Primary Rate:** 10.0963
Secondary Rate: 3.4599

Legal Class	FCV	LPV	Primary Assessed	Secondary Assessed
02.R	\$39,360	\$16,128	\$2,419	\$5,904

Transfers

Sale Date	Sale Price	Doc Description
04/01/2022	\$0 \$34,000	Other Warranty Deed Sale Affidavit

Tax History

Tax Year	Taxes
*2024	\$344.32
2023	\$327.92

* Estimated

Images

- [GIS](#)

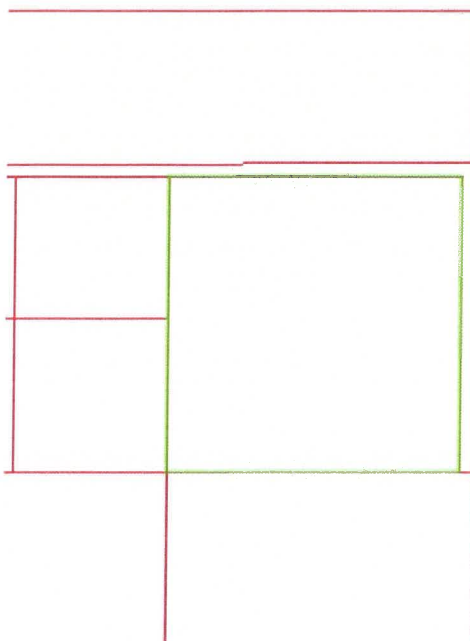



30472021

B05013023ADC

B05013023ADD

B05013024BCC

30472022

30472023

30472024

B05013023DAB

23

B05013023DAA

30472017Y

B05013024CBB

24

T 5N R13W

30472025

30472026

B05013023DA0



B05013023DAC

30472019

B05013023DAD

30472018

B05013024CBC

Arizona Department of Water Resources

1110 West Washington Street, Suite 310
Phoenix AZ 85007

Customer:

BBJ RANCHES LLC
22294 NW HOLSEY ACRES RD
INDIAHOMA, OK 73552

Receipt #: 24-102488
Office: MAIN OFFICE
Receipt Date: 10/10/2023
Sale Type: IN_PERSON
Cashier: Susan Montoya

Item No.	Function Code	AOBJ	Description	Ref ID	Qty	Unit Price	Ext Price
67489	122221	4439-TT	Notice of intention to drill a well that will not be located in an active management area or irrigation non-expansion area, that will be used solely for domestic purposes and that will have a pump with a maximum capacity of not more than 35 gallons per mi	239856	1	100.00	100.00
RECEIPT TOTAL:							100.00

Payment type: MONEY ORDER

Amount Paid: \$100.00

Payment Received Date: 10/10/2023

Reference No. 28893686016

Notes: FROM TTA.

ARIZONA DEPARTMENT of WATER RESOURCES
1110 W. Washington St. Suite 310
Engineering and Permits Division
Phoenix, AZ 85007
602-771-8500

NOTICE TO WELL DRILLERS

This is a reminder that a valid drill card must be present for the drilling of each and every well constructed on a site. During the construction of a well, if an unexpected problem occurs; the hole collapses, the hole is dry, or a drill bit is lost and can't be recovered, or any number of other situations where the driller feels they need to move over and start another well. Please be aware drillers do not have the authority to start another well without first obtaining drilling authority for the new well. Please note the following statutes and regulations pertaining to well drilling and construction:

ARIZONA REVISED STATUTE (A.R.S.)

A.R.S. § 45-592.A.

A person may construct, replace or deepen a well in this state only pursuant to this article and section 45-834.01. The drilling of a well may not begin until all requirements of this article and section 45-834.01, as applicable, are met.

A.R.S. § 594.A.

The director shall adopt rules establishing construction standards for new wells and replacement wells, the deepening and abandonment of existing wells and the capping of open wells.

A.R.S. § 600.A

A well driller shall maintain a complete and accurate log of each well drilled.

ARIZONA ADMINISTRATIVE CODE (A.A.C.)

A.A.C. R12-15-803.A.

A person shall not drill or abandon a well, or cause a well to be drilled or abandoned, in a manner which is not in compliance with A.R.S. Title 45, Chapter 2, Article 10, and the rules adopted thereunder.

A.A.C. R12-15-810.A.

A well drilling contractor or single well licensee may commence drilling a well only if the well drilling contractor or licensee has possession of a drilling card at the well site issued by the Director in the name of the well drilling contractor or licensee, authorizing the drilling of the specific well in the specific location.

A.A.C. R12-15-816.F.

In the course of drilling a new well, the well may be abandoned without first filing a notice of intent to abandon and without an abandonment card.

*** THIS REQUIREMENT DOES NOT PERTAIN TO THE DRILLING OF MINERAL EXPLORATION, GEOTECHNICAL OR HEAT PUMP BOREHOLES**



Arizona Department of Water Resources
 Groundwater Permitting and Wells
 1802 W Jackson St. Box #79
 Phoenix, Arizona 85007
 (602) 771-8527 • www.azwater.gov

Well Driller Report and Well Log

**THIS REPORT MUST BE FILED WITHIN 30 DAYS OF COMPLETING THE WELL,
PURSUANT TO ARIZONA REVISED STATUTE 45-600 AND A.A.C. RULE R12-15-808.**

FILE NUMBER B(5-13) 23 DAA
WELL REGISTRATION NUMBER 55 - 239856
PERMIT NUMBER (IF ISSUED)

WELL DRILLER LOGS AND REPORTS CAN ALSO BE DONE ONLINE AT:

http://www.azwater.gov/eForms/Forms/DL/DWR_DL.aspx

SECTION 1. DRILLING AUTHORIZATION

Drilling Firm		
Mail To:	NAME Q MOUNTAIN DRILLING	DWR LICENSE NUMBER 374
	ADDRESS PO BOX 491	TELEPHONE NUMBER 928-851-2537
	CITY / STATE / ZIP BOUSE, AZ, 85325-0491	FAX

SECTION 2. REGISTRY INFORMATION

Well Owner		Location of Well					
FULL NAME OF COMPANY, ORGANIZATION, OR INDIVIDUAL BBJ RANCHES LLC		WELL LOCATION ADDRESS (IF ANY)					
MAILING ADDRESS 22294 NW HOLSEY ACRES RD.		TOWNSHIP (N/S)	RANGE (E/W)	SECTION	160 ACRE 1/4	40 ACRE 1/4	10 ACRE 1/4
CITY / STATE / ZIP INDIAHOMA, OK, 73552		LATITUDE DEGREES MINUTES SECONDS		"N	LONGITUDE DEGREES MINUTES SECONDS		"W
CONTACT PERSON NAME AND TITLE		METHOD OF LATITUDE/LONGITUDE (CHECK ONE) <input type="checkbox"/> *GPS: Hand-Held <input type="checkbox"/> *GPS: Survey-Grade <input type="checkbox"/> TOPO					
TELEPHONE NUMBER 580 585-2523	FAX	*LATITUDE/LONGITUDE DATUM, GPS (CHECK ONE) <input type="checkbox"/> NAD83 <input type="checkbox"/> NAD27 <input type="checkbox"/> WGS84 <input type="checkbox"/> Other _____					
WELL NAME (e.g., MW-1, PZ-3, lot 25 Well, Smith Well, etc.)		METHOD OF ELEVATION (CHECK ONE) <input type="checkbox"/> *GPS: Hand-Held <input type="checkbox"/> *GPS: Survey-Grade <input type="checkbox"/> TOPO					
COUNTY LA PAZ	ASSESSOR'S PARCEL ID NUMBER (MOST RECENT) BOOK MAP PARCEL 304 72 017Y			LAND SURFACE ELEVATION AT WELL ELEVATION _____ Feet Above Sea Level			
		*ELEVATION DATUM (CHECK ONE) <input type="checkbox"/> NAVD88 <input type="checkbox"/> NGVD29 <input type="checkbox"/> OTHER _____					

SECTION 3. WELL CONSTRUCTION DETAILS

Drilling Method	Method of Well Development	Method of Sealing at Reduction Points
CHECK ONE <input type="checkbox"/> Air Rotary <input type="checkbox"/> Bored or Augered <input type="checkbox"/> Cable Tool <input type="checkbox"/> Dual Rotary <input type="checkbox"/> Mud Rotary <input type="checkbox"/> Reverse Circulation <input type="checkbox"/> Driven <input type="checkbox"/> Jetted <input type="checkbox"/> Air Percussion / Odex Tubing <input type="checkbox"/> Other (please specify)	CHECK ONE <input type="checkbox"/> Airlift <input type="checkbox"/> Bail <input type="checkbox"/> Surge Block <input type="checkbox"/> Surge Pump <input type="checkbox"/> Other (please specify)	CHECK ONE <input type="checkbox"/> None <input type="checkbox"/> Packed <input type="checkbox"/> Swedged <input type="checkbox"/> Welded <input type="checkbox"/> Other (please specify)
	Condition of Well	Construction Dates
	CHECK ONE <input type="checkbox"/> Capped <input type="checkbox"/> Abandoned <input type="checkbox"/> Pump Installed <input type="checkbox"/> Not Drilled	DATE WELL CONSTRUCTION STARTED
		DATE WELL CONSTRUCTION COMPLETED

I state that this notice is filed in compliance with A.R.S. § 45-596 and is complete and correct to the best of my knowledge and belief.

SIGNATURE OF QUALIFYING PARTY	DATE
-------------------------------	------

Well Driller Report and Well Log

WELL REGISTRATION NUMBER 55 - 239856

SECTION 4. WELL CONSTRUCTION DESIGN (AS BUILD) (attach additional page if needed)		
Depth		
DEPTH OF BORING Feet Below Land Surface	DEPTH OF COMPLETED WELL Feet Below Land Surface	

Water Level Information			
STATIC WATER LEVEL Feet Below Land Surface	DATE MEASURED	TIME MEASURED	IF FLOWING WELL, METHOD OF FLOW REGULATION <input type="checkbox"/> Valve <input type="checkbox"/> Other:

Borehole			Installed Casing													
DEPTH FROM SURFACE		BOREHOLE DIAMETER (inches)	DEPTH FROM SURFACE		OUTER (inches)	MATERIAL TYPE (X)				PERFORATION TYPE (X)					SLOT SIZE (inches)	
FROM (feet)	TO (feet)		FROM (feet)	TO (feet)		STEEL	PVC	ABS	IF OTHER TYPE, DESCRIBE	BLANK OR NONE	WIRE WRAP	SHUTTER SCREEN	MILLS KNIFE	SLOTTED		IF OTHER TYPE, DESCRIBE

Installed Annular Material												
DEPTH FROM SURFACE		ANNULAR MATERIAL TYPE (X)							FILTER PACK			
FROM (feet)	TO (feet)	NONE	CONCRETE	NEAT CEMENT OR CEMENT GROUT	CEMENT-BENTONITE GROUT	BENTONITE			IF OTHER TYPE OF ANNULAR MATERIAL, DESCRIBE	SAND	GRAVEL	SIZE
						GROUT	CHIPS	PELLETS				

SECTION 5. GEOLOGIC LOG OF WELL			
DEPTH FROM SURFACE		Description Describe material, grain size, color, etc.	Check (X) every interval where water was encountered (if known)
FROM (feet)	TO (feet)		

Well Driller Report and Well Log

WELL REGISTRATION NUMBER
55 - 239856

SECTION 6. WELL SITE PLAN			
NAME OF WELL OWNER	COUNTY ASSESSOR'S PARCEL ID NUMBER (MOST RECENT)		
BBJ RANCHES LLC	BOOK 304	MAP 72	PARCEL 017Y

- ❖ Required for all wells, please draw the following: (1) the boundaries of property on which the well was located; (2) the well location; (3) the locations of all septic tank systems and sewer systems on the property or within 100 feet of the well location, even if on neighboring properties; and (4) any permanent structures on the property that may aid in locating the well.
- ❖ Please indicate the distance between the well location and any septic tank system or sewer system.

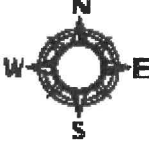
						
						1" = _____ ft



Well Driller Report and Well Log

Introduction

These instructions are a guide to filling out Form DWR 55-55 (Rev. 06/15/2010), entitled "Well Driller Report and Well Log." Please review the instructions prior to completing the form in black or blue ink. Forms may be obtained at any Arizona Department of Water Resources (ADWR) office and at ADWR's web site, <http://www.azwater.gov>. For information about the form or these instructions, contact Groundwater Permitting & Wells at (602) 771-8500. There is no fee for filing this form.

When Form DWR 55-55 Must be Filed

Within 30 days after completion of the drilling, deepening or modification of a well, the licensed well driller who performed the work must file a Well Driller Report and Log with ADWR. Because the information in the report describes the well as it was actually constructed, and comes from the person who constructed the well, the information is very valuable to ADWR. For that reason, it is very important to fill out the report with the most accurate information possible.

Instructions for Filling out the Form

Well Registration and Permit Numbers

Fill in the registration number of the well and any ADWR permit number associated with the well in the upper right-hand corner of the first page. Also fill in the well registration number in the upper right-hand corner of all other pages so that the well information on those pages can be identified when the pages are separated during computer imaging.

Section 1 - Drilling Authorization

Fill in the name, address, DWR license number and telephone and fax numbers of the drilling firm filing the report.

Section 2 - Registry Information

Well Owner

Fill in the name, mailing address, telephone number and fax number (if available) of the well owner. If the well owner is a corporation, governmental unit or other entity, provide the name of a contact person.

Location of Well

Fill in the following information relating to the location of the well:

- The street address of the property where the well is located. For monitor wells or other wells associated with contaminant investigations or remedial projects, this will usually be the same as the facility address.
- The legal description of the well site. The legal description is the township, range, section, and in decreasing order, the quarters of that section so that the well location falls in a 10-acre block within that section. Normally, the legal description will be the same as that given in the original Notice of Intent to drill the well, but occasionally a more accurate description is discovered after the Notice is filed.
- The latitude and longitude (in degrees-minutes-seconds format) and land surface elevation at the well, and the method used to determine these data. **Please note this information is mandatory.** Use of a Global Positioning System (GPS) receiver is the only method accepted by the Department. The GPS unit should be adjusted to use the NAD-83 datum. Please indicate if the geographic coordinate datum used was NAD-83, and if not, which datum was used.
- The name of the county and the tax assessor's parcel identification number for the land where the well is located. This information can normally be taken from the original Notice of Intent to drill the well, and may also be obtained from the county tax assessor's office. Federal or State land will not have a parcel identification number.

Section 3 - Well Construction Details

Section 3 requires details on the construction of the well. Indicate the drill method by checking the appropriate box. If the drill method is not listed, check the "Other" box and describe the method. To the right of that, indicate the method of well development by checking the

appropriate box. Next, indicate the method of sealing at reduction points. If the method used is not listed, check "Other" and provide a brief explanation. Under *Well Driller Completion Report and Well Log* Form 55-55 Instructions (Rev. 06/2010) Page 2

Condition of Well, indicate whether the well was capped, or a pump was installed, when you left it. Then fill in the date when well construction started, and the date when well construction was completed.

Signature Block

The form must be signed and dated by the qualifying party of the drilling firm.

Section 4 - Well Construction Design (As Built)

Section 4 contains tables to fill in information on the existing borehole, the installed casing and the installed annular material. The tables are broken down by depth interval.

In the first set of boxes, fill in the depth of the boring and the depth of the completed well, as measured in feet below the land surface.

Under **Water Level Information** please indicate the static water level in the well, as measured in feet below the land surface, and the date and time the water level was measured. If the well is a flowing well, include the method by which the artesian flow is regulated.

In the **Borehole** table, fill in the diameter of the borehole in inches, and indicate the depth interval for each change in diameter. In the **Installed Casing** table, fill in the outer diameter of the casing in inches, check the appropriate boxes indicating the type of casing material and the type of perforations, and fill in the slot size of any perforations. Fill in the depth interval for each change in information. Please note that not every interval will be perforated. Check the "Blank or None" box for non-perforated depth intervals. If the type of casing material or perforations is not listed, describe the type in the appropriate box.

In the **Installed Annular Material** table, check the appropriate boxes indicating the type of annular material or filter pack installed at each depth interval. Fill in the size of the filter pack used. Provide the depth interval for each change in information. If the type of annular material is not listed, describe the material in the appropriate box.

Section 5 - Geologic Log of Well

Section 5 requires the geologic or lithologic log of the well. Describe the various units encountered during drilling. Provide as much description as possible. The

log description must be broken down by depth intervals below ground surface, and every interval where groundwater, including perched groundwater, was encountered must be checked. If a consulting firm was involved with the well construction, the consultant's lithologic log may be submitted in lieu of completing Section 5.

Section 6 - Well Site Plan

In the boxes at the top of Section 6, fill in the name of the well owner and the county tax assessor's parcel identification number for the land where the well is located. Below that, provide a scale drawing of where the well was actually constructed on the parcel, illustrating the property boundaries, the well location and any structures on the property. The drawing must also show the location of any septic tank or sewer systems on the property or within 100 feet of the well, even if on neighboring property, and the distance between the well and the septic tank or sewer system. The drawing should closely match the drawing on the original Notice of Intent to drill the well, but the purpose of this drawing is to show where the well was actually drilled, especially if the location is different than originally planned. This information will be shared with the county.

Where to File Form

Completed forms may be mailed to ADWR at the following address:

Arizona Department of Water Resources
Groundwater Permitting and Wells
1802 W Jackson St. Box #79
Phoenix, AZ 85007

Completed forms may also be submitted to ADWR's main office at 1110 W. Washington St. Suite 310., Phoenix, AZ 85007.

The completed form must be legible and of good quality when received by ADWR so that it can be scanned into ADWR's permanent records.



Arizona Department of Water Resources
 Information Management Unit
 1802 W Jackson St. Box #79
 Phoenix, AZ 85007
 (602) 771-8527 • www.azwater.gov

Pump Installation Completion Report

- ❖ Review instructions prior to completing form in black or blue ink.
- ❖ The registered well owner should file this report with the Department within 30 days following installation of pump equipment.

** PLEASE PRINT CLEARLY **

FILE NUMBER

B(5-13) 23 DAA

WELL REGISTRATION NUMBER

55 - 239856

SECTION 1. REGISTRY INFORMATION	
Well Owner	Location of Well
FULL NAME OF COMPANY, ORGANIZATION, OR INDIVIDUAL BBJ RANCHES LLC	WELL LOCATION ADDRESS (IF ANY)
MAILING ADDRESS 22294 NW HOLSEY ACRES RD.	TOWNSHIP (N/S) RANGE (E/W) SECTION 160 ACRE 40 ACRE 10 ACRE 1/4 1/4 1/4
CITY / STATE / ZIP INDIAHOMA, OK, 73552	COUNTY ASSESSOR'S PARCEL ID NUMBER (MOST RECENT)
CONTACT PERSON NAME AND TITLE	BOOK 304 MAP 72 PARCEL 017Y
TELEPHONE NUMBER 580 585-2523	FAX
	COUNTY WHERE WELL IS LOCATED

SECTION 2. EQUIPMENT INSTALLED	
DATE PUMP INSTALLED	Pitless Adaptor
Pump Type	CHECK ONE (SEE INSTRUCTIONS FOR DEFINITION)
CHECK ONE	Was a pitless adaptor installed? <input type="checkbox"/> Yes <input type="checkbox"/> No
<input type="checkbox"/> Air Lift <input type="checkbox"/> Rotary	IF YES, DEPTH BELOW GROUND LEVEL THE DEVICE WAS INSTALLED Feet
<input type="checkbox"/> Bucket <input type="checkbox"/> Submersible	Power Type
<input type="checkbox"/> Centrifugal <input type="checkbox"/> Turbine	CHECK ONE
<input type="checkbox"/> Jet <input type="checkbox"/> Other (Please Specify):	<input type="checkbox"/> Diesel Engine <input type="checkbox"/> Natural Gas
<input type="checkbox"/> Piston	<input type="checkbox"/> Electric Motor <input type="checkbox"/> Windmill
	<input type="checkbox"/> Gasoline Engine <input type="checkbox"/> Other (Please Specify):
RATED PUMP CAPACITY Gallons Per Minute	HORSE POWER RATING OF MOTOR

SECTION 3. PUMP TEST		
Pump Test Data	Method of Discharge Measurement	Method of Measuring Water Level
DATE WELL TESTED	CHECK ONE	CHECK ONE
STATIC WATER LEVEL (A) Feet Below Land Surface	<input type="checkbox"/> Bailer	<input type="checkbox"/> Air Line
PUMPING WATER LEVEL (B) Feet Below Land Surface	<input type="checkbox"/> Bucket - Barrel - Stopwatch	<input type="checkbox"/> Electric Measuring Line (Sonder)
DRAWDOWN [(B) - (A)] Feet Below Land Surface	<input type="checkbox"/> Current	<input type="checkbox"/> Steel Tape
TEST PUMPING RATE Gallons Per Minute	<input type="checkbox"/> Estimated - Air Lift	<input type="checkbox"/> Other (Please Specify):
DURATION OF PUMP TEST (Minimum 4 Hours) Hours	<input type="checkbox"/> Gauge	
TOTAL PUMPING LIFT Feet	<input type="checkbox"/> Meter	
	<input type="checkbox"/> Orifice	
	<input type="checkbox"/> Volume	
	<input type="checkbox"/> Weir - Flume	
	<input type="checkbox"/> Other (Please Specify):	
FOR FLOWING WELL, MEASURED SHUT IN HEAD	<input type="checkbox"/> FT	
	<input type="checkbox"/> PSI	

I HEREBY CERTIFY that the above statements are true to the best of my knowledge and belief according to A.R.S. § 45-600(B).

SIGNATURE OF WELL OWNER	DATE
-------------------------	------

Pump Installation Completion Report



Introduction

These instructions are a guide to filling out Form DWR 55-56 (Rev. 07/20/07), entitled "Pump Installation Completion Report." Please review the instructions prior to completing the form in black or blue ink. Forms may be obtained at any Arizona Department of Water Resources (ADWR) office and at ADWR's Web site, <http://www.azwater.gov>. For information about the form or these instructions, contact the Supervisor of the Notice of Intent Program at (602) 771-8500. There is no fee for filing this form.

When Form DWR 55-56 Must be Filed

A Pump Installation Completion Report must be filed by the owner of a well within 30 days after a pump is installed in the well. It is recommended that the report be filled out with the assistance of the firm that installed the pump. The information in the report, including where the well is located, who owns the well, and what pump equipment was installed in the well, will be placed in ADWR's database of all wells in Arizona. Because the report will describe conditions in the well as they actually exist, the information is very valuable to ADWR. For that reason, it is very important to fill out the report with the most accurate information possible.

Instructions for Filling out the Form

Well Registration Number

Fill in the registration number of the well in the box in the upper right-hand corner of the form. If this is a new well, the number will be the registration number that ADWR assigned to the well when the Notice of Intent to drill the well was filed.

Section 1 - Registry Information

Well Owner

Fill in the well owner's name, mailing address and telephone and fax numbers. If the well owner is a corporation, governmental unit or other entity, provide the name of a contact person.

Location of Well

Fill in the following information relating to the location of the well:

The street address of the property where the well is located, if

the property has a street address.

- The legal description of the well location. The legal description is the township, range, section, and in decreasing order, the quarters of that section so that the well location falls in a 10-acre block within that section. This will usually be the same as the legal description for the well location submitted with the original Notice of Intent to drill the well, but occasionally a more accurate legal description is discovered after the Notice is filed.
- The county tax assessor's parcel identification number for the land where the well is located. This information can normally be taken from the original Notice of Intent to drill the well, and may also be obtained from the county tax assessor's office. Federal or State land will not have a parcel identification number.
- The name of the county where the well is located.

Section 2 - Equipment Installed

Section 2 requires information on the pump equipment installed in the well. In the space in the upper left-hand corner of the section, fill in the date the pump equipment was installed.

Pitless adaptor is defined in Arizona Administrative Code R12-15-801(21), as a commercially manufactured watertight unit or device designed for attachment to a steel well casing which permits discharge from the well below the land surface and allows access into the well casing while preventing contaminants from entering the well. In the box labeled **Pitless Adaptor**, check yes if a pitless adaptor was installed and note at what depth below grade the device was installed.

In the block labeled **Pump Type**, check the appropriate box indicating the type of pump installed. If the type of pump is not listed, check "Other" and describe the pump type. Below that block, fill in the rated pump capacity of the pump in gallons per minute.

In the block labeled **Power Type**, check the appropriate box indicating the type of power the pump uses. If the type of power is not listed, check "Other" and describe the power type. Below that block, fill in the horsepower rating of the

motor. This information can be obtained from the firm that installed the pump.

Section 3 - Pump Test

Section 3 contains three blocks for providing information on the results of the pumping test that is required to be performed on the well and pump. In the block labeled **Pump Test Data**, fill in the following information:

- The date the well was tested.
- The static water level in the well. This is the water level in the well immediately prior to the pumping test, as measured in feet below the land surface.
- The pumping water level. This is the water level in the well immediately after the pump was operated for at least four hours, as measured in feet below the land surface.
- Drawdown. This is the difference between the pumping water level and the static water level.
- The pumping rate during the test, as measured in gallons per minute.
- The duration of the pumping test, which must be at least four hours of continuous operation.
- The total pumping lift, if known, as measured in feet.
- If the well is a flowing or artesian well, the shut-in pressure head in feet or pounds per square inch.

In the block labeled **Method of Discharge Measurement**, check the appropriate box indicating how the discharge was measured during the pumping test. If the method of measurement is not listed, check "Other" and provide a brief description of the method.

In the block labeled **Method of Measuring Water Level**, check the appropriate box indicating the method by which the water levels were measured during the pumping test. If the method used is not listed, check "Other" and provide a brief description of the method.

Signature Block

The form must be signed and dated by the well owner.

Where to File Form

Completed forms may be mailed to ADWR at the following address:

Arizona Department of Water Resources
Groundwater Permitting and Wells
1802 W Jackson St. Box #79
Phoenix, AZ 85007

Completed forms may also be submitted to ADWR's main office in Phoenix at 1110 W. Washington St. Suite 310 Phoenix, Az. 85007.

The completed form must be legible and of good quality when received by ADWR so that it can be scanned into ADWR's permanent records.



IS YOUR WELL REGULATED BY ADEQ?

While the Arizona Department of Water Resources (ADWR) permits the drilling of a well, the Arizona Department of Environmental Quality (ADEQ) regulates any well **used for drinking water** that:

- has at least 15 service connections, or
- serves an average of at least 25 people for at least 60 days per year.

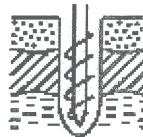

DRILLING

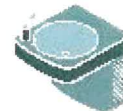

DRINKING

Before drinking from your well:



Test your water at a laboratory



Submit construction plans to ADEQ for review

For questions or to submit documentation, please contact the ADEQ Engineering Review team:

602-771-4677

Email: wqd_dwser@azdeq.gov

Visit: azdeq.gov/EngineeringReview

ADEQ | Engineering Review
1110 W. Washington Street
Phoenix, AZ 85007

Publication number: C-18-02 | For translations or other communications aids, please email the Title VI Coordinator at tlb@azdeq.gov | Para traducciones u otras ayudas de comunicación, envíe un correo electrónico al Coordinador del Título VI al tlb@azdeq.gov.