

## COLORADO DIVISION OF WATER RESOURCES

1313 Sherman Street - Room 818  
Denver, Colorado 80203THIS FORM MUST BE SUBMITTED  
WITHIN 60 DAYS OF COMPLETION  
OF THE WORK DESCRIBED HERE-  
ON. TYPE OR PRINT IN BLACK  
INK.

## WELL COMPLETION AND PUMP INSTALLATION REPORT

PERMIT NUMBER 104063

RECEIVED

DEC 21 1979

WATER RESOURCES  
STATE ENGINEERWELL OWNER Ronald W. JohnsonSE 1/4 of the NW 1/4 of Sec. 7ADDRESS 905 GRAND AVE  
GLENWOOD SPRINGS COLOT. 7 S. R. 94 W. 6TH P.M.DATE COMPLETED MAR 2, 19 79

## HOLE DIAMETER

6 3/4 in. from 0 to 130 ft.

\_\_\_\_\_ in. from \_\_\_\_\_ to \_\_\_\_\_ ft.

\_\_\_\_\_ in. from \_\_\_\_\_ to \_\_\_\_\_ ft.

DRILLING METHOD RotaryCASING RECORD: Plain CasingSize 5' & kind 250 from 0 to 90' ft.

Size \_\_\_\_\_ &amp; kind \_\_\_\_\_ from \_\_\_\_\_ to \_\_\_\_\_ ft.

Size \_\_\_\_\_ &amp; kind \_\_\_\_\_ from \_\_\_\_\_ to \_\_\_\_\_ ft.

## Perforated Casing

Size 5' & kind 250 from 90 to 250 ft.

Size \_\_\_\_\_ &amp; kind \_\_\_\_\_ from \_\_\_\_\_ to \_\_\_\_\_ ft.

Size \_\_\_\_\_ &amp; kind \_\_\_\_\_ from \_\_\_\_\_ to \_\_\_\_\_ ft.

## GROUTING RECORD

Material CEMENTIntervals 5' to 20'Placement Method Pour on Packer

GRAVEL PACK: Size \_\_\_\_\_

Interval \_\_\_\_\_

## TEST DATA

Date Tested MAR 2, 19 79Static Water Level Prior to Test 70' ft.Type of Test Pump BAILERLength of Test 2 HRSSustained Yield (Metered) 25' GPMFinal Pumping Water Level 80'

## WELL LOG

From	To	Type and Color of Material	Water Loc.
0	130	OVER BURDEN 2' BASALT BOULDERS	110
TOTAL DEPTH <u>130'</u>			

Use additional pages necessary to complete log.

# PUMP INSTALLATION REPORT

Pump Make \_\_\_\_\_  
Type \_\_\_\_\_  
Powered by \_\_\_\_\_ HP \_\_\_\_\_  
Pump Serial No. \_\_\_\_\_  
Motor Serial No. \_\_\_\_\_  
Date Installed \_\_\_\_\_  
Pump Intake Depth \_\_\_\_\_  
Remarks \_\_\_\_\_  
\_\_\_\_\_

## WELL TEST DATA WITH PERMANENT PUMP

Date Tested \_\_\_\_\_  
Static Water Level Prior to Test \_\_\_\_\_  
Length of Test \_\_\_\_\_ Hours  
Sustained yield (Metered) \_\_\_\_\_ GPM  
Pumping Water Level \_\_\_\_\_  
Remarks \_\_\_\_\_  
\_\_\_\_\_

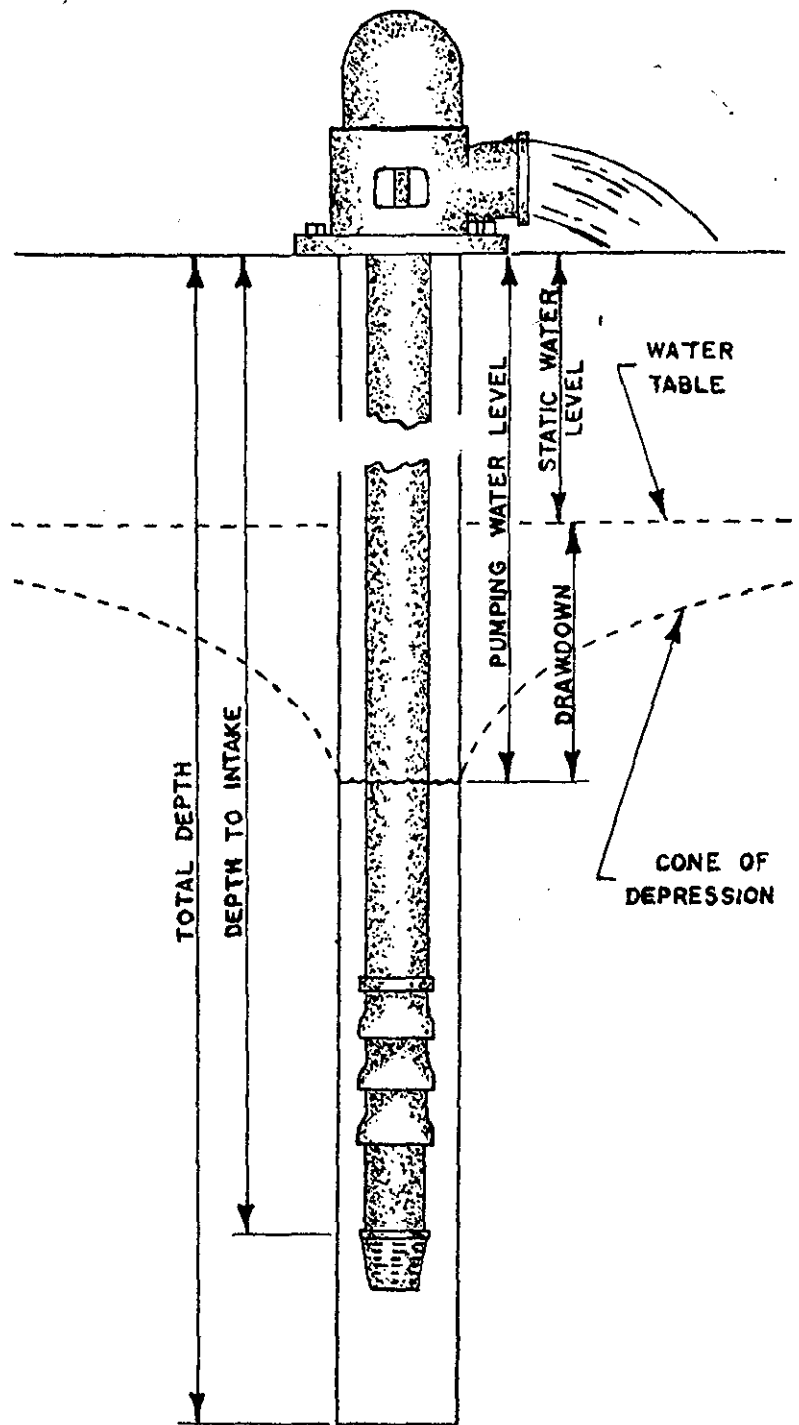

## CONTRACTORS STATEMENT

The undersigned, being duly sworn upon oath, deposes and says that he is the contractor of the well or pump installation described hereon; that he has read the statement made hereon; knows the content thereof, and that the same is true of his own knowledge.

Signature O. W. McNeal License No. 697

State of Colorado, County of GARFIELD SS

Subscribed and sworn to before me this 18<sup>th</sup> day of DECEMBER, 1979.

My Commission expires APRIL 8, 1981.

Notary Public R. D. McNeal

FORM TO BE MADE OUT IN QUADRUPLICATE: WHITE FORM must be an original copy on both sides and signed. WHITE AND GREEN copies must be filed with the State Engineer. PINK COPY is for the Owner and YELLOW COPY is for the Driller.

## PERMIT APPLICATION FORM

Application must be complete where applicable. Type or print in BLACK INK. No overstrikes or erasures unless initiated.

(X) A PERMIT TO USE GROUND WATER  
(X) A PERMIT TO CONSTRUCT A WELL  
FOR: (X) A PERMIT TO INSTALL A PUMP

( ) REPLACEMENT FOR NO. \_\_\_\_\_  
( ) OTHER \_\_\_\_\_  
WATER COURT CASE NO. \_\_\_\_\_

RECEIVED  
DEC 29 1978  
WATER RESOURCES  
STATE ENGINEER  
COLORADO

(1) APPLICANT - mailing address

NAME RONALD W. JOHNSON  
STREET 905 Grand Avenue  
CITY Glenwood Springs, CO 81601  
(State) (Zip)  
TELEPHONE NO. 945-8582

## (2) LOCATION OF PROPOSED WELL

County Garfield  
SE ¼ of the NW ¼, Section 7  
Twp. 7 S, Rng. 94 W, 6th P.M.  
(N. S.) (E. W.)

### (3) WATER USE AND WELL DATA

Proposed maximum pumping rate (gpm) 15

Average annual amount of ground water  
to be appropriated (acre-feet): 1 acre foot

Number of acres to be irrigated: less than 1 acre

Proposed total depth (feet): 200

Aquifer ground water is to be obtained from:

Owner's well designation Johnson Well #1

GROUND WATER TO BE USED FOR:

(x) HOUSEHOLD USE ONLY - no irrigation (0)  
 (X) DOMESTIC (1) ( ) INDUSTRIAL (5)  
 (x) LIVESTOCK (2) ( ) IRRIGATION (6)  
 ( ) COMMERCIAL (4) ( ) MUNICIPAL (8)  
 ( ) OTHER (9)

DETAIL THE USE ON BACK IN (11)

## (4) DRILLER

Name Mountain Drilling  
Street 5062 County Road 113  
City Carbondale, Colorado 81623  
(State) (Zip)  
Telephone No. 945-5148 Lic. No. 697

FOR OFFICE USE ONLY: DO NOT WRITE IN THIS COLUMN

Receipt No. 101222

Basin \_\_\_\_\_ Dist. \_\_\_\_\_

### CONDITIONS OF APPROVAL

This well shall be used in such a way as to cause no material injury to existing water rights. The issuance of the permit does not assure the applicant that no injury will occur to another vested water right or preclude another owner of a vested water right from seeking relief in a civil court action.

APPROVED PURSUANT TO CRS 1973, 37-92-602  
 [(3)(b)(II) AS THE ONLY WELL ON A TRACT  
 OF 35 ACRES OR MORE DESIGNATED AS 42  
 ACRES IN SE 1/4 NW 1/4, SEC. 7,  
T. 7 S., R. 94 W., 6 P.M.

APPROVED FOR DOMESTIC USE, INCLUDING THE  
IRRIGATION OF NOT OVER ONE ACRE OF HOME  
GARDENS AND LAWNS.

**THIS WELL MUST BE CONSTRUCTED ACCORDING TO THE REVISED AND AMENDED RULES AND REGULATIONS APPROVED BY THE STATE BOARD OF EXAMINERS FOR WATER WELL AND PUMP INSTALLATION CONTRACTORS.**

APPLICATION APPROVED

PERMIT NUMBER **104063**

DATE ISSUED **JAN 05 1979**

EXPIRATION DATE **JAN 05 1981**

Bruce E. DeBrie  
(STATE ENGINEER)

BY G. A. Stallman

I.D. 5-45 COUNTY 23

(5) THE LOCATION OF THE PROPOSED WELL and the area on which the water will be used must be indicated on the diagram below. Use the CENTER SECTION (1 section, 640 acres) for the well location.

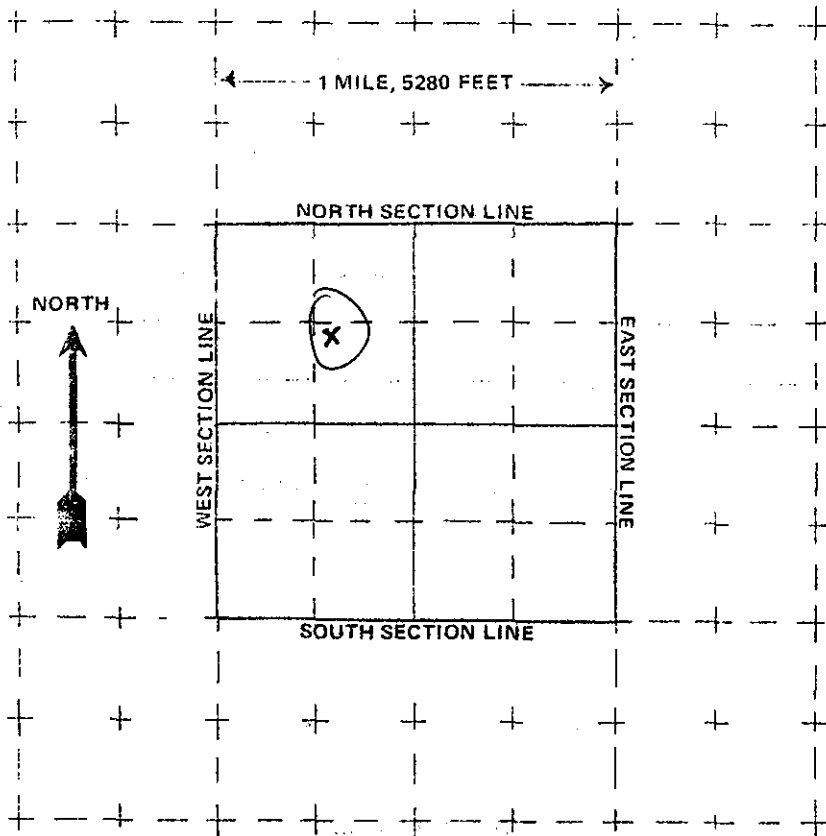

The scale of the diagram is 2 inches = 1 mile  
Each small square represents 40 acres.

**WATER EQUIVALENTS TABLE (Rounded Figures)**

An acre-foot covers 1 acre of land 1 foot deep  
1 cubic foot per second (cfs) . . . 449 gallons per minute (gpm)  
A family of 5 will require approximately 1 acre-foot of water per year.  
1 acre-foot . . . 43,560 cubic feet . . . 325,900 gallons.  
1,000 gpm pumped continuously for one day produces 4.42 acre-feet.

(6) THE WELL MUST BE LOCATED BELOW by distances from section lines.

1350 ft. from North sec. line  
(north or south)

1350 ft. from West sec. line  
(east or west)

LOT NA BLOCK NA FILING # \_\_\_\_\_

SUBDIVISION \_\_\_\_\_

(7) TRACT ON WHICH WELL WILL BE LOCATED Owner: Ronald W. Johnson

No. of acres 42 Will this be the only well on this tract? Yes

**(8) PROPOSED CASING PROGRAM**

Plain Casing

\_\_\_\_\_ in. from \_\_\_\_\_ ft. to \_\_\_\_\_ ft.

\_\_\_\_\_ in. from \_\_\_\_\_ ft. to \_\_\_\_\_ ft.

Perforated casing X

\_\_\_\_\_ in. from \_\_\_\_\_ ft. to \_\_\_\_\_ ft.

\_\_\_\_\_ in. from \_\_\_\_\_ ft. to \_\_\_\_\_ ft.

(9) FOR REPLACEMENT WELLS give distance and direction from old well and plans for plugging it:

\_\_\_\_\_  
\_\_\_\_\_  
\_\_\_\_\_  
\_\_\_\_\_

**(10) LAND ON WHICH GROUND WATER WILL BE USED:**

Owner(s): Ronald W. Johnson No. of acres: 42

Legal description: \_\_\_\_\_

(11) DETAILED DESCRIPTION of the use of ground water: Household use and domestic wells must indicate type of disposal system to be used.

Ordinary household drain and septic system

**(12) OTHER WATER RIGHTS** used on this land, including wells. Give Registration and Water Court Case Numbers.

Type or right	Used for (purpose)	Description of land on which used

(13) THE APPLICANT(S) STATE(S) THAT THE INFORMATION SET FORTH HEREON IS TRUE TO THE BEST OF HIS KNOWLEDGE.

SIGNATURE OF APPLICANT(S)