

Soils Map

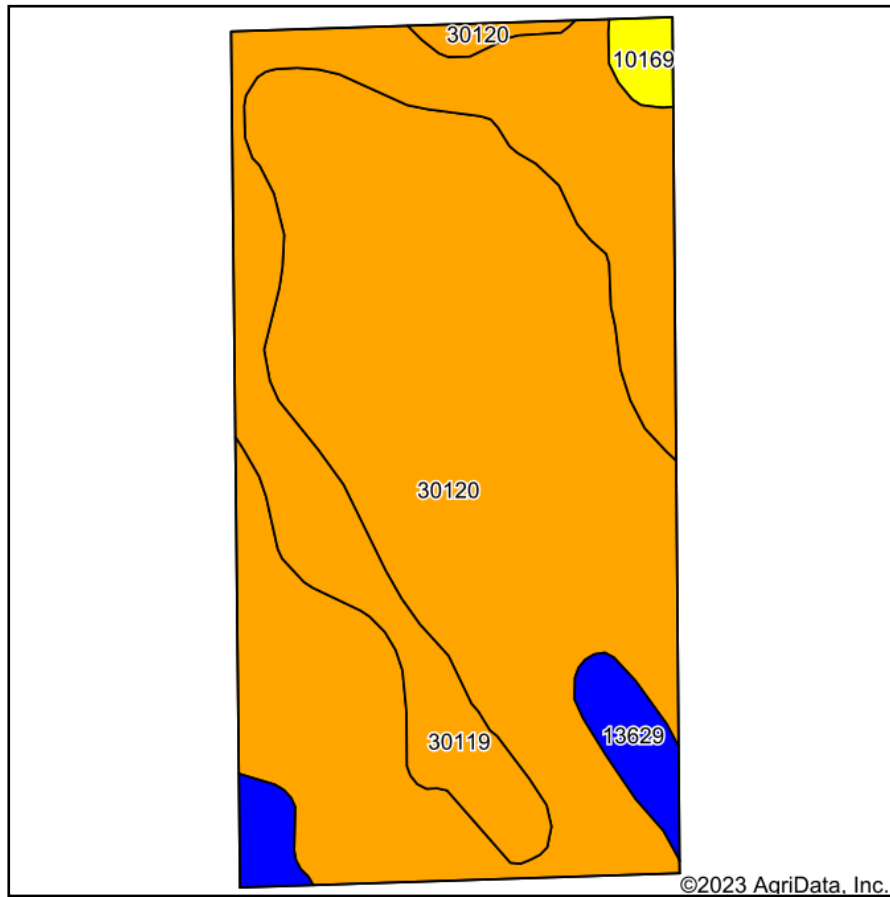

Soils data provided by USDA and NRCS.

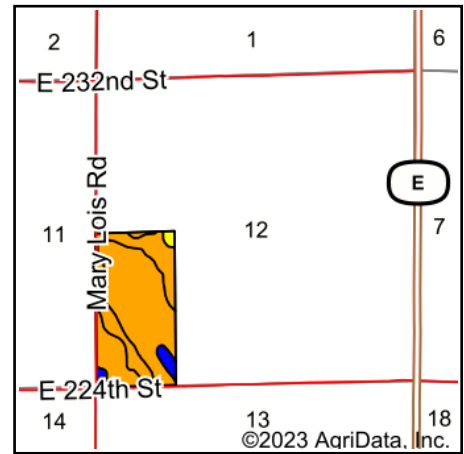

State: **Missouri**
 County: **Ray**
 Location: **12-54N-27W**
 Township: **Grape Grove**
 Acres: **82.45**
 Date: **11/20/2023**

United Country
 Property
 Solutions, LLC

Maps Provided By:

surety
 CUSTOMIZED ONLINE MAPPING
 © AgriData, Inc. 2023 www.AgriDataInc.com



Area Symbol: MO177, Soil Area Version: 23

Code	Soil Description	Acres	Percent of field	Non-Irr Class Legend	Non-Irr Class *c	Alfalfa hay Tons	Caucasian bluestem Tons	Common bermudagrass Tons	Orchardgrass red clover Tons	Tall fescue Tons	Warm season grasses Tons	*n NCCPI Overall	*n NCCPI Corn	*n NCCPI Soybeans
30120	Lagonda silty clay loam, 5 to 9 percent slopes, eroded	56.29	68.3%		Ille	5	8	7	8	7	8	70	68	59
30119	Lagonda silty clay loam, 2 to 5 percent slopes, eroded	21.46	26.0%		Ille							73	73	58
13629	Colo silt loam, 1 to 4 percent slopes, occasionally flooded	3.58	4.3%		Ilw							81	72	81
10169	Lagonda silty clay loam, 9 to 14 percent slopes, eroded	1.12	1.4%		IVe	5	8	7	8	7	8	72	72	56
Weighted Average					2.97	3.5	5.6	4.9	5.6	4.9	5.6	*n 71.3	*n 69.5	*n 59.7

*n: The aggregation method is "Weighted Average using all components"

*c: Using Capabilities Class Dominant Condition Aggregation Method

Soils data provided by USDA and NRCS.