

# Soils Map

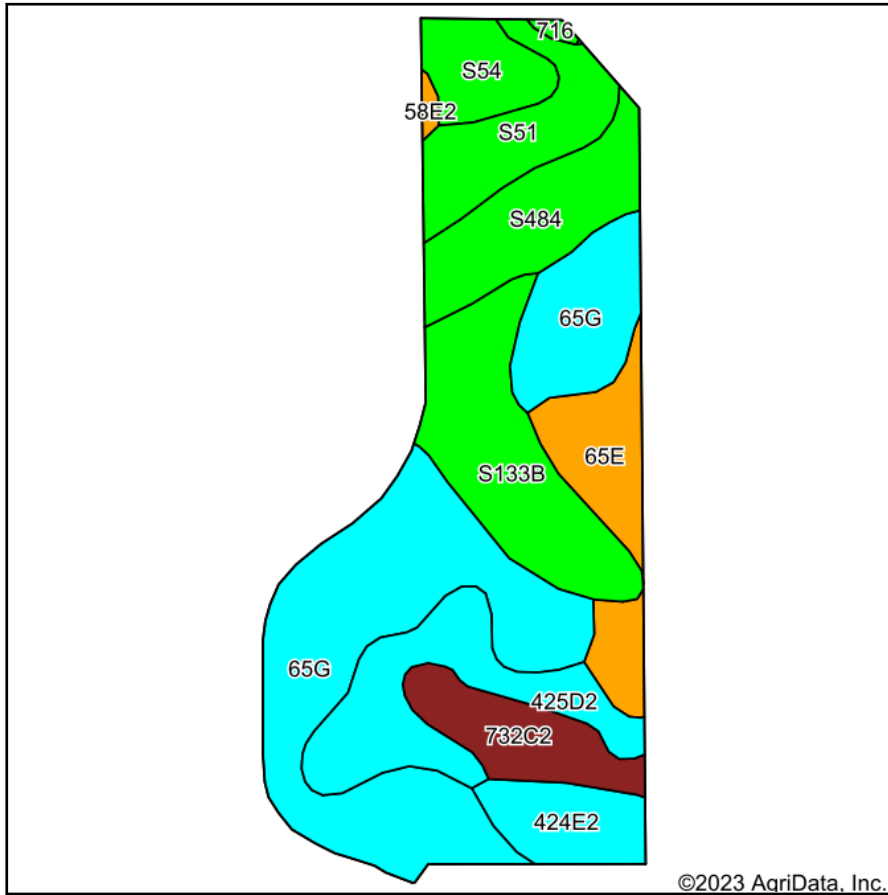

Soils data provided by USDA and NRCS.

©2023 AgriData, Inc.

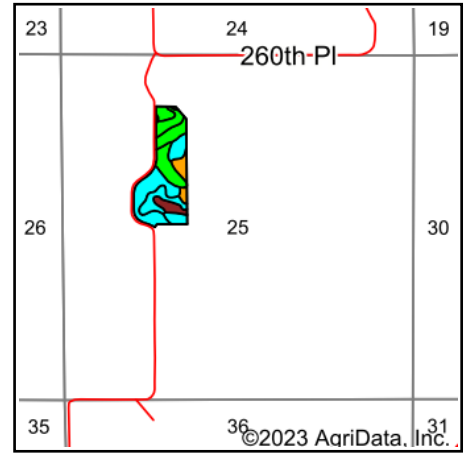

State: **Iowa**  
 County: **Monroe**  
 Location: **25-71N-17W**  
 Township: **Monroe**  
 Acres: **24.69**  
 Date: **4/14/2023**

**Hawkeye Farm Mgmt & Real Estate**



22 N Main, Albion IA Phone: 641-932-7796  
 Email: hawkeye@uciowa.com  
 On the web: www.uciowa.com  
 www.iowawhitetailfarms.com

Maps Provided By:



Area Symbol: IA135, Soil Area Version: 30

Code	Soil Description	Acres	Percent of field	CSR2 Legend	Non-Irr Class *c	CSR2**	CSR	*n NCCPI Soybeans
65G	Lindley loam, 18 to 40 percent slopes	8.30	33.6%		Vlle	6	5	12
S133B	Colo silty clay loam, heavy till, 2 to 5 percent slopes, rarely flooded	3.37	13.6%		IIlw	80		83
425D2	Keswick loam, 9 to 14 percent slopes, moderately eroded	2.82	11.4%		IVe	9	12	36
S484	Lawson silt loam, heavy till, 0 to 2 percent slopes, occasionally flooded	2.23	9.0%		IIlw	86		93
65E	Lindley loam, 14 to 18 percent slopes	1.98	8.0%		Vlle	33	30	60
S51	Vesser silt loam, 0 to 2 percent slopes, occasionally flooded	1.86	7.5%		IIlw	75		94
732C2	Weller silty clay loam, 5 to 9 percent slopes, moderately eroded	1.59	6.4%		IIIle	59	40	67
424E2	Lindley-Keswick loams, 14 to 18 percent slopes, moderately eroded	1.25	5.1%		Vlle	24	5	45
S54	Zook silty clay loam, heavy till, 0 to 2 percent slopes, occasionally flooded	1.13	4.6%		IIlw	68		68
58E2	Douds loam, heavy loess, 14 to 18 percent slopes, moderately eroded	0.09	0.4%		Vlle	34	18	57
716	Lawson-Quiver-Nodaway complex, 0 to 2 percent slopes, occasionally flooded	0.07	0.3%		IIlw	78		86
Weighted Average					4.51	38.5	*-	*n 49.9

\*\*IA has updated the CSR values for each county to CSR2.

\*- CSR weighted average cannot be calculated on the current soils data, use prior data version for csr values.

\*n: The aggregation method is "Weighted Average using all components"

\*c: Using Capabilities Class Dominant Condition Aggregation Method

Soils data provided by USDA and NRCS.