

APPENDIX B
FORM FOR FINAL PLAT CERTIFICATION

STATE OF TENNESSEE
COUNTY OF CLAIPOUR

12-2-98

12-3

12-3

12-3

NOTE:
IRON PINS SET AT LOT CORNERS
SET BACK LINES

All buildings must conform to the set back lines in this subdivision which are: No buildings shall be built closer than 30 ft. from the front lot line. No building shall be built closer than 15 ft. from the side lot line and rear lot line. UNLESS OTHERWISE NOTED

There is reserved a 10 ft. utility easement on all lot lines.

Amended declaration of Covenants
recorded 10-19-99
BK 1024 p 609

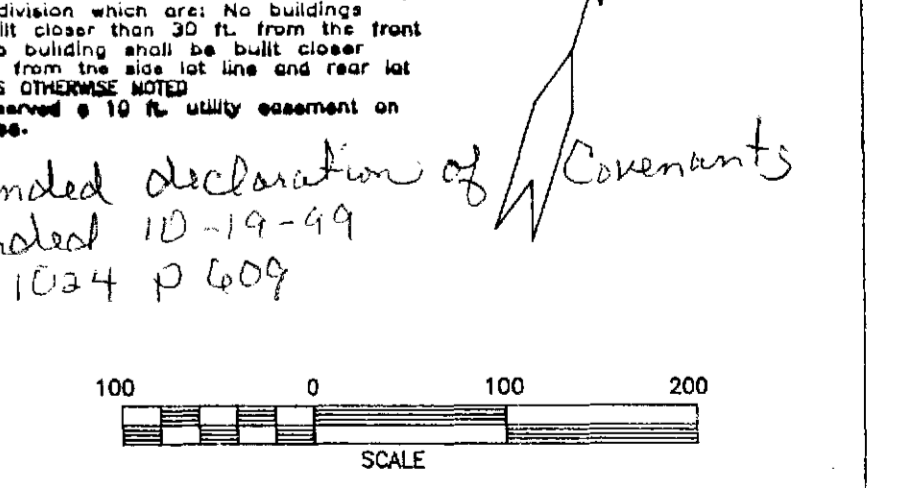

Warranty Deed Ref 250-542

SCALE: 1"=100'

DATE: 8/3/98

DISTRICT NO. 3

CLAIPOUR COUNTY, TENNESSEE

APPROVED BY: WILLIAM L. PARSONS

DRAWN BY: J. EVANS

REVISOR: 11/30/98

DRAWING NUMBER: LAF-1

"Approval is hereby granted for lots 68-71, 85, and 87-90 defined as Lone Mountain Shores Phase II, in Claiborne County, Tennessee as being suitable for subsurface sewage disposal (SSD) with the listed or attached restrictions."

Prior to any construction of a structure, mobile or permanent, the plans for the exact house/structure location must be approved and an SSD system permit issued by the Division of Ground Water Protection. Water taps, water lines, underground utilities and driveways should be located at the side property lines unless otherwise noted. Any cutting, filling or alterations of the soil conditions may void this approval."

Environmental Specialist
Date: 12-2-98

Lots 68-70, 85, 87, 88, 90 are approved for a standard individual subsurface sewage disposal system (SSD), serving 3 bedrooms.
Lot 71 serving 2 bedrooms.
Lot 86 is not approved for a SSD system.

- The following restrictions are applicable to all lots:
- (1) A scaled site plan, showing the initial and duplicate SSD systems, house location and design, well location, driveways and utilities is required, and may impact the actual number of bedrooms for which a permit may be issued.
 - (2) A 50 foot setback from any well, main road cutbanks and the SSD system.
 - (3) Surface water protection is required above all drainfields.
 - (4) The shaded area on lot 68, 69, 71 and 87 is reserved for field line use only, any disturbance in this area, may void the approval.
 - (5) The area designated as "fill line area", has been surveyed and as shown on the final plat is to be used for field line construction.

LOT 68

2288-2083 S 46°27'42" E	117.05'
2083-2084 S 07°51'50" E	75.30'
2084-2085 N 72°17'27" E	37.30'
2085-2086 N 27°18'23" E	26.77'
2086-2087 N 0°23'17" E	151.42'
2087-2088 N 13°38'24" E	60.18'
2088-2089 N 33°43'41" E	36.80'
2089-2090 N 71°08'44" E	18.45'
2090-2281 S 78°37'52" E	20.00'
2281-1422 S 12°27'13" E	382.58'
1422-1424 S 65°30'33" E	85.84'
1424-1425 S 81°19'21" W	80.49'
1425-1424 S 87°58'31" W	97.54'
1424-1423 S 83°32'57" W	84.01'
1423-1422 S 78°52'13" W	58.48'
1422-2310 S 59°48'38" W	25.82'
2310-2422 N 11°04'28" W	399.68'
2422-2288 N 11°04'28" W	103.71'

LOT 87

1935-1803 N 0°45'56" E	218.62'
1803-1804 N 47°15'11" E	80.24'
1804-2292 N 37°58'09" E	50.80'
2292-2383 N 40°41'22" E	50.50'
2383-2384 N 40°28'13" E	20.73'
2384-2385 N 25°51'51" E	26.12'
2385-2386 N 18°30'21" E	24.90'
2386-2387 N 10°28'28" E	24.32'
2387-2388 N 69°23'38" E	13.57'
2388-2389 N 44°17'47" E	40.58'
2389-2390 N 73°02'21" E	40.84'
2390-2391 S 78°30'35" E	23.80'
2391-1778 N 81°41'08" E	31.82'
1778-2492 N 81°41'08" E	496.50'
2492-2493 S 38°37'28" E	31.31'
2493-2494 N 50°12'50" E	27.81'
2494-2495 N 54°12'08" E	51.10'
2495-2496 N 38°50'22" E	41.21'
2496-2497 S 78°54'08" E	496.50'
2497-2498 S 71°48'22" E	230.00'
2498-2187 S 18°15'48" E	444.39'
2187-2188 N 78°37'52" E	28.89'
2188-2251 S 71°06'44" E	32.55'
2251-2252 N 48°51'00" E	87.73'
2252-2253 N 33°30'01" E	16.38'
2253-1805 N 17°37'22" E	69.22'

LOT 88

322-583 N 47°27'13" E	82.43'
583-584 N 28°51'20" E	87.54'
584-585 N 25°38'13" E	47.98'
585-586 N 34°32'44" E	83.19'
586-587 N 45°25'58" E	61.88'
587-588 N 63°23'52" E	78.07'
588-589 N 45°28'40" E	71.32'
589-590 N 38°14'22" E	82.23'
590-591 N 52°28'40" E	53.00'
591-592 N 78°53'15" E	88.58'
592-593 S 88°10'38" E	82.72'
593-594 S 82°07'37" E	72.10'
594-595 N 56°19'48" E	105.12'
595-596 N 68°54'23" E	100.27'
596-597 N 48°54'20" E	60.24'
597-598 N 43°31'10" E	60.75'
598-599 N 87°53'10" E	38.51'
599-600 S 82°05'08" E	64.43'
600-601 S 56°42'38" E	55.84'
601-602 S 38°37'28" E	81.49'
602-603 S 82°37'00" E	74.70'
603-572 S 81°10'09" E	74.85'
572-573 S 82°31'58" E	84.30'
573-574 S 82°31'58" E	84.30'
574-575 N 86°43'28" E	38.14'
575-576 S 87°20'54" E	40.81'
576-1816 N 82°31'01" E	48.59'
1816-1450 S 22°08'45" W	33.14'
1450-1451 S 27°01'30" W	32.07'
1451-1452 S 25°18'10" W	48.27'
1452-1453 S 81°19'11" W	78.23'
1453-1454 S 71°14'42" W	64.82'
1454-1455 S 10°42'24" W	83.88'
1455-1456 S 22°54'48" W	49.35'
1456-1457 S 22°54'48" W	28.80'
1457-1458 S 48°30'11" E	117.08'
1458-1459 S 80°07'57" E	530.00'
1459-2088 N 78°58'09" E	488.80'
2088-2388 S 12°08'00" E	38.28'
2388-2389 S 38°50'22" E	51.10'
2389-2390 S 50°02'58" E	27.81'
2390-2391 S 73°02'21" E	40.84'
2391-2392 S 87°17'47" E	40.58'
2392-2393 S 82°37'52" E	13.57'
2393-2394 S 15°28'38" E	24.32'
2394-2395 S 18°35'21" E	24.88'
2395-2396 S 45°19'02" W	40.00'
2396-2397 S 74°56'10" E	125.04'
2397-2398 S 81°19'11" E	85.88'
2398-2399 S 87°20'54" E	87.73'
2399-2400 S 82°37'00" E	74.70'
2400-2401 S 78°37'52" E	28.89'
2401-2402 S 71°06'44" E	32.55'
2402-2403 S 48°51'00" E	87.73'
2403-2404 S 33°30'01" E	16.38'
2404-2405 S 17°37'22" E	69.22'

LOT 69

LOT 65 FILL LINE AREA

2281-2081 S 78°37'52" E	16.43'
2081-2082 S 08°48'00" E	112.52'
2082-2083 S 52°12'42" E	143.15'
2083-2084 S 73°24'15" E	78.28'
2084-2085 N 70°45'38" E	52.54'
2085-2260 N 49°24'43" E	72.01'

885.506 50 FT

LOT 85 FILL LINE AREA

2199-2778 N 48°18'18" E	145.18'
2778-2779 S 87°48'10" E	43.53'
2779-2778 S 52°48'18" E	81.38'
2778-2778 S 38°48'18" E	47.79'
2778-2777 N 18°14'44" E	38.28'
2777-2778 N 81°02'11" E	52.79'
2778-2774 N 47°34'34" E	55.87'
2774-2773 N 81°37'20" E	80.11'
2773-2772 S 43°28'58" E	37.19'

LOT 89

2178-200 N 25°40'54" E	887.00'
887-200 N 80°02'11" E	53.53'
200-2259 N 47°32'13" E	18.89'
2259-2328 S 12°08'00" E	38.28'
2328-2327 S 22°57'02" E	47.88'
2327-2328 S 53°28'03" E	38.87'
2328-2325 S 78°52'44" E	78.41'
2325-2324 S 74°22'54" E	49.11'
2324-2323 S 48°08'24" E	59.82'
2323-2322 S 74°56'10" E	38.81'
2322-2321 N 81°01'41" E	46.88'
2321-1787 S 87°44'52" E	38.84'
1787-1788 N 78°30'52" E	8.17'
1788-1789 S 73°05'21" E	20.82'
1789-1800 S 45°17'41" E	61.81'
1800-2405 S 18°35'21" E	31.63'
2405-2404 S 40°28'12" E	34.48'
2404-2403 S 40°28'12" E	25.83'
2403-2402 S 40°11'57" E	48.83'
2402-2401 S 37°58'09" E	53.29'
2401-1805 S 47°15'51" E	85.88'
1805-2291 S 0°45'56" E	188.04'
2291-2285 S 31°41'11" E	63.44'
2285-2386 S 24°51'11" E	58.04'
2386-2385 S 24°51'11" E	58.04'
2385-2384 S 24°51'11" E	58.04'
2384-2383 S 24°51'11" E	58.04'
2383-2382 S 24°51'11" E	58.04'
2382-2381 S 24°51'11" E	58.04'
2381-2380 S 24°51'11" E	58.04'
2380-2379 S 24°51'11" E	58.04'
2379-2378 S 24°51'11" E	58.04'
2378-2377 S 24°51'11" E	58.04'
2377-2376 S 24°51'11" E	58.04'
2376-2375 S 24°51'11" E	58.04'
2375-2374 S 24°51'11" E	58.04'
2374-2373 S 24°51'11" E	58.04'
2373-2372 S 24°51'11" E	58.04'
2372-2371 S 24°51'11" E	58.04'
2371-2370 S 24°51'11" E	58.04'
2370-2369 S 24°51'11" E	58.04'
2369-2368 S 24°51'11" E	58.04'
2368-2367 S 24°51'11" E	58.04'
2367-2366 S 24°51'11" E	58.04'
2366-2365 S 24°51'11" E	58.04'
2365-2364 S 24°51'11" E	58.04'
2364-2363 S 24°51'11" E	58.04'
2363-2362 S 24°51'11" E	58.04'
2362-2361 S 24°51'11" E	58.04'
2361-2360 S 24°51'11" E	58.04'
2360-2359 S 24°51'11" E	58.04'
2359-2358 S 24°51'11" E	58.04'
2358-2357 S 24°51'11" E	58.04'
2357-2356 S 24°51'11" E	58.04'
2356-2355 S 24°51'11" E	58.04'
2355-2354 S 24°51'11" E	58.04'
2354-2353 S 24°51'11" E	58.04'
2353-2352 S 24°51'11" E	58.04'
2352-2351 S 24°51'11" E	58.04'
2351-2350 S 24°51'11" E	58.04'
2350-2349 S 24°51'11" E	58.04'
2349-2348 S 24°51'11" E	58.04'
2348-2347 S 24°51'11" E	58.04'
2347-2346 S 24°51'11" E	58.04'
2346-2345 S 24°51'11" E	58.04'
2345-2344 S 24°51'11" E	58.04'
2344-2343 S 24°51'11" E	58.04'
2343-2342 S 24°51'11" E	58.04'
2342-2341 S 24°51'11" E	58.04'
2341-2340 S 24°51'11" E	58.04'
2340-2339 S 24°51'11" E	58.04'
2339-2338 S 24°51'11" E	58.04'
2338-2337 S 24°51'11" E	58.04'
2337-2336 S 24°51'11" E	58.04'
2336-2335 S 24°51'11" E	58.04'
2335-2334 S 24°51'11" E	58.04'
2334-2333 S 24°51'11" E	58.04'
2333-2332 S 24°51'11" E	58.04'
2332-2331 S 24°51'11" E	58.04'
2331-2330 S 24°51'11" E	58.04'
2330-2329 S 24°51'11" E	58.04'
2329-2328 S 24°51'11" E	58.04'
2328-2327 S 24°51'11" E	58.04'
2327-2326 S 24°51'11" E	58.04'
2326-2325 S 24°51'11" E	58.04'
2325-2324 S 24°51'11" E	58.04'
2324-2323 S 24°51'11" E	58.04'
2323-2322 S 24°51'11" E	58.04'
2322-2321 S 24°51'11" E	58.04'
2321-2320 S 24°51'11" E	58.04'
2320-2319 S 24°51'11" E	58.04'
2319-2318 S 24°51'11" E	58.04'
2318-2317 S 24°51'11" E	58.04'
2317-2316 S 24°51'11" E	58.04'
2316-2315 S 24°51'11" E	58.04'
2315-2314 S 24°51'11" E	58.04'
2314-2313 S 24°51'11" E	58.04'
2313-2312 S 24°51'11" E	58.04'
2312-2311 S 24°51'11" E	58.04'
2311-2310 S 24°51'11" E	58.04'
2310-2309 S 24°51'11" E	58.04'
2309-2308 S 24°51'11" E	58.04'
2308-2307 S 24°51'11" E	58.04'
2307-2306 S 24°51'11" E	58.04'
2306-2305 S 24°51'11" E	58.04'
2305-2304 S 24°51'11" E	58.04'
2304-2303 S 24°51'11" E	58.04'
2303-2302 S 24°51'11" E	58.04'
2302-2301 S 24°51'11" E	58.04'
2301-2300 S 24°51'11" E	58.04'
2300-2299 S 24°51'11" E	58.04'
2299-2298 S 24°51'11" E	58.04'
2298-2297 S 24°51'11" E	58.04'
2297-2296 S 24°51'11" E	58.04'
2296-2295 S 24°51'11" E	58.04'
2295-2294 S 24°51'11" E	58.04'
2294-2293 S 24°51'11" E	58.04'
2293-2292 S 24°51'11" E	58.04'
2292-2291 S 24°51'11" E	58.04'
2291-2290 S 24°51'11" E	58.04'
2290-2289 S 24°51'11" E	58.04'
2289-2288 S 24°51'11" E	58.04'
2288-2287 S 24°51'11" E	58.04'
2287-2286 S 24°51'11" E	58.04'
2286-2285 S 24°51'11" E	58.04'
2285-2284 S 24°51'11" E	58.04'
2284-2283 S 24°51'11" E	58.04'
2283-2282 S 24°51'11" E	58.04'
2282-2281 S 24°51'11" E	58.04'
2281-2280 S 24°51'11" E	58.04'
2280-2279 S 24°51'11" E	58.04'
2279-2278 S 24°51'11" E	58.04'
2278-2277 S 24°51'11" E	58.04'
2277-2276 S 24°51'11" E	58.04'
2276-2275 S 24°51'11" E	58.04'
2275-2274 S 24°51'11" E	58.04'
2274-2273 S 24°51'11" E	58.04'
2273-2272 S 24°51'11" E	58.04'
2272-2271 S 24°51'11" E	58.04'
2271-2270 S 24°51'11" E	58.04'
2270-2269 S 24°51'11" E	58.04'
2269-2268 S 24°51'11" E	58.04'
2268-2267 S 24°51'11" E	58.04'
2267-2266 S 24°51'11" E	58.04'
2266-2265 S 24°51'11" E	58.04'
2265-2264 S 24°51'11" E	58.04'
2264-2263 S 24°51'11" E	58.04'
2263-2262 S 24°51'11" E	58.04'