

Soils Map

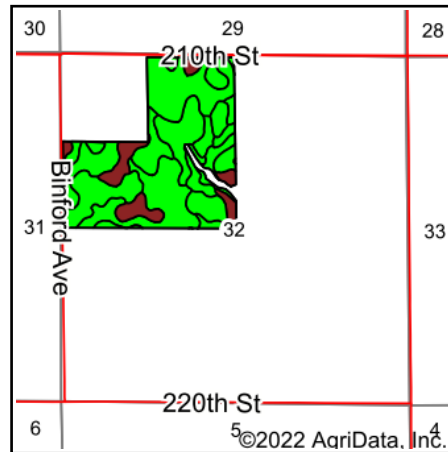
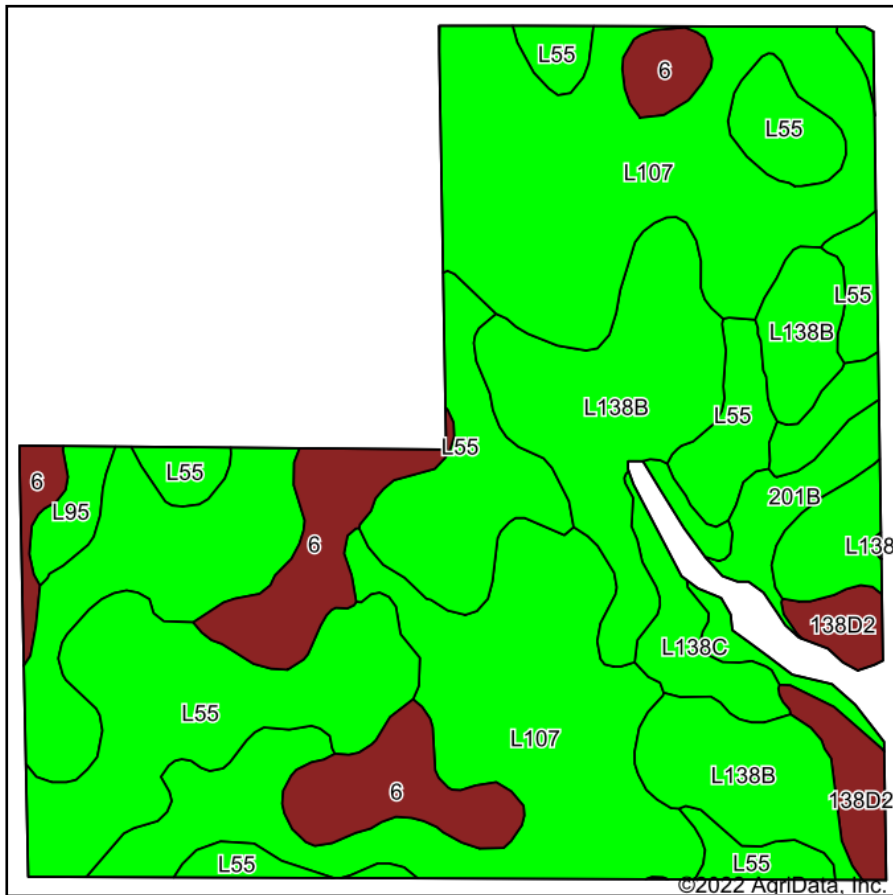

State: **Iowa**
 County: **Marshall**
 Location: **32-84N-20W**
 Township: **Minerva**
 Acres: **115.51**
 Date: **6/23/2022**

Hawkeye Farm Mgmt & Real Estate

United Country Real Estate
 22 N Main, Albia IA Phone: 641-932-7796
 Email: hawkeye@uciowa.com
 On the web: www.uciowa.com
 www.iowawhitetailfarms.com

Maps Provided By:

surety
 CUSTOMIZED ONLINE MAPPING
 © AgriData, Inc. 2021 www.AgriDataInc.com



Soils data provided by USDA and NRCS.

Area Symbol: IA127, Soil Area Version: 26

Code	Soil Description	Acres	Percent of field	CSR2 Legend	Non-Irr Class *c	CSR2**	CSR	*n NCCPI Soybeans	
L107	Webster clay loam, Bemis moraine, 0 to 2 percent slopes	46.77	40.5%		IIw	88		84	
L55	Nicollet loam, 1 to 3 percent slopes	26.76	23.2%		Ie	91		85	
L138B	Clarion loam, Bemis moraine, 2 to 6 percent slopes	17.40	15.1%		Ile	88		80	
6	Okoboji silty clay loam, 0 to 1 percent slopes	10.33	8.9%		IIIw	59	61	74	
L138C	Clarion loam, Bemis moraine, 6 to 10 percent slopes	6.56	5.7%		IIIe	84		77	
201B	Coland-Terril complex, 2 to 5 percent slopes	3.29	2.8%		IIw	75	67	85	
138D2	Clarion loam, 9 to 14 percent slopes, moderately eroded	3.07	2.7%		IIIe	56	58	63	
L95	Harps clay loam, Bemis moraine, 0 to 2 percent slopes	1.33	1.2%		IIw	75		80	
Weighted Average						1.94	84.5	*-	*n 81.8

**IA has updated the CSR values for each county to CSR2.

*- CSR weighted average cannot be calculated on the current soils data, use prior data version for csr values.

*n: The aggregation method is "Weighted Average using all components"

*c: Using Capabilities Class Dominant Condition Aggregation Method

Soils data provided by USDA and NRCS.