

Primary Barcode:

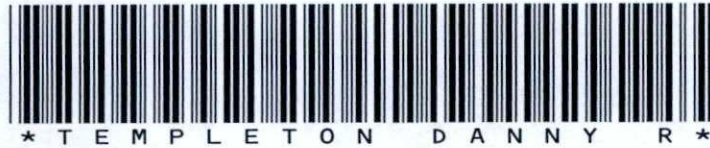

Property Owner:



Street Address:

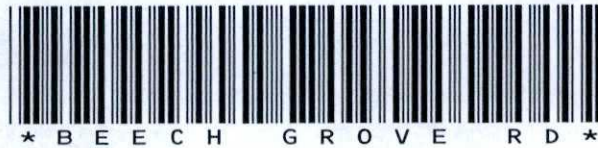

Zip Code:



Subdivision:



Lot Number:



Nearest Town:





TENNESSEE DEPARTMENT OF ENVIRONMENT AND CONSERVATION
APPLICATION FOR GROUND WATER PROTECTION SERVICES

1. SERVICE REQUESTED: (check service)	APPLICANT COMPLETE QUESTIONS:	FEES DUE	PERMITS CODES V689 Code Supp/Code
<input checked="" type="checkbox"/> Septic System Construction Permit			
<input checked="" type="checkbox"/> Dwelling	2, 3, 4, 7, 8, 9	\$ 100 ⁰⁰	78064 Yes
<input type="checkbox"/> Commercial: gpd _____	2, 3, 4, 7, 8, 9	\$ _____	78064 Yes
<input type="checkbox"/> System Modification _____	2, 3, 4, 7, 8, 9	\$ _____	78064 Yes
<input type="checkbox"/> Repair	2, 3, 4, 7, 8, 9	\$ _____	78032
<input type="checkbox"/> Inspection Letter	2, 3, 5, 7, 8, 9	\$ _____	78030
<input type="checkbox"/> Water Sample			
<input type="checkbox"/> Total Coliform	2, 3, 6, 7, 8, 9	\$ _____	78036 Yes
<input type="checkbox"/> Fecal Coliform	2, 3, 6, 7, 8, 9	\$ _____	78038 Yes
<input type="checkbox"/> Alternative System Permit*		\$ _____	78068
<input type="checkbox"/> Large Conventional System Plan Review*		\$ _____	78099
<input type="checkbox"/> Large Alternative System Plan Review*		\$ _____	78099
<input type="checkbox"/> Experimental System Plan Review*		\$ _____	78072
<input type="checkbox"/> Subdivision Evaluation: Lots: _____ *		\$ _____	78084
<input type="checkbox"/> Soil Mapping: Type _____ Acres _____ *		\$ _____	Yes
<input type="checkbox"/> Installer Permit: Type(s) _____ *		\$ _____	78026 Yes
<input type="checkbox"/> Pumper Permit*		\$ _____	78028

*Applicant may review these service requests with Environmental Specialist prior to processing application.

2. LANDOWNER: Danny R. Templeton APPLICANT: Same ORIGINAL OWNER: _____
Names: _____ Name: _____
Address: 1125 Fairview Ave. Address: _____
Kingsport TN 37660
Day Phone: 378-5741 Day Phone: _____

3. LOCATION OF LOT: a) In a subdivision? No b) Name: _____ Lot # _____
b) Non-Subdivision ☒ Give specific directions to the lot: Beech Grove Rd.

4. FOR SSDS PERMIT ONLY: a) Size of lot 2.7 acres b) Number of Bedrooms 3
c) How many occupants? _____ d) Excavated Basement? Yes _____ No _____
e) Basement Plumbing Fixtures? Yes _____ No _____
f) Amount of water used monthly (gallons) _____
g) Water Supply: Public _____ Well ☒ Spring _____
h) Is the lot staked? _____ If not, date it will be staked: _____
Is the house staked? _____ If not, date it will be staked: _____
i) Installer, if known: _____

5. FOR INSPECTION LETTER ONLY: Will pick up _____ Please mail _____
a) Age of house _____ b) Is house vacant? _____ How long? _____
c) Original sewage system inspected by Health Department? _____
d) Date of previous repairs _____ Inspected _____
e) Is waste water "backing up" into plumbing fixtures? _____ Surfacing on the ground? _____
f) All waste water including washing machines routed into septic tank _____

6. FOR WATER SAMPLE ONLY: a) Source of Supply: Spring _____ Well _____
b) Is there an outside faucet? _____ c) Is the source chlorinated? _____
d) For Wells: Is the casing 6" above the ground? _____ Is a sanitary seal on the casing? _____

7. MAKE A ROUGH SKETCH ON BACK OF THIS PAGE SHOWING DIRECTIONS TO PROPERTY, PROPERTY LINES, HOUSE SITE, WELL LOCATION, SPRING LOCATION, PLANNED DRIVEWAY AND UTILITIES.

8. ALL FEES DUE IN ADVANCE AND ARE NON-REFUNDABLE (except upon appeal). See Fee Schedule on reverse. Make check payable to: **TREASURER, STATE OF TENNESSEE**

9. I certify that the above information is true and correct to the best of my knowledge, and that I have been authorized by the above named landowner to submit this Application for Environmental Services to the Division of Ground Water Protection.

DATE: 6-4-93 SIGNATURE: Danny R. Templeton AMOUNT PAID: \$ 100⁰⁰ RECEIPT NUMBER 10729

needs ASAP*

CN-0971

Call B.4 Goin - so he can (Benny) meet you. 378-5056

FEE SCHEDULE

PFBMS
SUPP/CODE

Evaluation for Conventional or LDGP
Septic System Permit

\$100.00 up to 1000 gpd

\$ 50.00 for each additional 1000
gpd or portion thereof

78066

Repair
Inspection Letter
Subdivision Evaluation
Water Samples:
Total Coliform
Fecal Coliform

\$ None
\$100.00
\$ 20.00 per lot

78036P
78036P

Soil Mapping:
Low Intensity

General Intensity
High Intensity
Extra High Intensity
(Minimum is for each separate acre or part of
acre to be mapped)

\$ 65.00 up to 5 acres
\$ 10.00 per acre thereafter
\$ 40.00 per acre - \$ 40.00 minimum
\$ 65.00 per acre - \$ 65.00 minimum
\$100.00 per acre - \$100.00 minimum

78074
78076
78078
78040
78042

Alternative System Application Processing

\$150.00 up to 1000 gpd
\$ 75.00 for each
additional 1000 gpm
or portion thereof

78070

Large Conventional or Large Alternative Plan Review
Experimental System Application Processing
Pumper Permit
Installer Permit

\$300.00 per proposed system
\$250.00
\$100.00
\$100.00 for conventional & LDGP
\$ 50.00 for each alternative system

78080

SKETCH

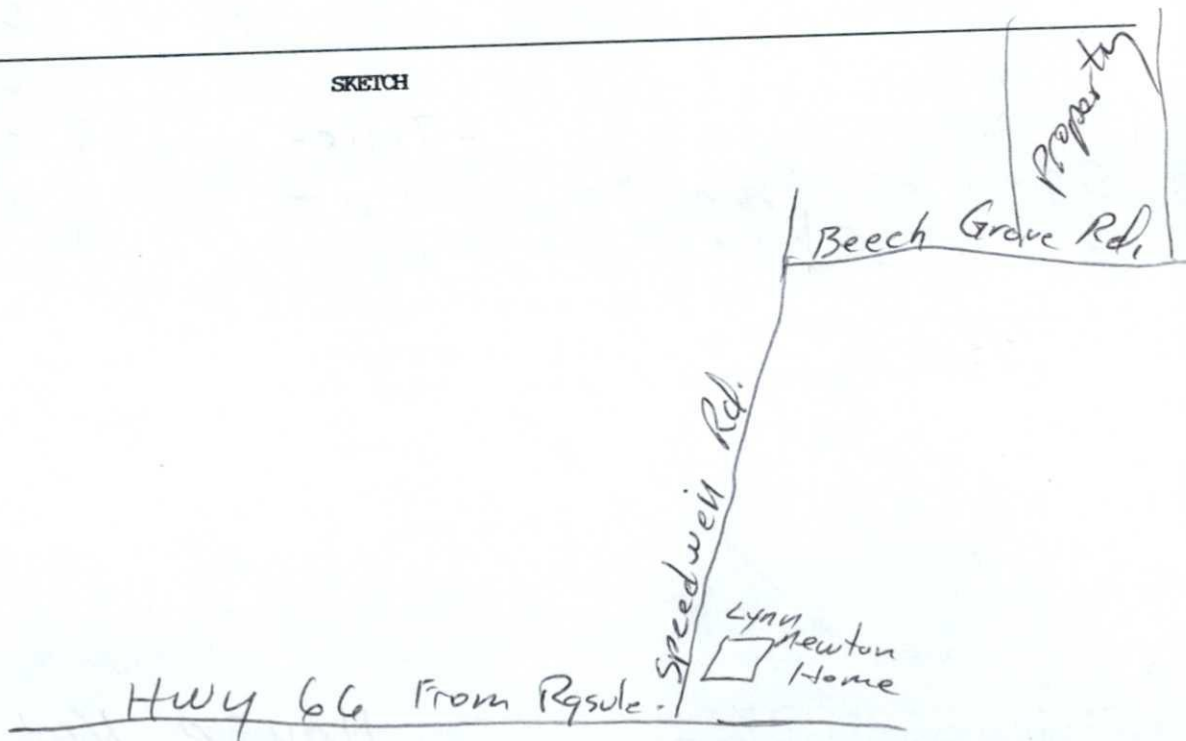

Official Use:

File Search

Absorption Rate _____ At Depth _____

Percolation Rate _____ At Depth _____

Other Requirements _____



TENNESSEE DEPARTMENT OF ENVIRONMENT AND CONSERVATION
CERTIFICATE OF COMPLETION OF SUBSURFACE SEWAGE DISPOSAL SYSTEM

Issued to: Templeton Danny R
Owner, Developer, Contractor, Installer, Etc.
Location: Beech Grove Rd.

Type of system
☒ 1. Conventional
☐ 2. Low Pressure Pipe
☐ 3. Mound
☐ 4. Lagoon
☐ 5. Large Diameter Gravelless Pipe
(a) Sand backfill required Yes () No ()
☐ 6. Other
TWO Comp 1000 Septic Tank
(type) (volume)
Estimated Absorption Rate 75
(minutes per inch)
☒ New Installation () Repair () Other
Installed by: Roger Golden

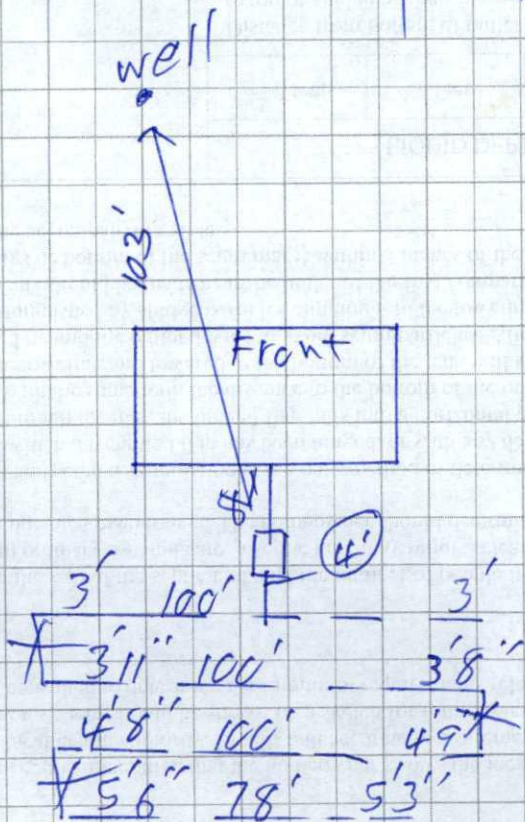
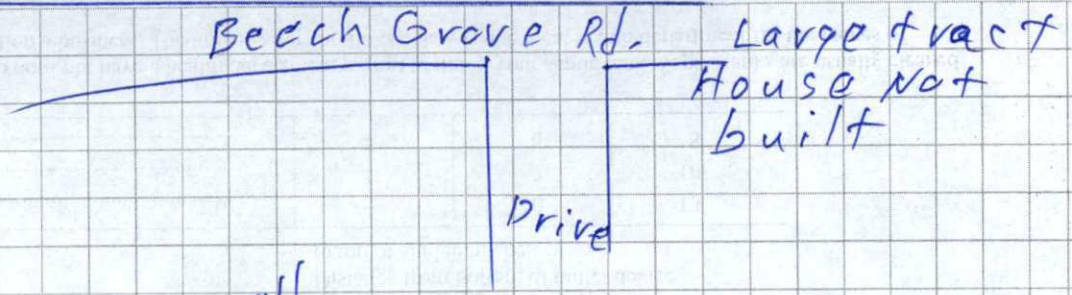

Duplication

Construction Approved By: Weiskell Stubbfield E.S. III (Name and Title) 6-30-95 (date)

**TENNESSEE DEPARTMENT OF ENVIRONMENT AND CONSERVATION
DIVISION OF GROUND WATER PROTECTION
PERMIT FOR CONSTRUCTION OF SUBSURFACE SEWAGE DISPOSAL SYSTEM**

Issued to: <u>Danny R. Templeton</u> <small>Owner, Developer, Contractor, Installer, Etc.</small> Location: <u>Beech Grove Rd</u> Installation: <u>Benny Boggs</u> <small>() 1. New Installation</small> <small>() 2. Repair to Existing System</small> Establishment: <u>378-5056</u> <small>() 1. Residential: # Bedrooms <u>3</u></small> <small>() 2. Other: _____ (specify)</small> Gal/Day _____	Evaluation Based Upon: <small>() 1. Soil typing by Soil Scientist</small> <small>() 2. Soil Percolation Test</small> <small>(X) 3. Environmental Specialist</small> Estimated Absorption Rate: <u>75</u> Minutes per inch Conventional Systems: Type of System: <small>(X) 1. Standard</small> <small>() 2. Alternating</small> <small>() 3. Chapter</small> <small>() 4. Other</small>	Permit Requirements Based Upon: <small>(X) 1. Soil Texture/Structure</small> <small>() 2. Soil Depth</small> <small>() 3. Soil Drainage</small> <small>() 4. Presence of Restrictive Layers</small> <small>() 5. Position</small> Alternative Systems: <small>() 1. Low Pressure Pipe</small> <small>() 2. Mound</small> <small>() 3. Lagoon</small> <small>() 4. Large diameter graveless pipe</small> <small>() 5. Other</small> See attached design package
---	--	---

This system shall consist of a two compartment septic tank holding 700 1000 gallons, with 370 linear feet in 4 trenches, 36 inches wide and 24 inches deep.

Also required:
() 1. Curtain Drain
() 2. Flow Diversion Valve
() 3. Sewage Pump
() 4. Other: _____

All installers of subsurface sewage disposal systems must hold a valid annual license from the Tennessee Department of Environment and Conservation.

The recipient of this permit agrees to construct or have constructed the above described system in accordance with 68-13-401 et. seq. and The Regulations To Govern Subsurface Sewage Disposal Systems. If any part of the system is covered before being inspected and approved, it shall be uncovered by the recipient of the permit at the direction of personnel of the Department of Environment and Conservation. Any cutting, filling or alterations of the soil conditions on the aforementioned property after this day may render this approval null and void.

Issued at _____ Date 6-17-93
(Signature of Recipient)
 By Heishel Stubblefield Tennessee, in Franklin County
(Name and Title) Date 6-17-93
(Date of Issue)

This permit is valid for 3 years from date of issue.

Notes

Stay 50' from well
 Restrict lines to 24"
 56 Ton 2 Rock
 Stay 25' from basement
 changed location
 of field bed 6-9-95
 stay 25' from driveway

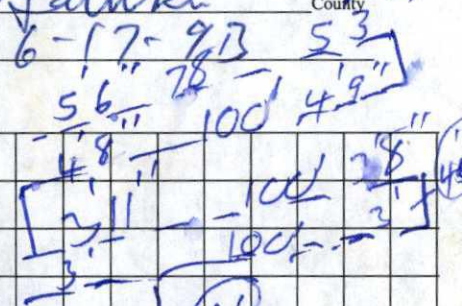

House Not built well

Beech Grove Road

* Crossover
 - - - Curtain Drain
 - - - Field Line
 - - - Solid Line

This is a permit to construct and is not intended to imply approval of any work proposed or completed on this lot.

Original—File
Copy—Owner

