

# Soils Map

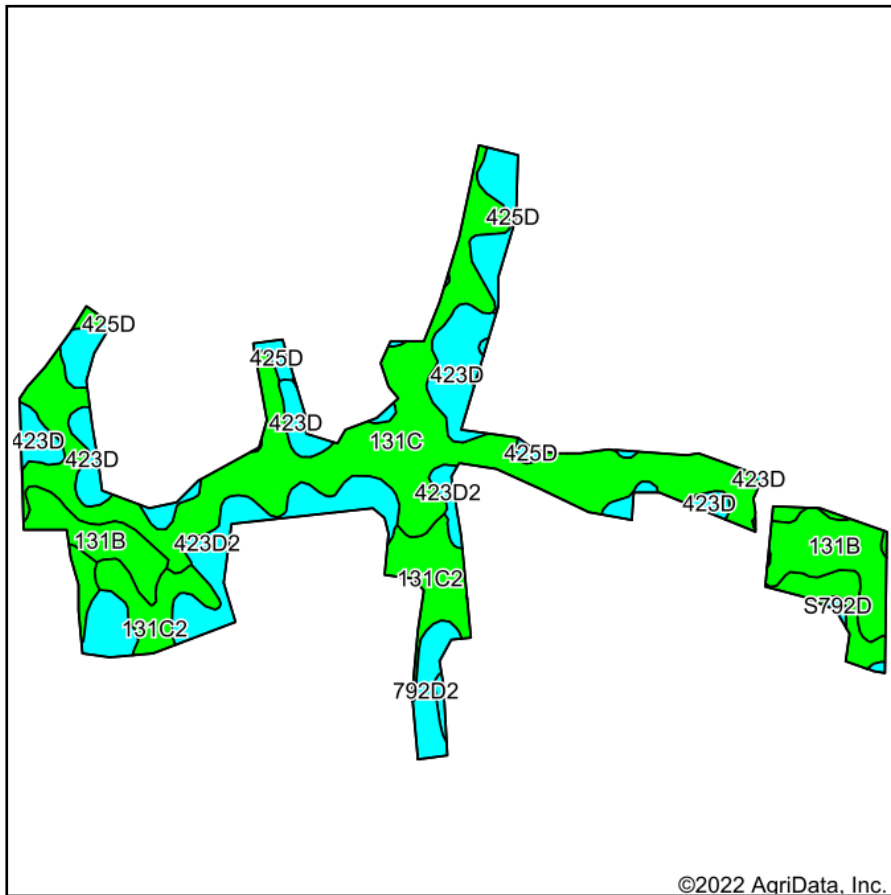

Soils data provided by USDA and NRCS.

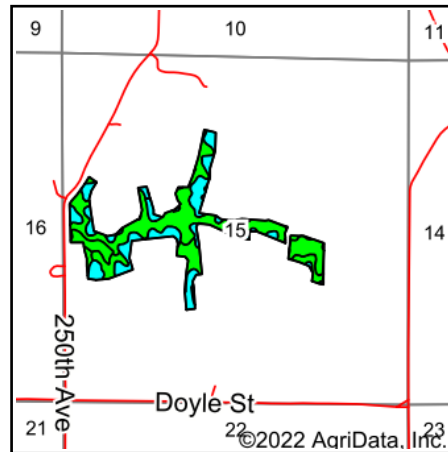

State: **Iowa**  
 County: **Clarke**  
 Location: **15-71N-25W**  
 Township: **Green Bay**  
 Acres: **52.69**  
 Date: **5/14/2022**

**Hawkeye Farm Mgmt & Real Estate**



22 N Main, Albia IA Phone: 641-932-7796  
 Email: hawkeye@uciowa.com  
 On the web: www.uciowa.com  
 www.iowawhitetailfarms.com

Maps Provided By:



© AgriData, Inc. 2021

www.AgriDataInc.com



Area Symbol: IA039, Soil Area Version: 27

| Code                    | Soil Description  | Acres | Percent of field | CSR2 Legend | Non-Irr Class *c | CSR2**      | CSR       | *n NCCPI Soybeans |                |
|-------------------------|---|-------|------------------|-------------|------------------|-------------|-----------|-------------------|----------------|
| 131C                    | Pershing silt loam, 5 to 9 percent slopes                           | 24.27 | 46.1%            |             | IIIe             | 65          | 49        | 59                |                |
| 423D                    | Bucknell silty clay loam, 9 to 14 percent slopes                    | 6.90  | 13.1%            |             | IVe              | 11          | 18        | 47                |                |
| 131B                    | Pershing silt loam, 2 to 5 percent slopes                           | 6.28  | 11.9%            |             | IIIe             | 70          | 67        | 60                |                |
| 423D2                   | Bucknell silty clay loam, 9 to 14 percent slopes, moderately eroded | 5.77  | 11.0%            |             | IVe              | 6           | 13        | 44                |                |
| 131C2                   | Pershing silty clay loam, 5 to 9 percent slopes, moderately eroded  | 5.06  | 9.6%             |             | IIIe             | 62          | 45        | 57                |                |
| 425D                    | Keswick loam, 9 to 14 percent slopes                                | 2.31  | 4.4%             |             | IVe              | 8           | 16        | 45                |                |
| 792D2                   | Armstrong clay loam, 9 to 14 percent slopes, moderately eroded      | 1.58  | 3.0%             |             | IVe              | 5           | 13        | 40                |                |
| S792D                   | Armstrong loam, 9 to 14 percent slopes                              | 0.21  | 0.4%             |             | IVe              | 10          |           | 51                |                |
| 179F2                   | Gara clay loam, 18 to 25 percent slopes, moderately eroded          | 0.20  | 0.4%             |             | IVe              | 11          | 8         | 35                |                |
| 65F                     | Lindley loam, 18 to 25 percent slopes                               | 0.11  | 0.2%             |             | VIIe             | 17          | 5         | 50                |                |
| <b>Weighted Average</b> |   |       |                  |             |                  | <b>3.33</b> | <b>47</b> | <b>*-</b>         | <b>*n 54.4</b> |

\*\*IA has updated the CSR values for each county to CSR2.

\*- CSR weighted average cannot be calculated on the current soils data, use prior data version for csr values.

\*n: The aggregation method is "Weighted Average using all components"

\*c: Using Capabilities Class Dominant Condition Aggregation Method

Soils data provided by USDA and NRCS.