

Soils Map

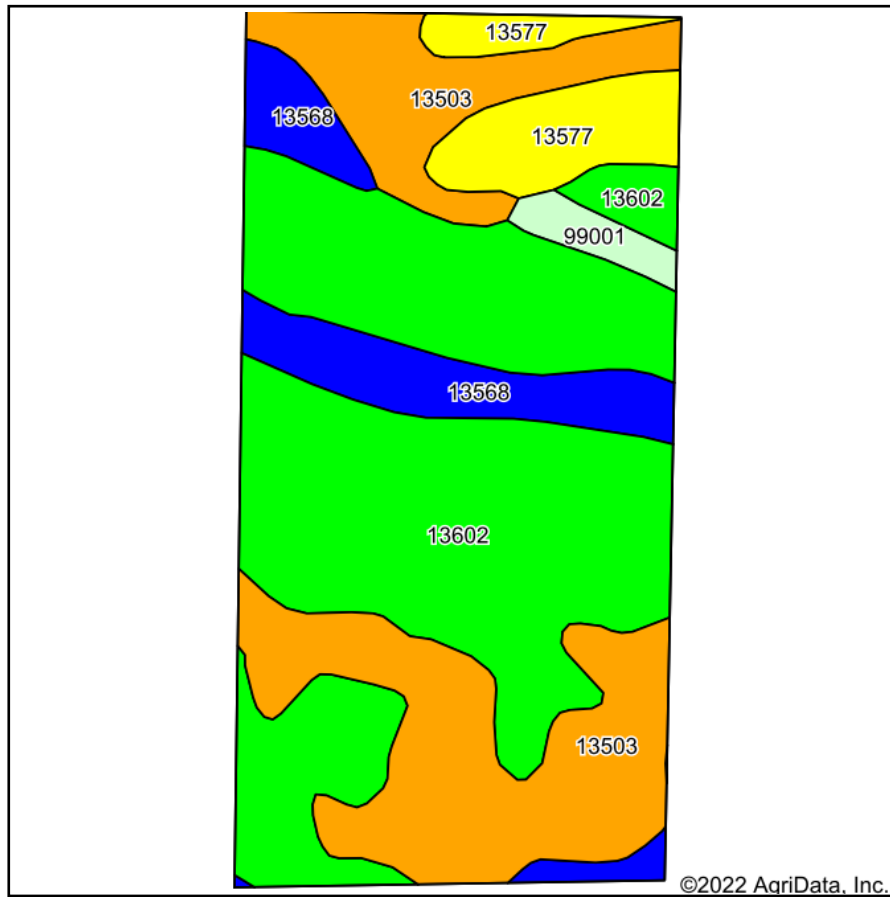

Soils data provided by USDA and NRCS.

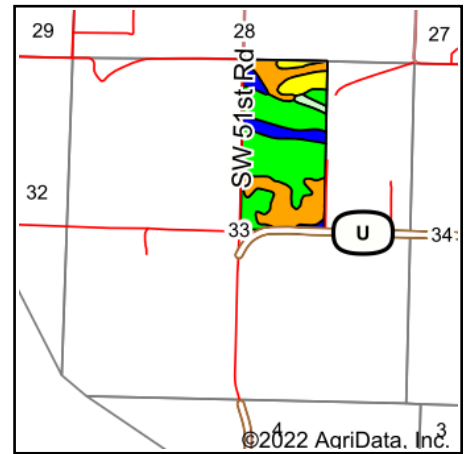

State: **Missouri**
 County: **Buchanan**
 Location: **33-57N-36W**
 Township: **Washington**
 Acres: **78.6**
 Date: **5/13/2022**

United Country
 Property
 Solutions, LLC

Maps Provided By:
surety
 CUSTOMIZED ONLINE MAPPING
 © AgriData, Inc. 2021 www.AgriDataInc.com



Area Symbol: MO021, Soil Area Version: 23

Code	Soil Description	Acres	Percent of field	Non-Irr Class Legend	Non-Irr Class *c	Irr Class *c	Alfalfa hay Tons	Caucasian bluestem Tons	Common bermudagrass Tons	Orchardgrass red clover Tons	Tall fescue Tons	Warm season grasses Tons	*n NCCPI Overall	*n NCCPI Corn	*n NCCPI Soybeans
13602	Haynie silt loam, 0 to 2 percent slopes, rarely flooded	40.52	51.6%		lw				7	8	8	10	69	64	6
13503	Albaton silty clay, 0 to 2 percent slopes, rarely flooded	22.28	28.3%		lllw				7	7	8	9	49	43	4
13568	Onawa silty clay, 0 to 2 percent slopes, rarely flooded	8.36	10.6%		llw	llw			7	7	8	9	65	58	6
13577	Sarpy loamy fine sand, 1 to 4 percent slopes, rarely flooded	5.98	7.6%		IVs		2	3	4	3	3	3	37	36	2
99001	Water	1.46	1.9%												
Weighted Average					1.88	0.21	0.2	0.2	6.6	7.1	7.5	8.9	*n 59.2	*n 54.1	*n 57

*n: The aggregation method is "Weighted Average using all components"

*c: Using Capabilities Class Dominant Condition Aggregation Method

Soils data provided by USDA and NRCS.