

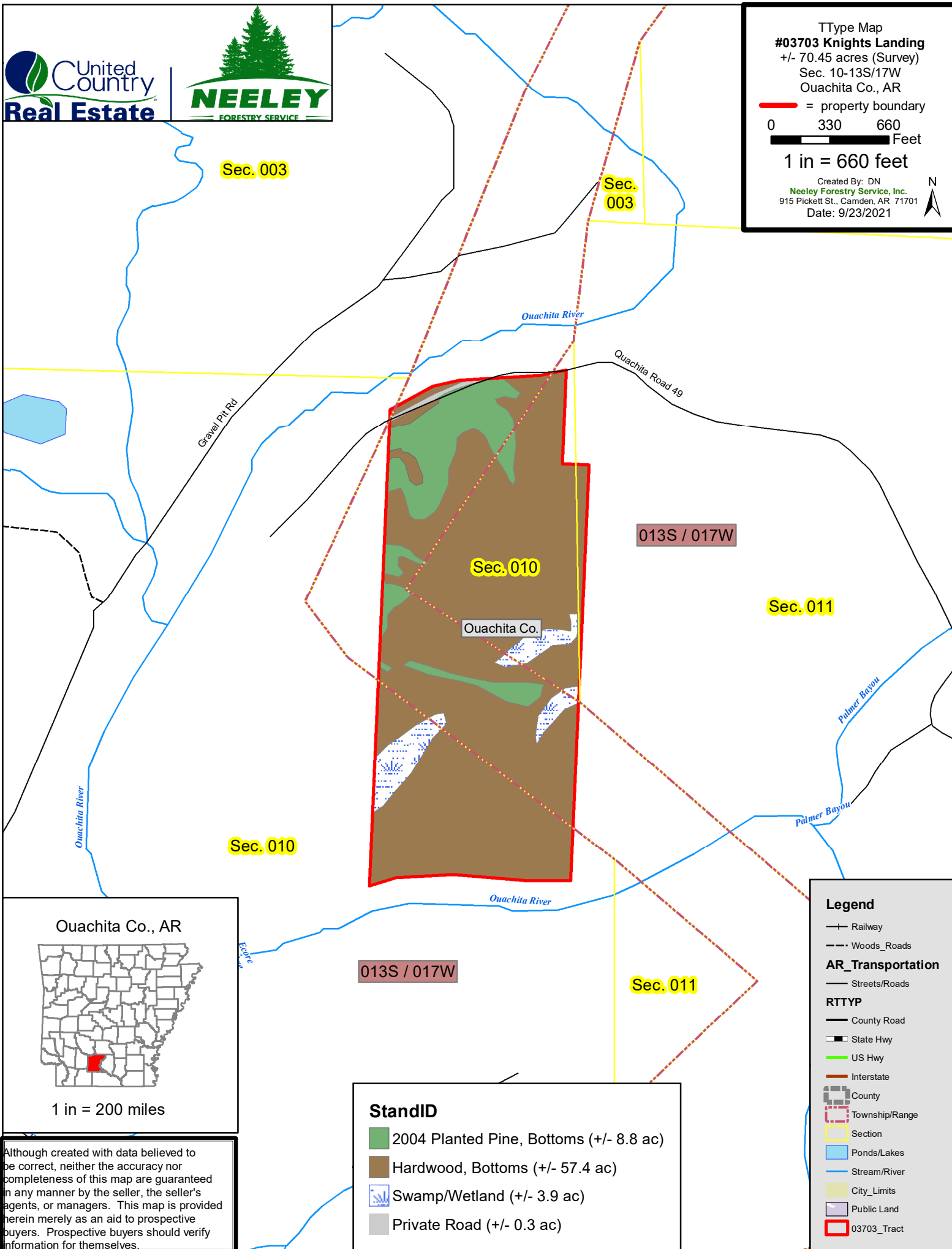

TType Map
#03703 Knights Landing
+/- 70.45 acres (Survey)
Sec. 10-13S/17W
Ouachita Co., AR
— = property boundary
0 330 660 Feet
1 in = 660 feet

Created By: DN
Neeley Forestry Service, Inc.
915 Pickett St., Camden, AR 71701
Date: 9/23/2021



Ouachita Co., AR

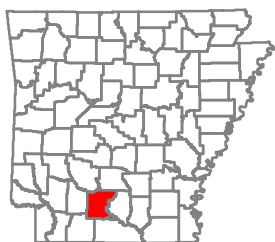

1 in = 200 miles

Although created with data believed to be correct, neither the accuracy nor completeness of this map are guaranteed in any manner by the seller, the seller's agents, or managers. This map is provided herein merely as an aid to prospective buyers. Prospective buyers should verify information for themselves.

StandID

- 2004 Planted Pine, Bottoms (+/- 8.8 ac)
- Hardwood, Bottoms (+/- 57.4 ac)
- Swamp/Wetland (+/- 3.9 ac)
- Private Road (+/- 0.3 ac)

Legend

- +— Railway
- - - Woods_Roads
- AR_Transportation**
- Streets/Roads
- RTTYP**
- County Road
- State Hwy
- US Hwy
- Interstate
- County
- Township/Range
- Section
- Ponds/Lakes
- Stream/River
- City_Limits
- Public Land
- 03703_Tract