

# Soils Map

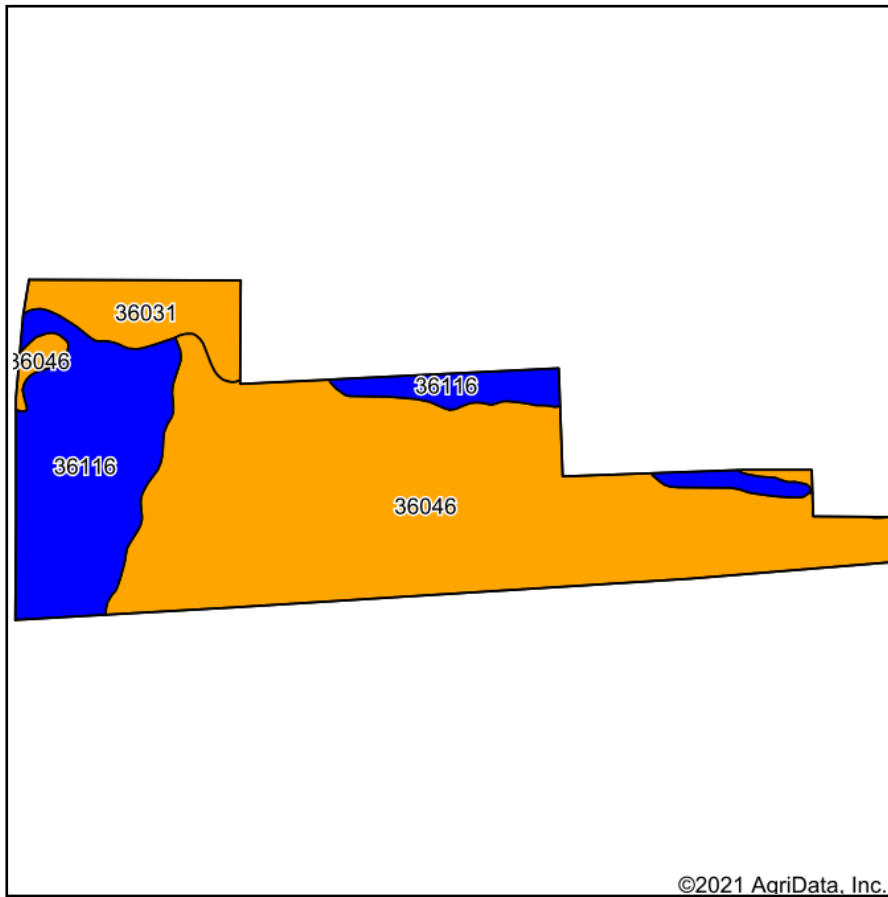

Soils data provided by USDA and NRCS.

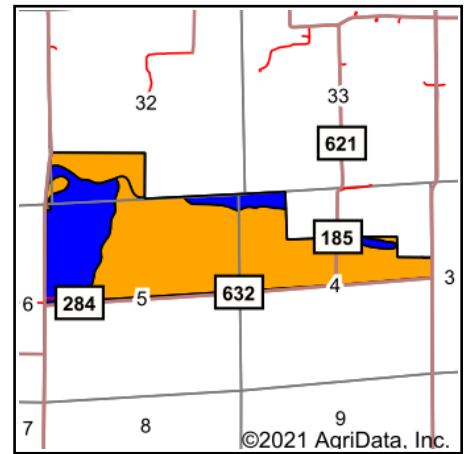

State: **Missouri**  
 County: **Carroll**  
 Location: **5-52N-24W**  
 Township: **Moss Creek**  
 Acres: **576.06**  
 Date: **9/7/2021**

**United Country**  
 Property  
 Solutions, LLC

Maps Provided By:

**surety**  
 CUSTOMIZED ONLINE MAPPING  
 © AgriData, Inc. 2021 www.AgriDataInc.com



Area Symbol: MO033, Soil Area Version: 23

Code	Soil Description	Acres	Percent of field	Non-Irr Class Legend	Non-Irr Class *c	Common bermudagrass	Orchardgrass red clover	Tall fescue	Warm season grasses	*n NCCPI Overall	*n NCCPI Corn	*n NCCPI Soybeans
36046	Wabash silty clay, 0 to 2 percent slopes, occasionally flooded	384.20	66.7%		IIIw					60	60	49
36116	Zook silty clay loam, heavy till, 0 to 2 percent slopes, occasionally flooded	147.18	25.5%		IIw					74	74	68
36031	Nodaway silt loam, 0 to 2 percent slopes, frequently flooded	44.68	7.8%		IIIw	7	9	8	10	62	61	49
<b>Weighted Average</b>						<b>0.5</b>	<b>0.7</b>	<b>0.6</b>	<b>0.8</b>	<b>*n 63.7</b>	<b>*n 63.7</b>	<b>*n 53.9</b>

\*n: The aggregation method is "Weighted Average using all components"

\*c: Using Capabilities Class Dominant Condition Aggregation Method

Soils data provided by USDA and NRCS.