

Soils Map

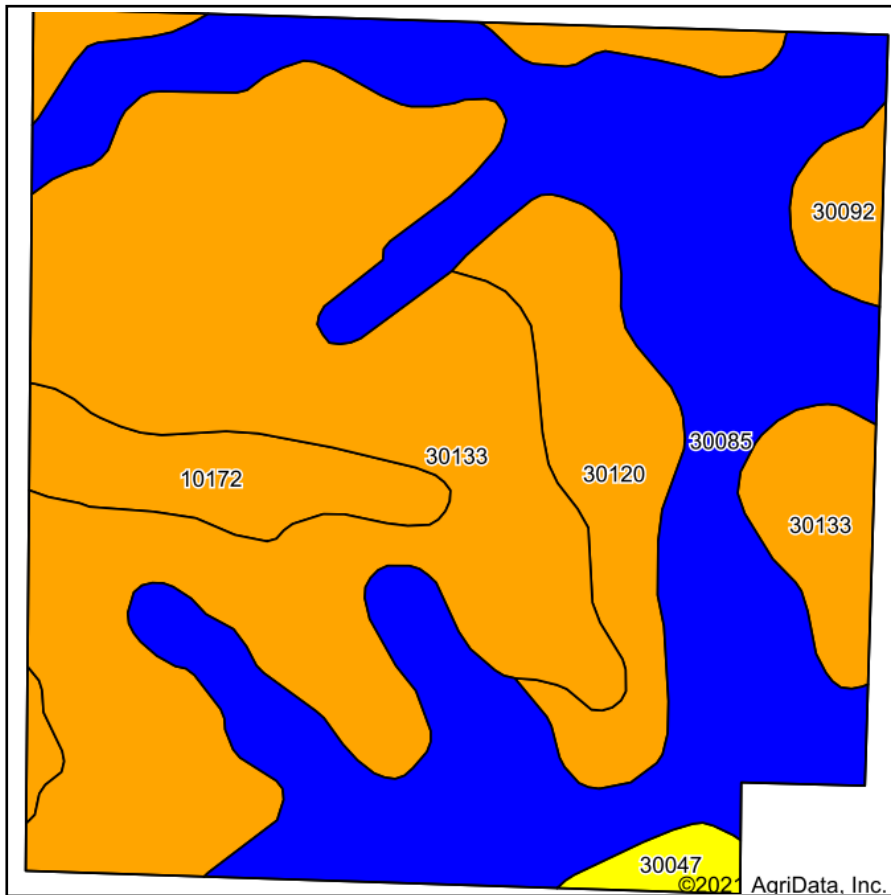

Soils data provided by USDA and NRCS.

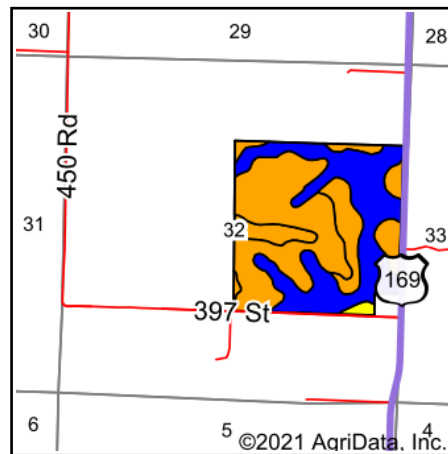

State: **Missouri**
 County: **Gentry**
 Location: **32-62N-32W**
 Township: **Jackson**
 Acres: **153.85**
 Date: **3/9/2021**

United Country
 Property Solutions, LLC

Maps Provided By:

surety
 CUSTOMIZED ONLINE MAPPING
 © AgriData, Inc. 2021 www.AgriDataInc.com



Area Symbol: MO075, Soil Area Version: 23

Code	Soil Description	Acres	Percent of field	Non-Irr Class Legend	Non-Irr Class *c	Alfalfa hay	Caucasian bluestem	Common bermudagrass	Orchardgrass red clover	Tall fescue	Warm season grasses	*n NCCPI Overall	*n NCC PI Corn	*n NCCPI Soybeans
30133	Lamoni clay loam, 5 to 9 percent slopes, moderately eroded	69.62	45.3%		IIIe							58	58	52
30085	Grundy silt loam, 2 to 5 percent slopes	58.98	38.3%		Ile							74	74	63
30120	Lagonda silty clay loam, 5 to 9 percent slopes, eroded	12.54	8.2%		IIIe	5	8	7	8	7	8	70	69	60
10172	Shelby clay loam, 9 to 14 percent slopes, moderately eroded	8.05	5.2%		IIIe							71	71	54
30092	Grundy silty clay loam, 5 to 9 percent slopes, moderately eroded	2.87	1.9%		IIIe							72	72	65
30047	Clarinda silty clay loam, 5 to 9 percent slopes, moderately eroded	1.79	1.2%		IVw							55	55	43



Weighted Average	0.4	0.7	0.6	0.7	0.6	0.7	*n 66	*n 65.9	*n 57.1
-------------------------	------------	------------	------------	------------	------------	------------	--------------	----------------	----------------

*n: The aggregation method is "Weighted Average using all components"

*c: Using Capabilities Class Dominant Condition Aggregation Method

Soils data provided by USDA and NRCS.