

# Soils Map

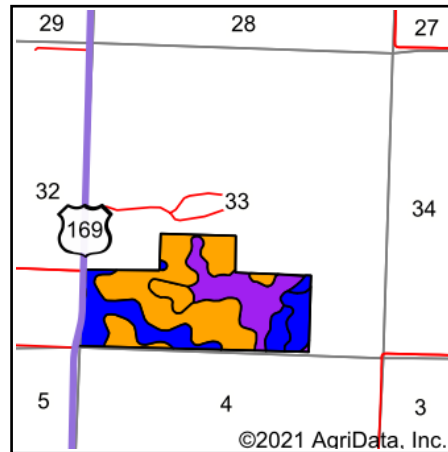
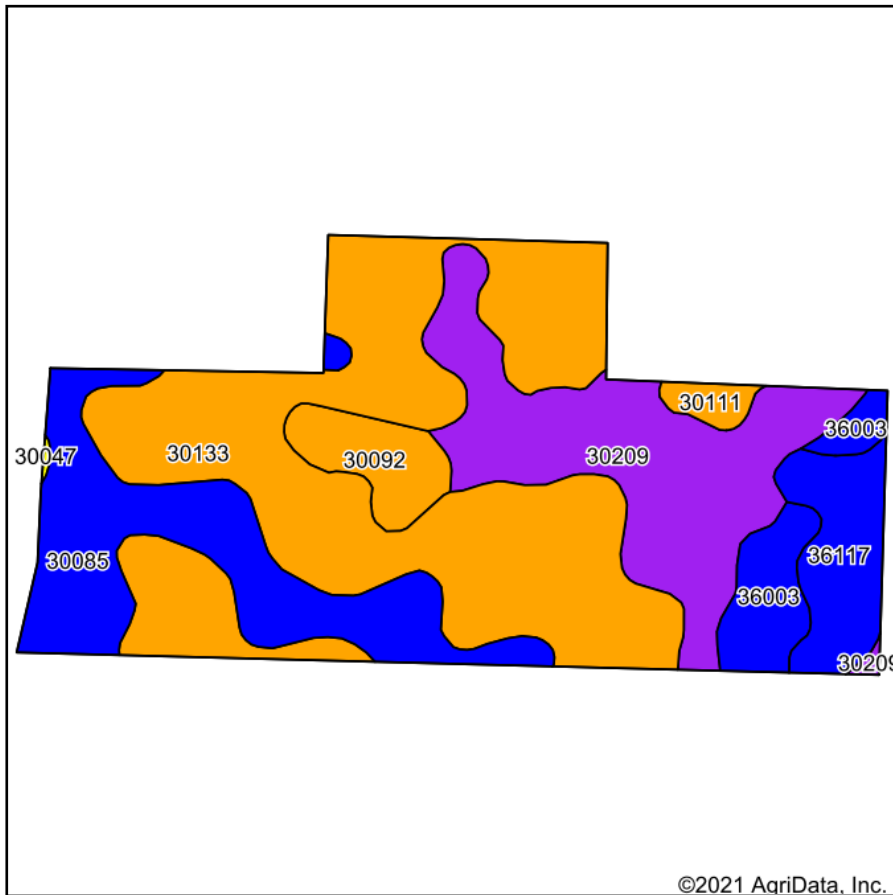

State: **Missouri**  
 County: **Gentry**  
 Location: **33-62N-32W**  
 Township: **Jackson**  
 Acres: **138.16**  
 Date: **3/9/2021**

**United Country**  
 Property Solutions, LLC

Maps Provided By:  
**surety**  
 CUSTOMIZED ONLINE MAPPING  
 © AgriData, Inc. 2021 www.AgriDataInc.com



Soils data provided by USDA and NRCS.

Area Symbol: MO075, Soil Area Version: 23

Code	Soil Description	Acres	Percent of field	Non-Irr Class Legend	Non-Irr Class *c	Alfalfa hay	Caucasian bluestem	Common bermudagrass	Orchardgrass red clover	Tall fescue	Warm season grasses	*n NCCPI Overall	*n NCC PI Corn	*n NCCPI Soybeans	
30133	Lamoni clay loam, 5 to 9 percent slopes, moderately eroded	62.23	45.0%		IIIe							58	58	52	
30209	Vanmeter flaggy silty clay loam, 14 to 40 percent slopes	28.38	20.5%		VIIe	4	7	4		6	5	7	10	10	4
30085	Grundy silt loam, 2 to 5 percent slopes	24.04	17.4%		Ile							74	74	63	
36117	Nodaway silt loam, heavy till, 0 to 2 percent slopes, occasionally flooded	8.88	6.4%		IIw							84	84	81	
36003	Arbela silt loam, 0 to 2 percent slopes, occasionally flooded	7.05	5.1%		IIw							88	88	78	
30092	Grundy silty clay loam, 5 to 9 percent slopes, moderately eroded	5.82	4.2%		IIIe							72	72	65	
30111	Ladoga silty clay loam, 5 to 9 percent slopes, eroded	1.65	1.2%		IIIe	5	8	7		8	7	8	85	85	65



30047	Clarinda silty clay loam, 5 to 9 percent slopes, moderately eroded	0.11	0.1%		IVw							55	55	43
<b>Weighted Average</b>						<b>0.9</b>	<b>1.5</b>	<b>0.9</b>	<b>1.3</b>	<b>1.1</b>	<b>1.5</b>	<b>*n 55</b>	<b>*n 55</b>	<b>*n 47.9</b>

\*n: The aggregation method is "Weighted Average using all components"

\*c: Using Capabilities Class Dominant Condition Aggregation Method

Soils data provided by USDA and NRCS.