

S-31-T46N-R04E CRDAUSTIN PASS DR

CRDAUSTIN  
KNOLL CT

Landgrant00016

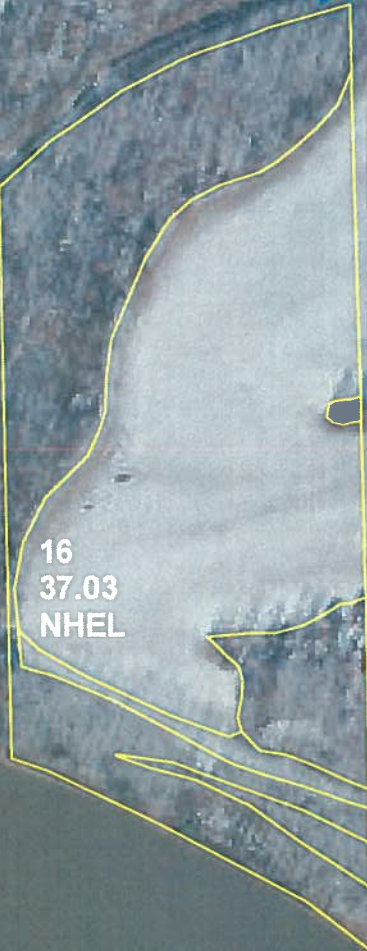

16  
37.03  
NHEL

S-32-T46N-R04E

S-6-T45N-R04E

S-5-T45N-R04E

**All Measurements are  
For FSA Programs Only**

**Wetland Determination Identifiers**

- Restricted Use
- ▼ Limited Restrictions
- Exempt from Conservation Compliance Provisions

Disclaimer: Wetland identifiers do not represent the size, shape or specific determination of the area. Refer to your original determination (CPA-026 and attached maps) for exact wetland boundaries and determinations, or contact NRCS.

**St Charles Co. FSA**

C=Com, YEL, GR; SRW=Wheat, SRW, GR  
SB=Soybn, COM, GR; MILO=Sorgh GRS, GR  
ALf=Alfalfa, FG; H=Mixfg, IGS, FG  
LS=Grass, FTA, LS; P=Grass, FTA, GZ  
CCC=Covrc, CEG, CO

\*Unless notated on Map

1:7,920



**Program Year: 2020**

Created: 9/19/2019

Flown: 2018-11-16

- clu
- crp
- plss

**Farm 4196  
Tract 3825**

Missouri  
St. Charles

U.S. Department of Agriculture  
Farm Service Agency  
**Abbreviated 156 Farm Record**

**FARM: 4196**  
Prepared: 4/13/20 1:24 PM  
Crop Year: 2020  
Page: 1 of 2

Report ID: FSA-156EZ

DISCLAIMER: This is data extracted from the web farm database. Because of potential messaging failures in MIDAS, this data is not guaranteed to be an accurate and complete representation of data contained in the MIDAS system, which is the system of record for Farm Records.

Operator Name: BONHOMME FARMS LLC  
Farm Identifier: DIV OF FARM #1802

Farms Associated with Operator:  
1791, 1835, 3076

ARC/PLC G//F Eligibility: Eligible

CRP Contract Number(s): None

Farmland	Cropland	DCP Cropland	WBP	WRP/EWP	CRP Cropland	GRP	Farm Status	Number of Tracts
74.62	37.03	37.03	0.0	0.0	0.0	0.0	Active	1
State Conservation	Other Conservation	Effective DCP Cropland	Double Cropped	MPL/FWP				
0.0	0.0	37.03	0.0	0.0				

ARC/PLC					
PLC	ARC-CO	ARC-IC	PLC-Default	ARC-CO-Default	ARC-IC-Default
WHEAT, CORN	SOYBN	NONE	NONE	NONE	NONE

Crop	Base Acreage	PLC Yield	CCC-505 CRP Reduction
WHEAT	3.8	33	0.0
CORN	18.5	125	0.0
SOYBEANS	14.6	46	0.0
<b>Total Base Acres:</b>	36.9		

Tract Number: 3825      Description: K11/1A SUR29 T46N R4E  
 FSA Physical Location: St. Charles, MO      ANSI Physical Location: St. Charles, MO  
 BIA Range Unit Number:  
 HEL Status: NHEL: no agricultural commodity planted on undetermined fields  
 Wetland Status: Tract contains a wetland or farmed wetland  
 WL Violations: None

Farmland	Cropland	DCP Cropland	WBP	WRP/EWP	CRP Cropland	GRP
74.62	37.03	37.03	0.0	0.0	0.0	0.0
State Conservation	Other Conservation	Effective DCP Cropland	Double Cropped	MPL/FWP		
0.0	0.0	37.03	0.0	0.0		

Crop	Base Acreage	PLC Yield	CCC-505 CRP Reduction
WHEAT	3.8	33	0.0
CORN	18.5	125	0.0
SOYBEANS	14.6	46	0.0

Missouri  
St. Charles

U.S. Department of Agriculture  
Farm Service Agency  
**Abbreviated 156 Farm Record**

Report ID: FSA-156EZ

**FARM: 4196**

Prepared: 4/13/20 1:24 PM

Crop Year: 2020

Page: 2 of 2

DISCLAIMER: This is data extracted from the web farm database. Because of potential messaging failures in MIDAS, this data is not guaranteed to be an accurate and complete representation of data contained in the MIDAS system, which is the system of record for Farm Records.

---

Crop	Base Acreage	PLC Yield	CCC-505 CRP Reduction
Total Base Acres:	36.9		

Owners: BURGART, RANDOLPH J

Other Producers: None

---