

# Soils Map

Boundary Lines Are Approximate

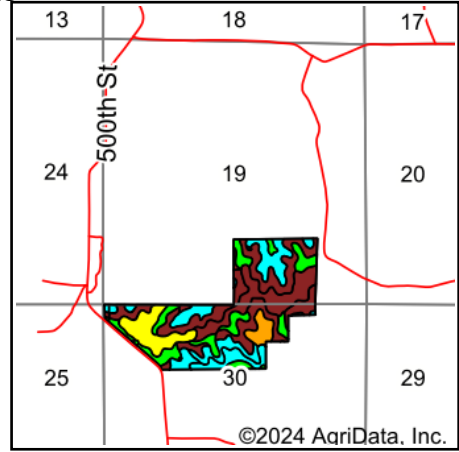
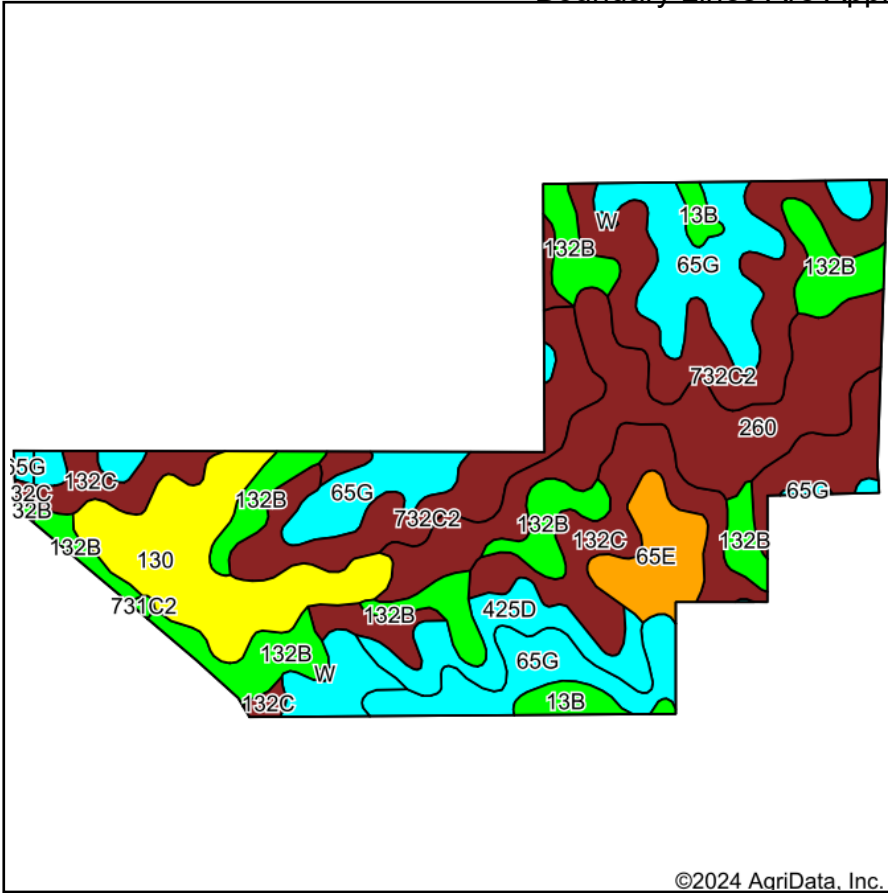

State: **Iowa**  
 County: **Monroe**  
 Location: **19-73N-19W**  
 Township: **Cedar**  
 Acres: **140**  
 Date: **9/18/2024**

**Hawkeye Farm Mgmt & Real Estate**

**United Country Real Estate**  
 22 N Main, Albia IA Phone: 641-932-7796  
 Email: hawkeye@uciowa.com  
 On the web: www.uciowa.com;  
 www.iowawhitealfarms.com

Maps Provided By:  
**surety**  
 CUSTOMIZED ONLINE MAPPING  
 © AgriData, Inc. 2023 www.AgriDataInc.com



Soils data provided by USDA and NRCS.

Area Symbol: IA117, Soil Area Version: 32  
 Area Symbol: IA135, Soil Area Version: 31

| Code                    | Soil Description   | Acres | Percent of field | CSR2 Legend | Non-Irr Class *c | CSR2**      | CSR         | *n NCCPI Corn  | *n NCCPI Soybeans |
|-------------------------|--|-------|------------------|-------------|------------------|-------------|-------------|----------------|-------------------|
| 732C2                   | Weller silty clay loam, 5 to 9 percent slopes, moderately eroded   | 23.62 | 17.0%            |             | IIIe             | 59          | 40          | 81             | 67                |
| 65G                     | Lindley loam, 18 to 40 percent slopes                              | 23.38 | 16.7%            |             | VIIe             | 6           | 5           | 21             | 11                |
| 132C                    | Weller silt loam, 5 to 9 percent slopes                            | 21.48 | 15.3%            |             | IIIe             | 59          | 44          | 85             | 73                |
| 260                     | Beckwith silt loam, 0 to 2 percent slopes                          | 20.18 | 14.4%            |             | IIIw             | 51          | 56          | 82             | 66                |
| 132B                    | Weller silt loam, 2 to 5 percent slopes                            | 19.04 | 13.6%            |             | IIIe             | 67          | 60          | 89             | 80                |
| 130                     | Belinda silt loam, 0 to 2 percent slopes                           | 14.07 | 10.0%            |             | IIIw             | 47          | 63          | 75             | 63                |
| 425D                    | Keswick loam, 9 to 14 percent slopes                               | 6.26  | 4.5%             |             | IVe              | 8           | 16          | 62             | 48                |
| 65E                     | Lindley loam, 14 to 18 percent slopes                              | 5.35  | 3.8%             |             | VIe              | 33          | 30          | 71             | 60                |
| 424E2                   | Lindley-Keswick loams, 14 to 18 percent slopes, moderately eroded  | 3.07  | 2.2%             |             | VIe              | 24          | 5           | 59             | 46                |
| 13B                     | Olmitz-Colo-Vesser complex, 2 to 5 percent slopes                  | 2.53  | 1.8%             |             | IIw              | 82          | 60          | 70             | 71                |
| 65G                     | Lindley loam, 25 to 40 percent slopes                              | 0.34  | 0.2%             |             | VIIe             | 7           | 5           | 19             | 10                |
| 132C                    | Weller silt loam, 5 to 9 percent slopes                            | 0.21  | 0.2%             |             | IIIe             | 59          | 44          | 85             | 73                |
| 731C2                   | Pershing silty clay loam, 5 to 9 percent slopes, moderately eroded | 0.19  | 0.1%             |             | IIIe             | 62          | 45          | 68             | 56                |
| W                       | Water  | 0.17  | 0.1%             |             |                  | 0           | 0           |                |                   |
| 132B                    | Weller silt loam, 2 to 5 percent slopes                            | 0.11  | 0.1%             |             | IIIe             | 67          | 60          | 89             | 80                |
| <b>Weighted Average</b> |  |       |                  |             | <b>*-</b>        | <b>45.1</b> | <b>40.1</b> | <b>*n 70.1</b> | <b>*n 58.1</b>    |

\*\*IA has updated the CSR values for each county to CSR2.

\*n: The aggregation method is "Weighted Average using all components"

\*c: Using Capabilities Class Dominant Condition Aggregation Method

\*- Non Irr Class weighted average cannot be calculated on the current soils data due to missing data.

Soils data provided by USDA and NRCS.