

# Soils Map

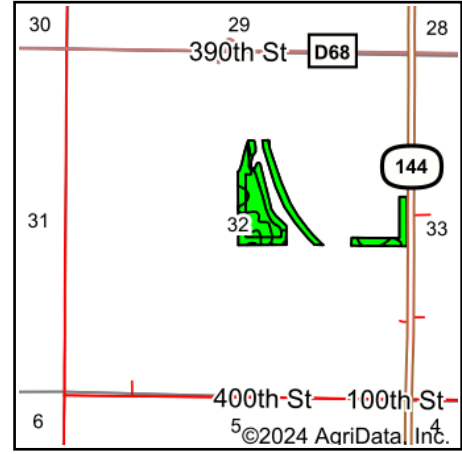
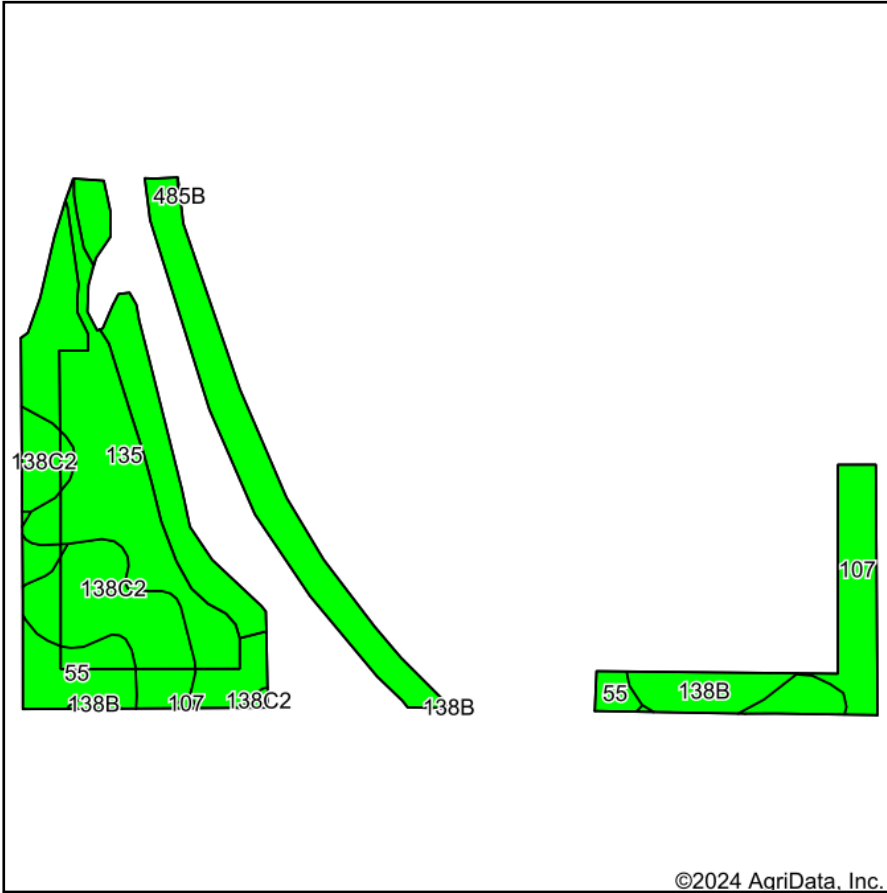

State: **Iowa**  
 County: **Webster**  
 Location: **32-86N-29W**  
 Township: **Lost Grove**  
 Acres: **24.58**  
 Date: **9/30/2024**

**Hawkeye Farm Mgmt & Real Estate**  
 22 N Main, Albia IA Phone: 641-932-7796  
 Email: hawkeye@uciowa.com  
 On the web: www.uciowa.com; www.iowawhitetailfarms.com

Maps Provided By:  
 **surety**  
 CUSTOMIZED ONLINE MAPPING  
 © AgriData, Inc. 2023 www.AgriDataInc.com



Soils data provided by USDA and NRCS.

©2024 AgriData, Inc.

Area Symbol: IA187, Soil Area Version: 40

Code	Soil Description	Acres	Percent of field	CSR2 Legend	Non-Irr Class *c	CSR2**	CSR	*n NCCPI Corn	*n NCCPI Soybeans	
135	Coland clay loam, 0 to 2 percent slopes, occasionally flooded	14.96	61.0%		llw	76	82	70	83	
138C2	Clarion loam, 6 to 10 percent slopes, moderately eroded	4.13	16.8%		llle	83	65	68	70	
55	Nicollet clay loam, 1 to 3 percent slopes	2.15	8.7%		lw	89	90	81	81	
107	Webster clay loam, 0 to 2 percent slopes	2.10	8.5%		llw	86	82	78	82	
138B	Clarion loam, 2 to 6 percent slopes	1.24	5.0%		lle	89	82	78	83	
<b>Weighted Average</b>						<b>2.08</b>	<b>79.8</b>	<b>79.8</b>	<b>*n 71.7</b>	<b>*n 80.6</b>

\*\*IA has updated the CSR values for each county to CSR2.

\*n: The aggregation method is "Weighted Average using all components"

\*c: Using Capabilities Class Dominant Condition Aggregation Method

Soils data provided by USDA and NRCS.