

Soils Map

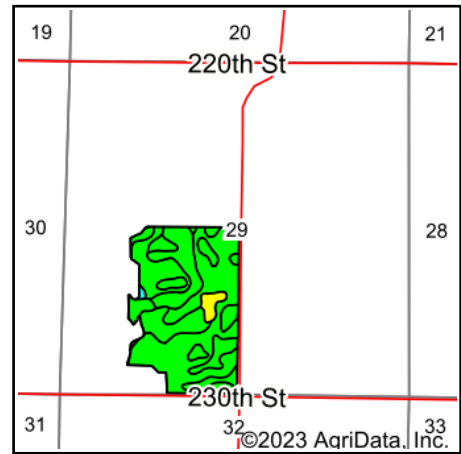

State: **Iowa**
 County: **Dallas**
 Location: **29-80N-29W**
 Township: **Lincoln**
 Acres: **92.8**
 Date: **5/31/2023**

Hawkeye Farm Mgmt & Real Estate

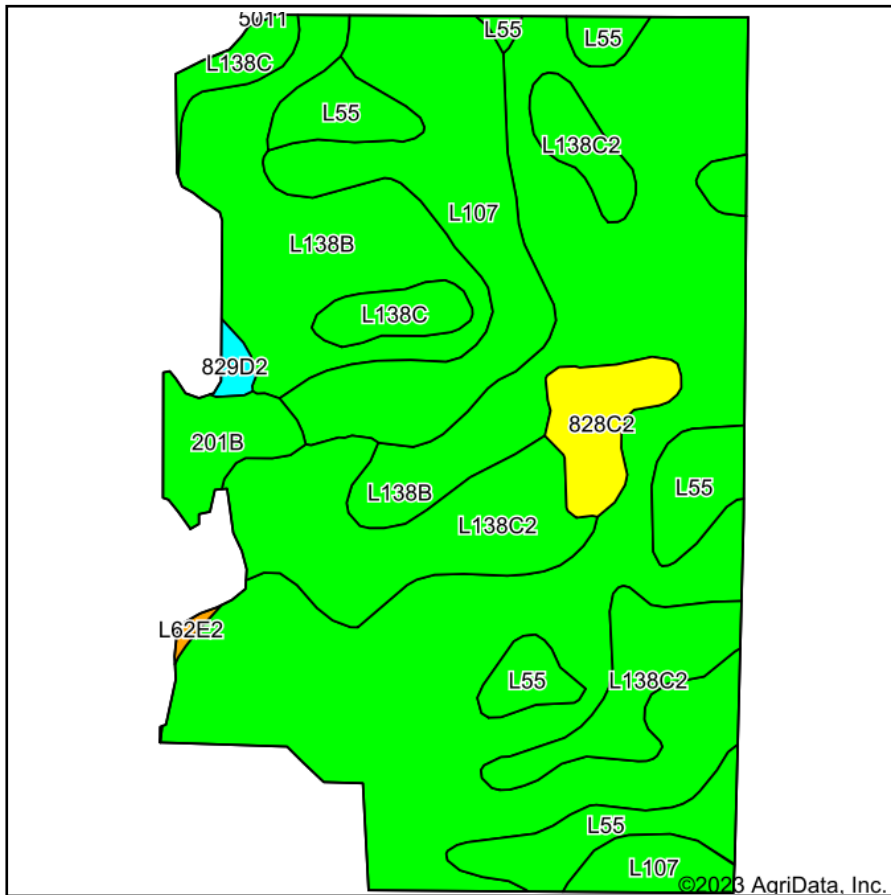

22 N Main, Albia IA Phone: 641-932-7796
 Email: hawkeye@uciowa.com
 On the web: www.uciowa.com
 www.iowawhitealfarms.com

Maps Provided By:



© AgriData, Inc. 2023 www.AgriDataInc.com



Soils data provided by USDA and NRCS.

Area Symbol: IA049, Soil Area Version: 29

Code	Soil Description	Acres	Percent of field	CSR2 Legend	Non-Irr Class *c	CSR2**	CSR	*n NCCPI Corn	*n NCCPI Soybeans	
L138B	Clarion loam, Bemis moraine, 2 to 6 percent slopes	50.46	54.4%		Ile	88		75	79	
L138C2	Clarion loam, Bemis moraine, 6 to 10 percent slopes, moderately eroded	13.03	14.0%		IIle	83		64	65	
L107	Webster clay loam, Bemis moraine, 0 to 2 percent slopes	12.56	13.5%		IIlw	88		77	83	
L55	Nicollet loam, 1 to 3 percent slopes	8.67	9.3%		Ie	91		77	84	
L138C	Clarion loam, Bemis moraine, 6 to 10 percent slopes	2.56	2.8%		IIIe	84		71	75	
828C2	Zenor sandy loam, 5 to 9 percent slopes, moderately eroded	2.54	2.7%		IIIe	45	31	48	37	
201B	Coland-Terril complex, 2 to 5 percent slopes	2.43	2.6%		IIlw	74	68	77	80	
829D2	Zenor-Storden complex, 9 to 14 percent slopes, moderately eroded	0.40	0.4%		IVe	29	28	52	42	
L62E2	Storden loam, Bemis moraine, 10 to 22 percent slopes, moderately eroded	0.15	0.2%		IVe	32		58	57	
Weighted Average						2.11	85.6	*	*n 73	*n 76.6

**IA has updated the CSR values for each county to CSR2.

*- CSR weighted average cannot be calculated on the current soils data, use prior data version for csr values.

*n: The aggregation method is "Weighted Average using all components"

*c: Using Capabilities Class Dominant Condition Aggregation Method

Soils data provided by USDA and NRCS.