

Soils Map

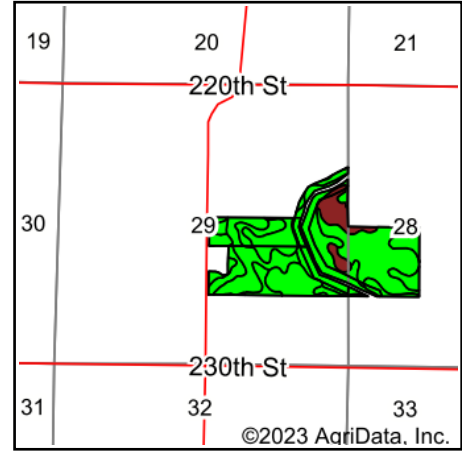
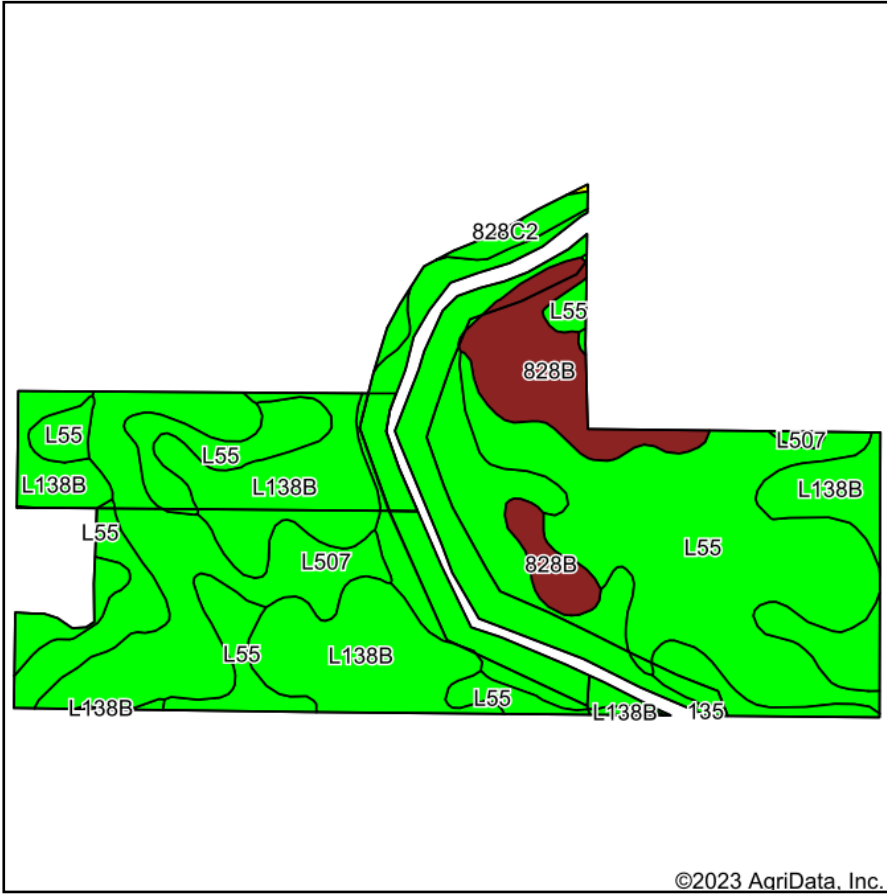

State: **Iowa**
 County: **Dallas**
 Location: **29-80N-29W**
 Township: **Lincoln**
 Acres: **133.75**
 Date: **5/31/2023**

Hawkeye Farm Mgmt & Real Estate

 22 N Main, Alta IA Phone: 641-932-7796
 Email: hawkeye@uciowa.com
 On the web: www.uciowa.com
www.iowawhitetailfarms.com







Maps Provided By:

 © AgriData, Inc. 2023 www.AgriDataInc.com



Soils data provided by USDA and NRCS.

Area Symbol: IA049, Soil Area Version: 29

Code	Soil Description	Acres	Percent of field	CSR2 Legend	Non-Irr Class *c	CSR2**	CSR	*n NCCPI Corn	*n NCCPI Soybeans	
L55	Nicollet loam, 1 to 3 percent slopes	45.57	34.1%		le	91		77	84	
L138B	Clarion loam, Bemis moraine, 2 to 6 percent slopes	35.01	26.2%		lle	88		75	79	
L107	Webster clay loam, Bemis moraine, 0 to 2 percent slopes	25.10	18.8%		llw	88		77	83	
L507	Canisteo clay loam, Bemis moraine, 0 to 2 percent slopes	17.32	12.9%		llw	87		70	81	
828B	Zenor sandy loam, 2 to 5 percent slopes	10.59	7.9%		llle	52	46	49	40	
828C2	Zenor sandy loam, 5 to 9 percent slopes, moderately eroded	0.09	0.1%		llle	45	31	48	37	
135	Coland clay loam, 0 to 2 percent slopes, occasionally flooded	0.07	0.1%		llw	76	80	70	83	
Weighted Average						1.74	86	*-	*n 73.3	*n 78.6

**IA has updated the CSR values for each county to CSR2.

*- CSR weighted average cannot be calculated on the current soils data, use prior data version for csr values.

*n: The aggregation method is "Weighted Average using all components"

*c: Using Capabilities Class Dominant Condition Aggregation Method

Soils data provided by USDA and NRCS.