

Soils Map

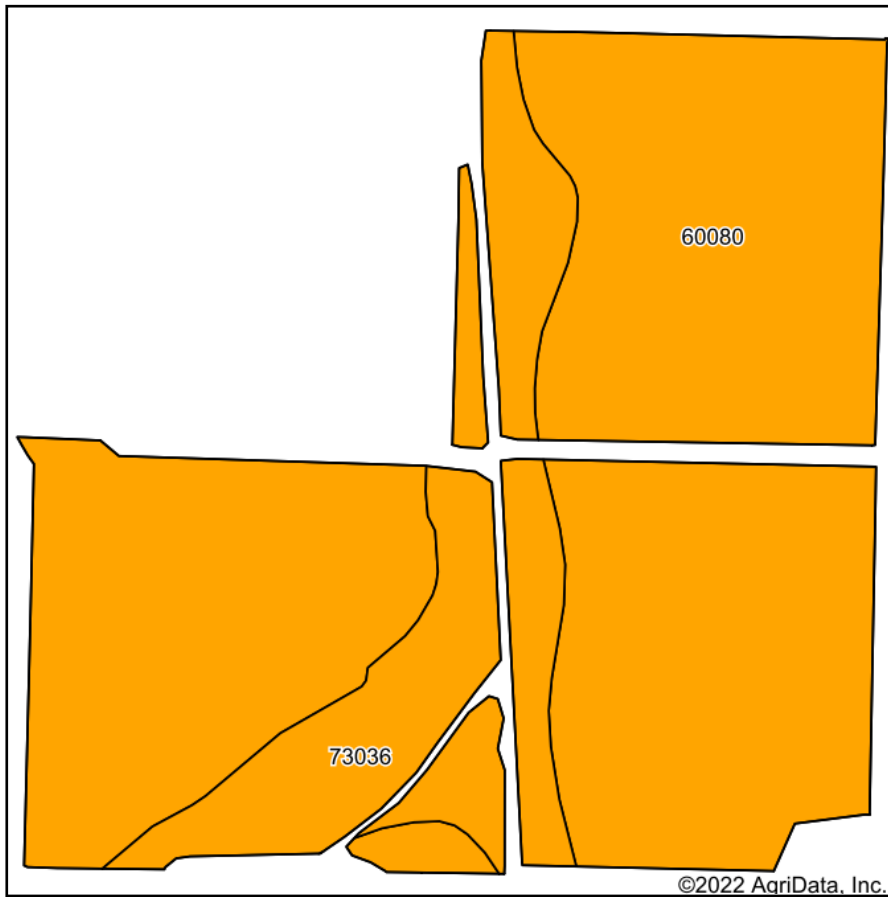

Soils data provided by USDA and NRCS.

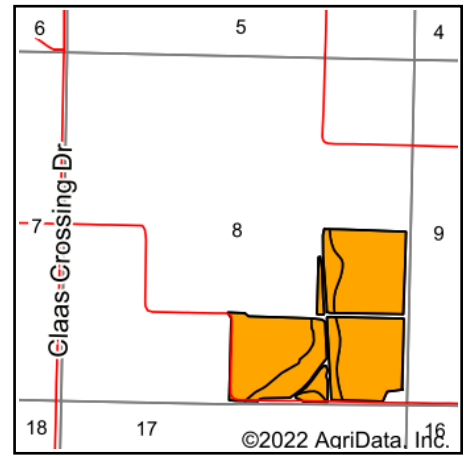

State: **Missouri**
 County: **Moniteau**
 Location: **8-45N-17W**
 Township: **Willow Fork**
 Acres: **118.5**
 Date: **8/31/2022**

United Country
 Property
 Solutions, LLC

Maps Provided By:

surety
 CUSTOMIZED ONLINE MAPPING
 © AgriData, Inc. 2021 www.AgriDataInc.com



Area Symbol: MO135, Soil Area Version: 23

Code	Soil Description	Acres	Percent of field	Non-Irr Class Legend	Non-Irr Class *c	Corn Bu	Grain sorghum Bu	Orchardgrass red clover hay Tons	Soybeans Bu	Tall fescue AUM	Winter wheat Bu	*n NCCPI Overall	*n NCCPI Corn	*n NCCPI Soybeans
60080	Crestmeade silt loam, 1 to 4 percent slopes, eroded	93.19	78.6%		IIIe							72	72	49
73036	Willowfork silt loam, 0 to 3 percent slopes	25.31	21.4%		IIIw	120	92	3.8	42	5.6	53	90	90	75
Weighted Average					3.00	25.6	19.6	0.8	9	1.2	11.3	*n 75.8	*n 75.8	*n 54.6

*n: The aggregation method is "Weighted Average using all components"

*c: Using Capabilities Class Dominant Condition Aggregation Method

Soils data provided by USDA and NRCS.