

Aerial Map



map center: 39.892381, -92.098907



TROPHY
PROPERTIES AND AUCTION
LAND (RECREATIONAL) RESIDENTIAL

Maps Provided By:



© AgriData, Inc. 2017

www.AgriDataInc.com

26-59N-11W
Shelby County
Missouri

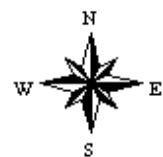

6/16/2017

Soils Map

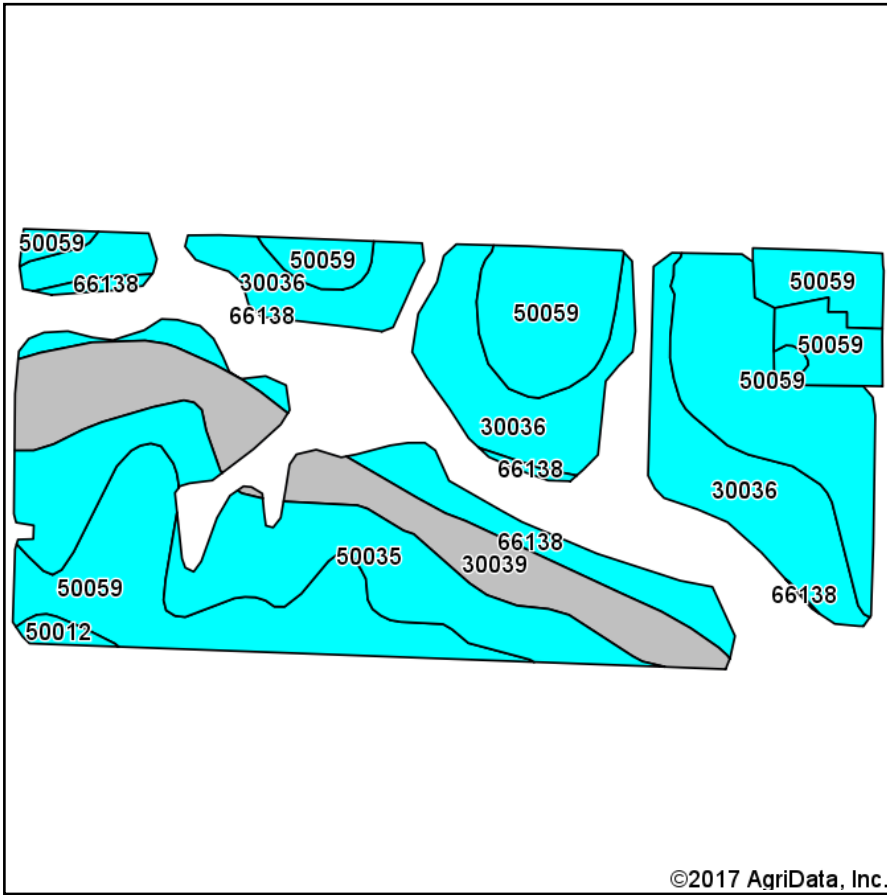

Soils data provided by USDA and NRCS.

©2017 AgriData, Inc.

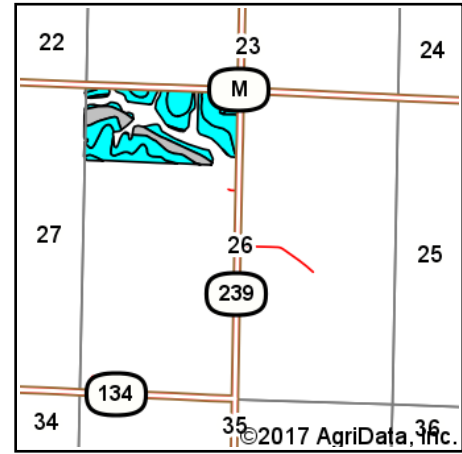

State: **Missouri**
 County: **Shelby**
 Location: **26-59N-11W**
 Township: **Bethel**
 Acres: **59.79**
 Date: **6/16/2017**



TROPHY
 PROPERTIES AND AUCTION
LAND | REAL ESTATE | RESIDENTIAL

Maps Provided By:



© AgriData, Inc. 2017

www.AgrIDataInc.com



Area Symbol: MO205, Soil Area Version: 16

Code	Soil Description	Acres	Percent of field	Non-Irr Class Legend	Non-Irr Class *c	Corn	Soybeans	Winter wheat	Grain sorghum
50059	Mexico silt loam, 1 to 4 percent slopes, eroded	22.94	38.4%		IIIe				
30036	Armstrong loam, 5 to 9 percent slopes	13.22	22.1%		IIIe				
50035	Leonard silt loam, 5 to 9 percent slopes, eroded	10.09	16.9%		IIIe				
30039	Armstrong loam, 9 to 14 percent slopes, eroded	8.96	15.0%		IVe	5	2	2	4
66138	Piopolis silty clay loam, 1 to 3 percent slopes, frequently flooded	4.17	7.0%		IIIw				
50012	Putnam silt loam, 0 to 1 percent slopes	0.41	0.7%		IIIw				
Weighted Average						0.7	0.3	0.3	0.6

*c: Using Capabilities Class Dominant Condition Aggregation Method

Soils data provided by USDA and NRCS.

Topography Map

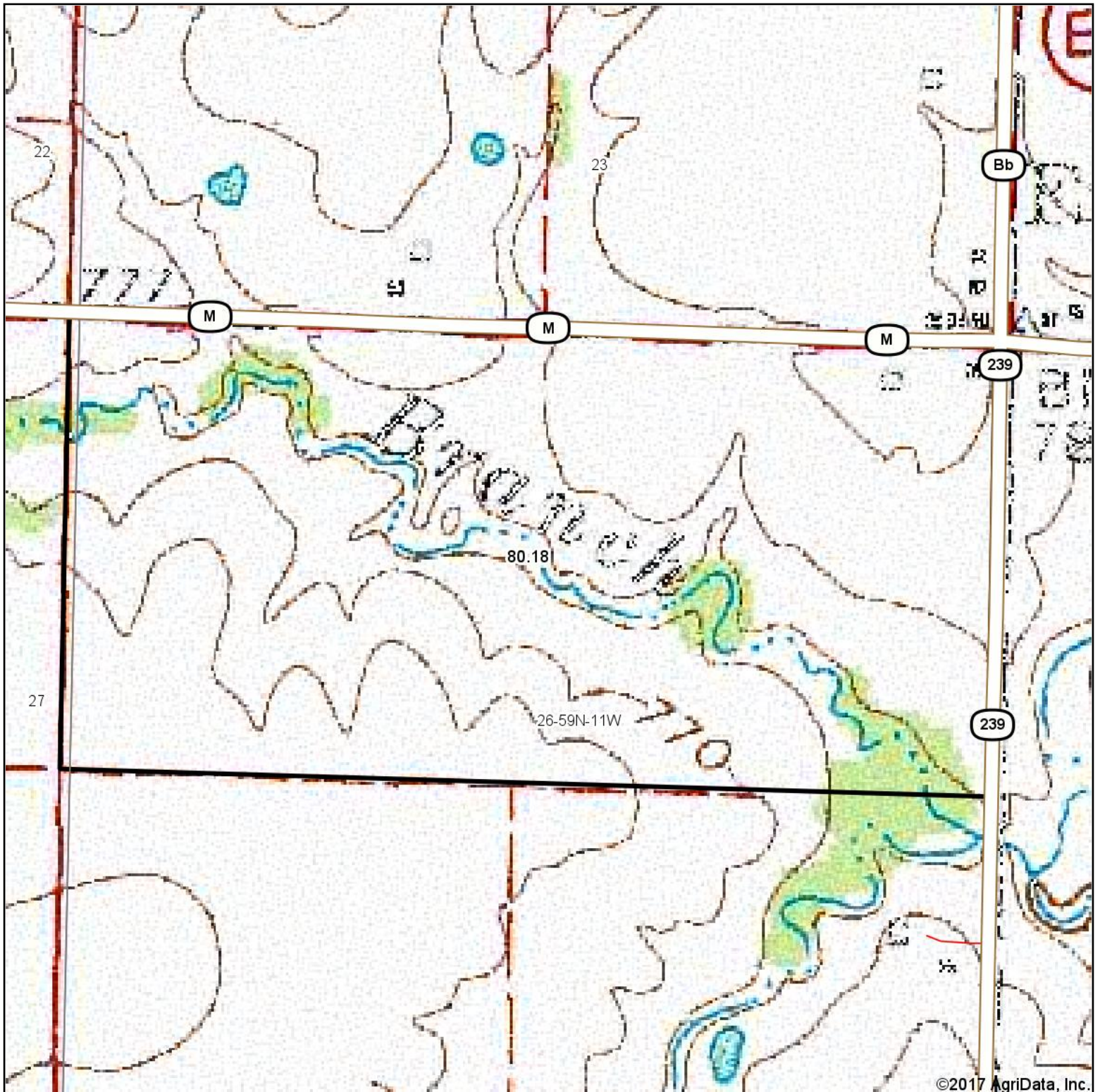

map center: 39.892381, -92.098907

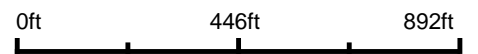

26-59N-11W
Shelby County
Missouri

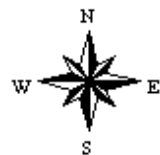

6/16/2017



Maps Provided By:



© AgriData, Inc. 2017

www.AgriDataInc.com