

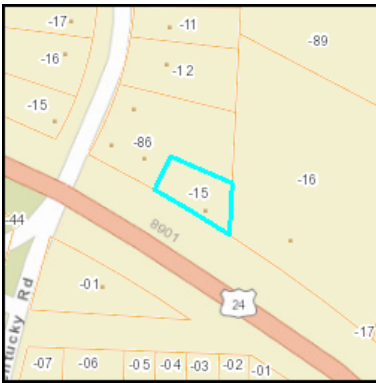

Property Information



14-830-07-15-00-0-00-000 05/29/2005



Parcel ID: 14-830-07-15-00-0-00-000

Address on this Parcel:

8912 E WINNER RD
INDEPENDENCE, MO 64053

Owner Information:

A & C MEIER PROPERTIES LLC
7111 W 151ST ST #135
OVERLAND PARK, KS 66223

Mortgage Holder Information:

No Mortgage Holder Information.

Property Characteristics:

Year Built: 1940
Living Area (Approx. sq. ft.): 630
Tax Neighborhood Code: 6477
Parcel Area (Approx.): 0.09 (acres), 4,069.39 (SqFt)

Property Class (PCA Code): Single Family Residential Improved (code: 1010)

Land Use Type: Single Family Residence (code: 1110)

Tax Code Area:

Code: 129
City: Independence
Fire: NA
Library: Kansas City
School: Independence
Water: NA

Assessment Information:

Tax Year: 2016
Market Value: \$30,512
Assessed Value: \$5,797
Taxable Value: \$5,797
[Where are my tax dollars going?](#)

Exemptions and Abatements Status (2014):

No exemptions or abatements.

Community Improvement District (CID):

Property is not in a CID for which Jackson County collects a tax or assessment.

TIF Information:

Property is not in a TIF Plan area or TIF Project area known to Jackson County.

Property Tax Account Summary

[Direct Link to Jackson County Assessment Profile](#)

Parcel Number	14-830-07-15-00-0-00-000		Property Address	8912 E WINNER RD , INDEPENDENCE, MO 64053		
General Information						
Property Description		ST CLAIR PARK E 100' OF LOT 15				
Property Category		Land and Improvements				
Status		Active, Locally Assessed				
Tax Code Area		129				
Property Characteristics						
Property Class		1010				
Parties						
Role	Percent	Name	Address			
Taxpayer	100	A & C MEIER PROPERTIES LLC	7111 W 151ST ST #135, OVERLAND PARK, KS 66223			
Owner	100	A & C MEIER PROPERTIES LLC	7111 W 151ST ST #135, OVERLAND PARK, KS 66223			
Property Values						
Value Type		Tax Year	Tax Year	Tax Year	Tax Year	Tax Year
		2016	2015	2014	2013	2012
Market Value Total		30,512	30,512	29,623	29,623	29,623
Taxable Value Total		5,797	5,797	5,628	5,628	5,628
Assessed Value Total		5,797	5,797	5,628	5,628	5,628

No Charges are currently due.

No Charge Amounts are currently due for this property. If you believe this is incorrect, please contact the Taxpayer Services Unit at (816) 881-3232.

NOTICE: Telephones are staffed during regular business hours (8am to 5pm, Monday through Friday, excluding holidays observed by Jackson County).

Distribution of Current Taxes					
District		Amount			
BOARD OF DISABLED SERVICES		4.280000			
CITY - INDEPENDENCE		41.540000			
INDEPENDENCE SCHOOL #30		342.780000			
JACKSON COUNTY		28.730000			
KANSAS CITY LIBRARY		28.600000			
MENTAL HEALTH		6.940000			
METRO JUNIOR COLLEGE		13.580000			
STATE BLIND PENSION		1.730000			
Receipts					
Date	Receipt No.	Amount Applied	Amount Due	Tendered	Change
07/19/2016 20:45	9706125	1,177.20	1,177.20	1,177.20	0.00
03/25/2016 10:20	9654328	1,867.67	1,867.67	1,867.67	0.00
03/24/2016 13:42	9653768	677.75	677.75	677.75	0.00
08/13/2014 10:40	8595272	700.00	2,895.49	700.00	0.00
08/20/2012 09:26	7489916	1,692.23	1,692.23	1,700.00	7.77
08/22/2011 10:08	6932504	900.00	2,913.14	900.00	0.00

REMINDER: Occasionally, the parcel number for a real estate parcel changes, due to a parcel segregation or merge. In such a case, a search of the new parcel number may not reflect tax delinquency or a full tax history concerning that parcel. You may wish to contact us to obtain that information. Or, you may wish to search all relevant parcel numbers of parcels involved in such a segregation or merge. [Click here](#) to begin a search on this website to see if a parcel was involved in a segregation or merge occurring within the past five years and to see a list of parent parcel(s) and child parcel(s) involved.
NOTE: Information concerning a segregation or merge occurring more than five years prior to the search is not available on this website.

ATTENTION: This website will close at 11:00 p.m. on December 31.
Taxes paid online after the website reopens in the New Year will accrue interest, penalties and fees.

Content in Property Account Summary Developed by Manatron, Inc.
@2005-2010 All rights reserved.
Version 1.0.5228.20119

Disclaimer: The information contained in this website is provided to the recipient pursuant to Section 610.011, RSMo. Jackson County makes no warranties or representations of any kind, express or implied, regarding the information, data, or images provided herein. All information, data, and service are provided "as is," and "with all faults" and by accessing this website, the recipient accepts the risk of any errors or omissions. Jackson County is not liable in any way to the users of information, data or service provided herein. By accessing and using this information, data or service you agree to hold the County harmless in all matters and accounts arising from the use or reliance on the completeness or accuracy of this information, data or service.

An error occurred retrieving the segregation & merge information. Please try again later.

Disclaimer: The information contained in this website is provided to the recipient pursuant to Section 610.011, RSMo. Jackson County makes no warranties or representations of any kind, express or implied, regarding the information, data, or images provided herein. All information, data, and service are provided "as is," and "with all faults" and by accessing this website, the recipient accepts the risk of any errors or omissions. Jackson County is not liable in any way to the users of information, data or service provided herein. By accessing and using this information, data or service you agree to hold the County harmless in all matters and accounts arising from the use or reliance on the completeness or accuracy of this information, data or service.

Elected Officials

Jackson County	State of Missouri	United States
<p>County Executive: Name: Frank White Jr. (D) Email: fwhite@jacksongov.org View Website</p> <p>Individual Legislator: Name: Dennis Waits (D) District: 3 Email: dwaits@jacksongov.org View Website</p> <p>At-Large Legislator: Name: Garry J. Baker (D) District: 1 Email: gibaker@jacksongov.org View Website</p>	<p>Representative: John Rizzo (D) District: 19 View Website</p> <p>Senator: Paul LeVota (D) District: 11 View Website</p>	<p>Representative: Emanuel Cleaver II (D) District: 5 View Website</p> <p>Senator: Roy Blunt (R) View Website</p> <p>Senator: Claire McCaskill (D) View Website</p>

